



Albany Mansions Marina

, Bexhill-On-Sea, TN40 1BU

Asking Price £240,000



Albany Mansions Marina

, Bexhill-On-Sea, TN40 1BU

Asking Price £240,000



Entrance door & Lobby

7'2" x 4'8" (2.18 x 1.43)

Private Entrance Door giving access into the entrance Lobby, leading to Hall

Hallway

7'5" x 15'6" (2.26 x 4.72)

Spacious L shaped hallway with radiator, the measurements represent the bottom part of the L

Living/dining Room

22'7" x 12'9" (6.89 x 3.89)

Front aspect windows having internal wooden shutters, radiators, double doors leading to Kitchen

Kitchen/breakfast room

18'1" x 9'5" (5.52 x 2.86)

benefitting from modern fitted units, with inset gas hob with extractor hood above, built in oven, appliances space for washing machine & dishwasher, breakfast bar.

Bedroom 1

11'7" x 10'9" (3.54 x 3.28)

Side aspect window

Bedroom 2

11'7" x 8'2" (3.54 x 2.48)

Side aspect window

Bathroom

7'2" x 7'1" (2.19 x 2.16)

Modern fitted suite with P shaped bath having shower above, wc and wash hand basin, towel rail radiator and side aspect window.

Front garden

Open plan front garden

Side garden

21'4" approx x 11'0" approx (6.49 approx x 3.36 approx)

Enclosed private side garden, with wooden fencing and gate.



Road Map

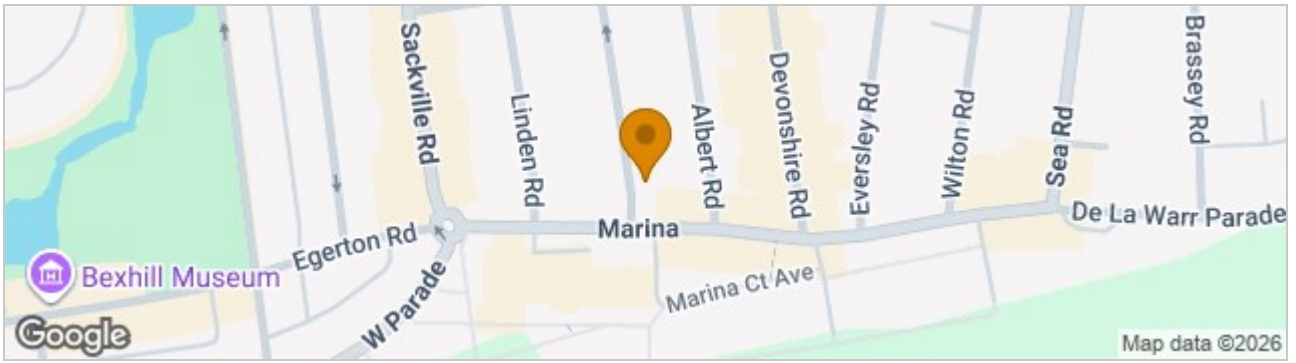

Floor Plan

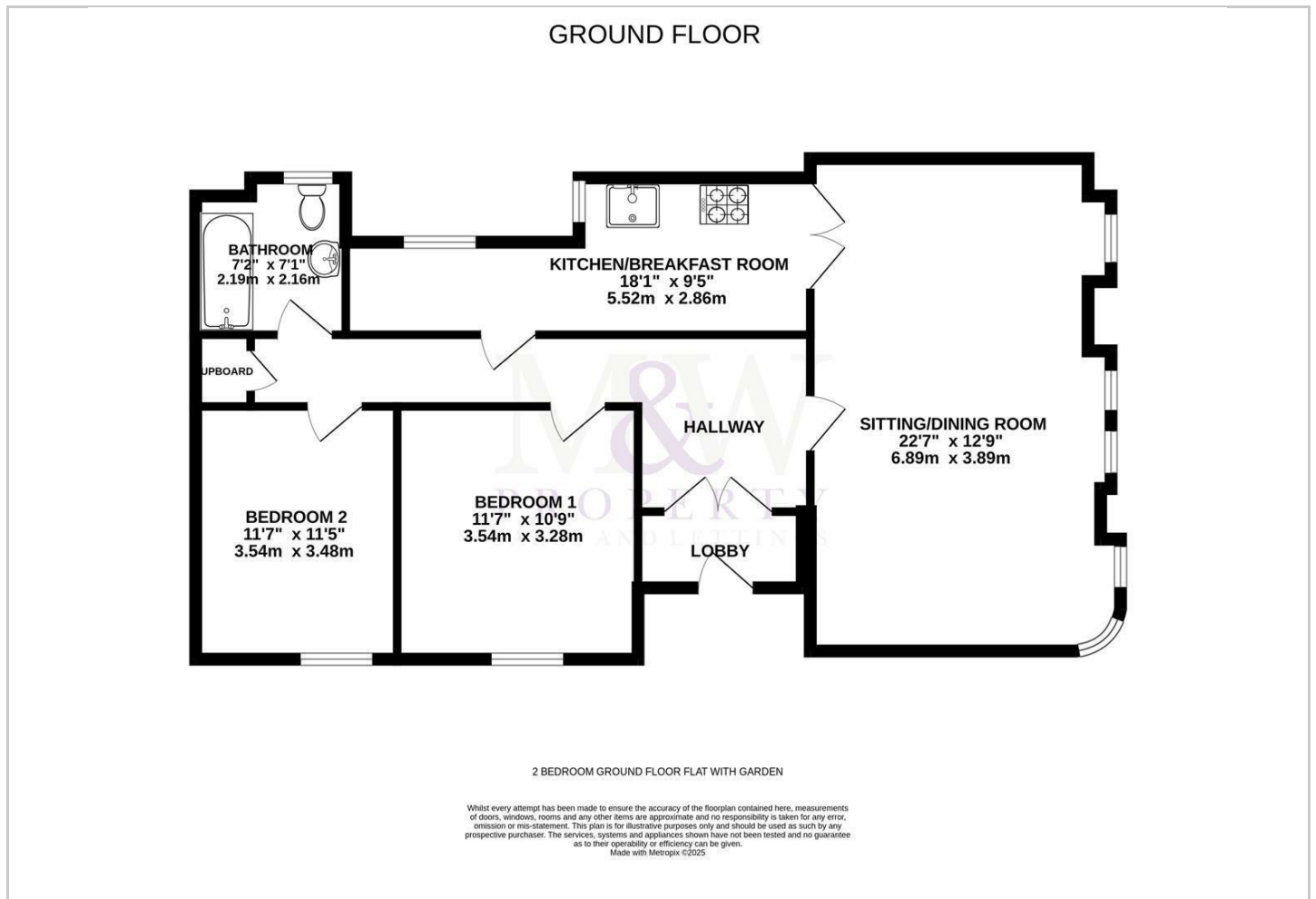

Viewing Arrangements

Please contact our St Leonards on Sea Office on 01424 420073 if you wish to arrange a viewing appointment for this property or require further information.

Energy Efficiency Graph

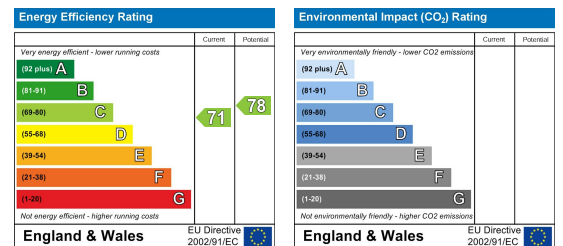

These particulars, whilst believed to be accurate are set out as a general outline only for guidance and do not constitute any part of an offer or contract. Intending purchasers should not rely on them as statements of representation of fact, but must satisfy themselves by inspection or otherwise as to their accuracy. No person in this firm's employment has the authority to make or give any representation or warranty in respect of the property.