



move



**move**  
Property Sales & Lettings

Eldorado Road, Cheltenham



## Eldorado Road, Cheltenham

Well presented 2-bed, 2-bath second-floor apartment with parking near Montpellier. Open-plan living, en suite, loft storage, and communal gardens. No onward chain and freshly redecorated.

Council Tax band: C

Tenure: Leasehold

EPC Energy Efficiency Rating: C

EPC Environmental Impact Rating:

- Spacious Two Bedroom Apartment
- NO ONWARD CHAIN
- Open Plan Kitchen/Living Room
- Close to Cheltenham Train Station
- Master Bedroom Offering Ensuite Shower Room
- Allocated Off Road Parking
- Quiet and Sought After Location
- Communal Gardens



Approximate Gross Internal Area  
79 sq mt/853 sq ft

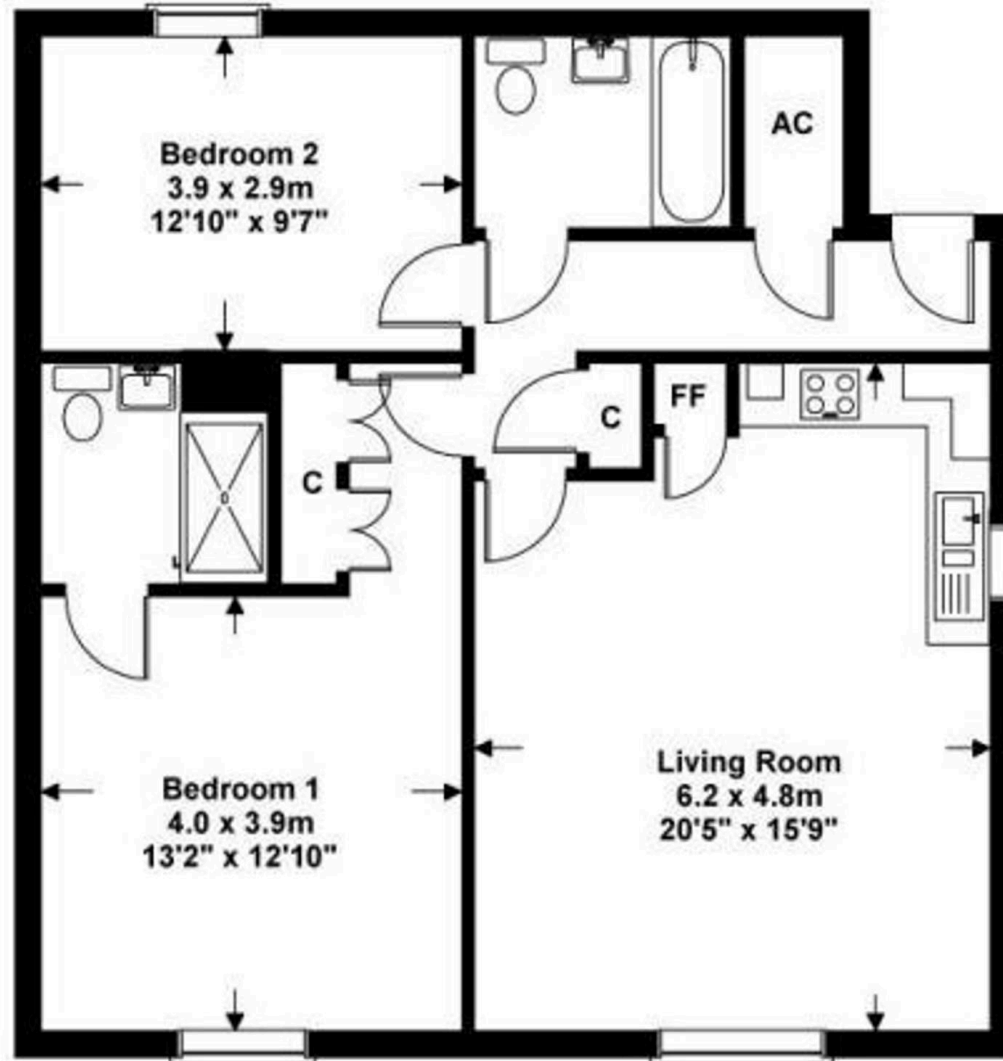

**SKETCH PLAN FOR ILLUSTRATIVE PURPOSES ONLY**

All measurements walls, doors, windows, fittings and appliances, their sizes and locations, are shown conventionally and are approximate only. They cannot be regarded as being a representation by the seller, his agent, the illustrator or Connor and Company





## Move Estate Agents Cheltenham

1 The Clarence Clarence Parade, Cheltenham - GL50 3NY

01242 257333

cheltenham@move.uk.net

move.uk.net/

**move**  
Property Sales & Lettings