



BRIXTON ROAD, SW9

£2,400 per month

Two bedrooms
Great location
Bright
High ceilings
Period charm
Energy rating: c

@marshandparsons
marshandparsons.co.uk

MARSH &
PARSONS



ABOUT THE PROPERTY

This spacious two bedroom flat in the heart of Brixton offers an abundance of natural light and an airy, open feel throughout. Boasting impressively high ceilings, the property combines period charm with a bright, contemporary atmosphere.

Situated in a vibrant and well-connected area, the flat benefits from close proximity to local amenities, transport links, and the diverse shops, cafés, and restaurants that make Brixton such a sought-after location.



STEP INSIDE BRIXTON ROAD

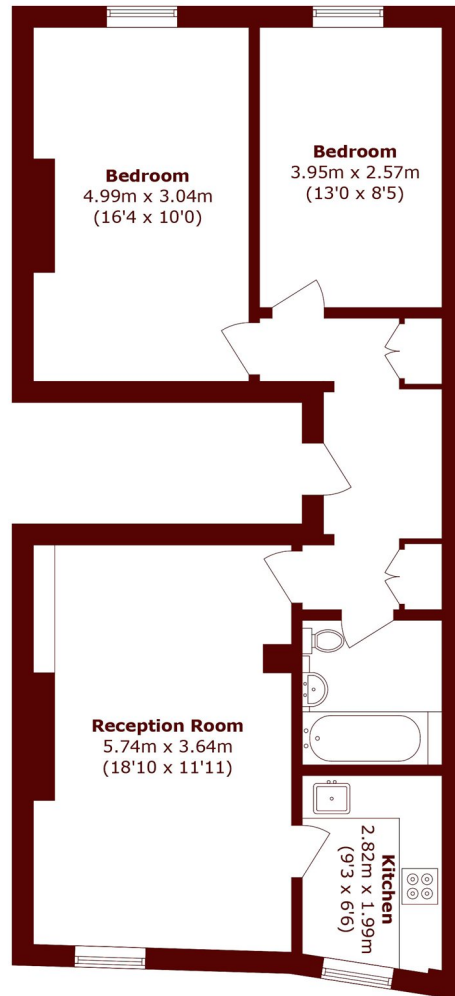

Total area (approx.): 65.8 sq. m (708.2 sq. ft)

Brixton
020 7871 5040

Energy Rating: C We aim to make our particulars both accurate and reliable. However, they are not guaranteed; nor do they form part of an offer or contract. If you require clarification on any points then please contact us, especially if you're traveling some distance to view. Please note that appliances and heating systems have not been tested and therefore no warranties can be given as to their good working order

**MARSH &
PARSONS**