



Highridge Close
Maidstone | Kent





Highridge Close

ME14 5XQ

Price £200,000 (Share of Freehold)

For Sale

2 bedroom ground floor maisonette in the sought after area of Grove Green with 2 allocated parking spaces & garden

- Ground floor maisonette
- 2 bedrooms, 1 double & 1 single
- Popular area of Grove Green
- 2 allocated parking spaces
- Conservatory & low maintenance garden
- 1.0 miles to Bearsted train station, 1.5 miles to Maidstone East
- 0.4 miles to St Johns CofE Primary School



The Property

This modern two bedroom ground floor maisonette is in the popular area of Grove Green. The porch opens directly into the living room which has a small storage cupboard, sliding doors through to the kitchen and door through to the hallway. The contemporary kitchen has fitted units, integrated electric hob, oven and fridge. There is a large storage cupboard off the hallway which houses the washing machine and bathroom with white suite and shower over bath. The double bedroom has storage cupboard and door opening into the garden, the single bedroom has storage cupboard and door through to the conservatory which also has access to the garden. The property has electric storage heating and double glazing throughout. The low maintenance garden is fully paved and there is allocated parking for two cars. Junction 7 of the M20 is a short drive with excellent access to the A249. There is a regular bus service between Maidstone town centre and Weaving. Bearsted mainline station is a short drive from Weaving with trains between Ashford International and London Victoria.

Location

Highridge Close is located in the popular Weaving area which has many amenities including a Tesco supermarket, dry cleaners, post office, medical centre, pharmacy and two community halls. The Ofsted Outstanding St John's infant and junior school, Invicta Grammar school and Valley Park secondary school are a short walk away. Vinters Valley Nature Reserve and Mote Park with its boating lake, leisure centre and municipal swimming pool are nearby. The village of Bearsted is just a mile away with regular train services to London. Maidstone Town Centre is just under 2 miles away and includes a multiplex cinema, bowling alley, restaurants and nightclubs as well as the town's market.

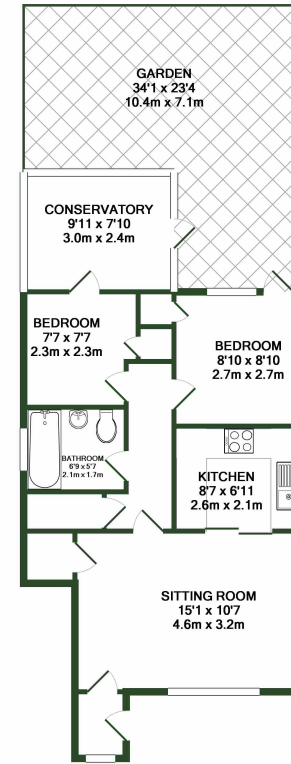

TOTAL APPROX. FLOOR AREA 557 SQ.FT. (51.7 SQ.M.)

Whilst every attempt has been made to ensure the accuracy of the floor plan contained here, measurements of doors, windows, rooms and any other items are approximate and no responsibility is taken for any error, omission, or mis-statement. This plan is for illustrative purposes only and should be used as such by any prospective purchaser. The services, systems and appliances shown have not been tested and no guarantee as to their operability or efficiency can be given.
Made with Metropix 62016



PROPERTY INFORMATION

Council Tax

To check the Council Tax for this property, please refer to www.gov.uk/council-tax-bands.

Local Authority

Maidstone Borough Council 01622 602000. Kent County Council - 0845 247 247

Services

Mains water, drainage and electricity.

Tenure

Share of the Freehold

DIRECTIONS

Travelling east out of Maidstone on the A20, turn left into New Cut Road. Take the first right into Grovewood Road South and then take the third left onto Weaving Street. Follow the road up to the roundabout and turn left onto Grovewood Drive North and take the first right onto Highridge Close.

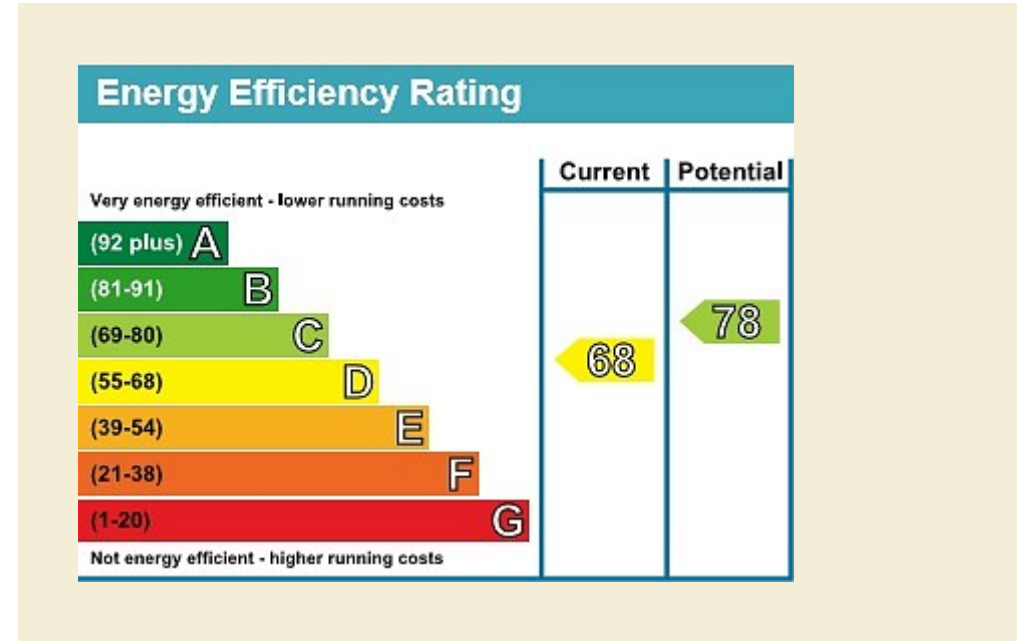

Viewing strictly by appointment through Sandersons UK

Maidstone branch
01622 686 686

maidstone@sandersonsuk.com
78 Bank Street
Maidstone
Kent
ME14 1SJ



www.sandersonsuk.com
twitter.com/sandersonsuk
facebook.com/sandersonsuk

IMPORTANT NOTICE Sandersons UK for themselves and for the Vendors of this property, whose agents they are, give notice that:

1. The particulars are intended to give a fair and substantially correct overall description for the guidance of intending purchasers and do not constitute part of an offer or contract. Prospective purchasers and lessees ought to seek their own professional advice.
2. All descriptions, dimensions, areas, reference to condition and necessary permissions for use and occupation and other details are given in good faith, and are believed to be correct, but any intending purchasers should not rely on them as statements or representations of fact, but must satisfy themselves by inspection or otherwise as to the correctness of each of them.
3. No person in the employment of Sandersons UK has any authority to make or give any representations or warranty whatever in relation to this property on behalf of Sandersons UK, nor enter into any contract on behalf of the Vendor.
4. No responsibility can be accepted for any expenses incurred by intending purchasers in inspecting properties which have been sold, let or withdrawn. All measurements are approximate.