



FLEXIAGENT



Oxford Road Southport, PR8 2EG **£1,700 Per Month**

Flexi-Agent are proud to promote this three bedroom apartment, situated in a traditional detached Victorian converted development. The property consists of three apartments, all spanning generous proportions. The property is situated in Birkdale Village next to a plethora of amenities, including bars, boutiques, shops and Birkdale Village Train Station.

The property briefly comprises; Three bedrooms two of which are DOUBLE, an airy welcoming entrance hall, spacious living room with a bay window, modern fitted kitchen with integrated appliances, bright three-piece bathroom and a large front reception area.

Externally, ample resident's driveway parking is available to the front of the property and a generously sized communal rear garden.

Viewing is available immediately by appointment.

Viewing

Please contact our Flexi-Agent Southport Lettings Office on 01704 889455 if you wish to arrange a viewing appointment for this property or require further information.

- Three bedrooms
- Traditional detached Victorian converted development.
- Spacious living room with a bay window
- Modern fitted kitchen with integrated appliance
- Bright three-piece bathroom
- Large front reception area
- Ample resident's driveway parking
- Situated in the lively Birkdale village
- Viewings available upon request.



3



1



2



C

Floor Plan

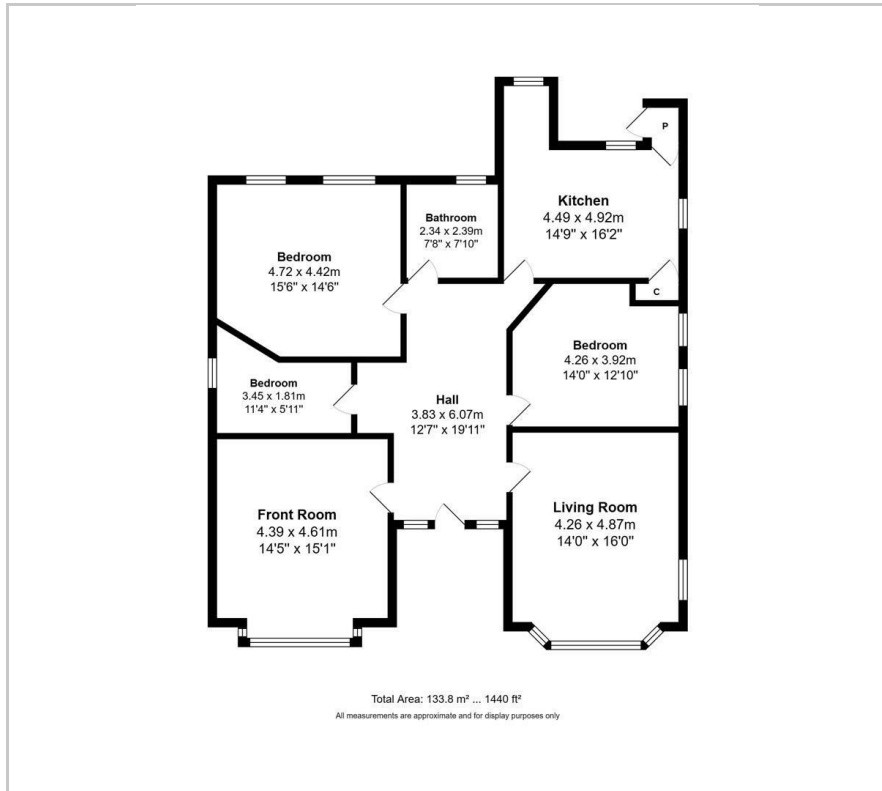

Area Map

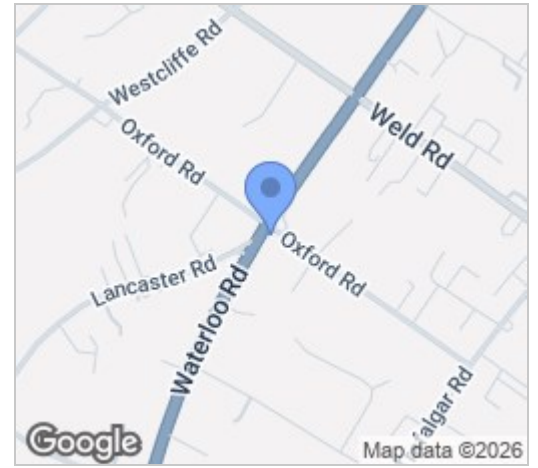

Energy Efficiency Graph

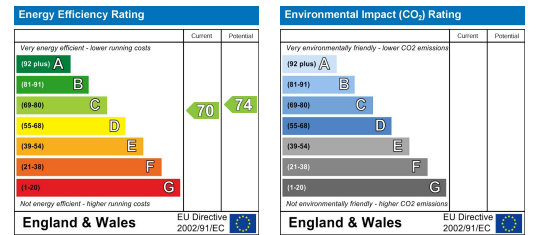

These particulars, whilst believed to be accurate are set out as a general outline only for guidance and do not constitute any part of an offer or contract. Intending purchasers should not rely on them as statements of representation of fact, but must satisfy themselves by inspection or otherwise as to their accuracy. No person in this firm's employment has the authority to make or give any representation or warranty in respect of the property.