

Lonsdale Road, Etwall

aksresidential.com

Offers in excess of
£450,000



AKS
THE ESTATE AGENCY

This property at a glance:



Watch the video



Lonsdale Road, Etwell



Jodie says:

“Tucked away on a private driveway, this four-bedroom detached home immediately gives you a real sense of peace and privacy from the moment you arrive. It’s one of those homes that feels calm and tucked away from the world, while still offering all the space and practicality a modern family could need.

For me, though, the absolute standout space is the open-plan kitchen, dining and family area. I honestly think this room is what makes the home so special. It’s such a sociable, versatile space and I can completely imagine it being the heart of everyday family life, whether that’s busy weekday mornings, relaxed evenings together or entertaining friends at the weekend. The kitchen itself is sleek and modern, and I really like how the integrated appliances give it such a clean, high-end finish. There’s plenty of room for a large dining table, and the additional seating area at the front adds another layer to the space that I think works brilliantly. What I particularly love is how connected this room feels to the rest of the house and garden. You can move seamlessly through to the hallway, the living room, out onto the driveway or straight into the garden through the patio doors, which makes the whole downstairs feel incredibly functional and easy to live in.

The living room, for me, feels like the perfect place to retreat to at the end of the day. It’s cosy and comfortable while still feeling spacious, and I think it works really well as a quieter continuation of the main living space. I also really like the positioning of the home office at the front of the property. It feels nicely separate, which is ideal for working from home, but still connected enough that family life can continue around you without feeling shut away.

Upstairs, I was really impressed by the proportions of all four bedrooms because they are genuine doubles, which can be hard to find. The main bedroom feels especially bright and spacious, and I love the addition of the mirrored wardrobes and modern en-suite which give it a real sense of luxury. The remaining bedrooms are all generously sized too, making the house work brilliantly for larger families, guests or even additional workspace if needed. The family bathroom is another space I think has been really well designed, modern, spacious and practical, with a four-piece suite that makes busy mornings feel much easier.

Outside, the garden complements the house perfectly. It’s clearly been thoughtfully landscaped and feels like an extension of the living space. I particularly like the large patio area straight off the kitchen and living room because it makes indoor-outdoor living feel effortless in the warmer months. There’s still plenty of lawn space, beautiful planted borders and a lovely wooden seating area, but the feature that really made me smile was the homemade bar area, it’s such a fun addition and I can imagine it being a fantastic space for hosting family and friends.

To finish it all off, the home benefits from a tandem driveway, single garage and EV charger, which just adds even more practicality. For me, this is one of those homes that really does tick all the boxes, peaceful and private, modern and spacious, but most importantly, a home that simply works incredibly well for everyday life.”

AKS
THE ESTATE AGENCY
aksresidential.com



Lonsdale Road, Etwall



Did you spot...

This beautiful family home is situated on a private driveway



A message from the seller:

"We truly wish we could pick this house up, along with the wonderful village of Etwall, and take it with us. If it weren't for relocating to Nottingham for work and to be closer to family and friends, we would never dream of leaving. Etwall offers the perfect balance of vibrant village life and peaceful countryside charm. From its welcoming pubs and fantastic takeaways to the exceptional primary school, it has been an idyllic place to call home. Our home has given us everything we could have hoped for. Space to entertain, cosy corners to unwind, and a beautiful sense of calm throughout. The garden, in particular, has been one of our favourite parts of the property, a peaceful space where you can genuinely switch off and enjoy the quiet surroundings, often with little more than birdsong in the background.

The house has suited every stage of our lifestyle, from relaxed evenings at home to hosting friends and family, and combined with everything Etwall has to offer, it has been a fantastic place to live. We hope the next owners enjoy it as much as we have".

AKS
THE ESTATE AGENCY

Floor Plan

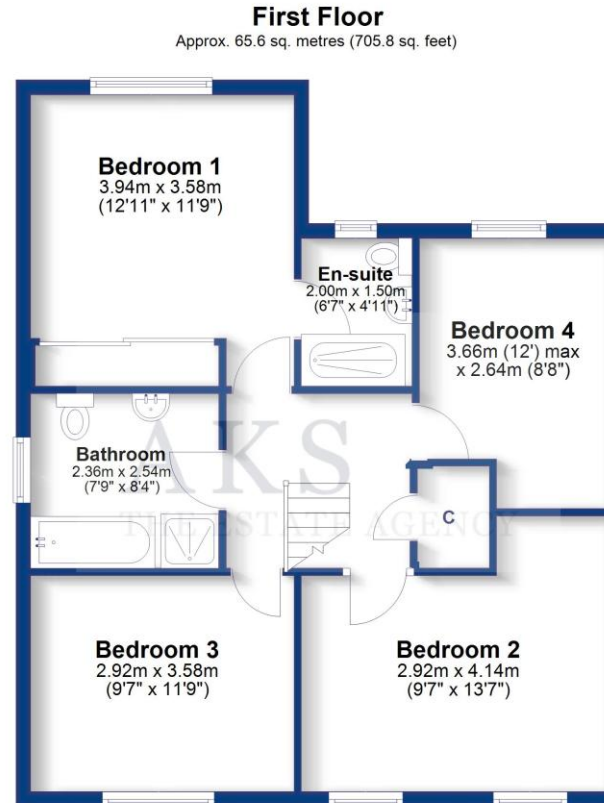

Total area: approx. 133.2 sq. metres (1433.8 sq. feet)

Energy Performance Certificate

Score	Energy rating	Current	Potential
92+	A		92 A
81-91	B	85 B	
69-80	C		
55-68	D		
39-54	E		
21-38	F		
1-20	G		

Lonsdale Road, Etwall

Presented by

AKS
THE ESTATE AGENCY



★★★★★
300+ 5 star Google Reviews



Key Features:

- FOUR BEDROOM DETACHED HOUSE
- LIVING ROOM, HOME OFFICE, UTILITY SPACE AND WC
- OPEN PLAN KITCHEN-DINING-FAMILY SPACE
- SPACIOUS MAIN BEDROOM AND EN-SUITE
- MODERN FOUR PIECE BATHROOM
- LANDSCAPED GARDEN
- TUCKED AWAY OFF A PRIVATE DRIVEWAY
- EPC RATING B



About the area:

The traditional village of Etwall is fantastic family village and has something for everyone. Also, within the village there is a park and football pitches, a cricket club, Post Office, News Agents and several pubs as well as a restaurant. The buses which run through the village provide a service which goes to other local villages as well as into Derby City Centre and Burton Town Centre. It has easy access to major road links with the A38 and A50 both just a couple of minutes' drive from the village and the A516 to Derby.



Schools:

There is Etwall Primary School and John Port Academy within the village making it an ideal location for families.



Don't miss out on the chance to own this incredible property!

To book a viewing with **Jodie** call
01332 30 30 30

[Click here](#) to watch the property video

