



## 50 WESTON HOUSE GREGORY GARDENS NORTHAMPTON, NN3 2BF

**£140,000**  
**LEASEHOLD**

Stonhills are pleased to offer this well presented two double bedroom ground floor flat situated in this popular area of, Northampton. The accommodation comprises open plan kitchen/living room, bedroom one with ensuite, a further double bedroom and bathroom. The property also benefits from allocated parking, 84 years remaining on the lease, service charge of £1,055 per annum and is offered with no chain. Located close to local amenities and good transport links.

 **stonhills**  
LAND & ESTATE AGENTS

## GROUND FLOOR

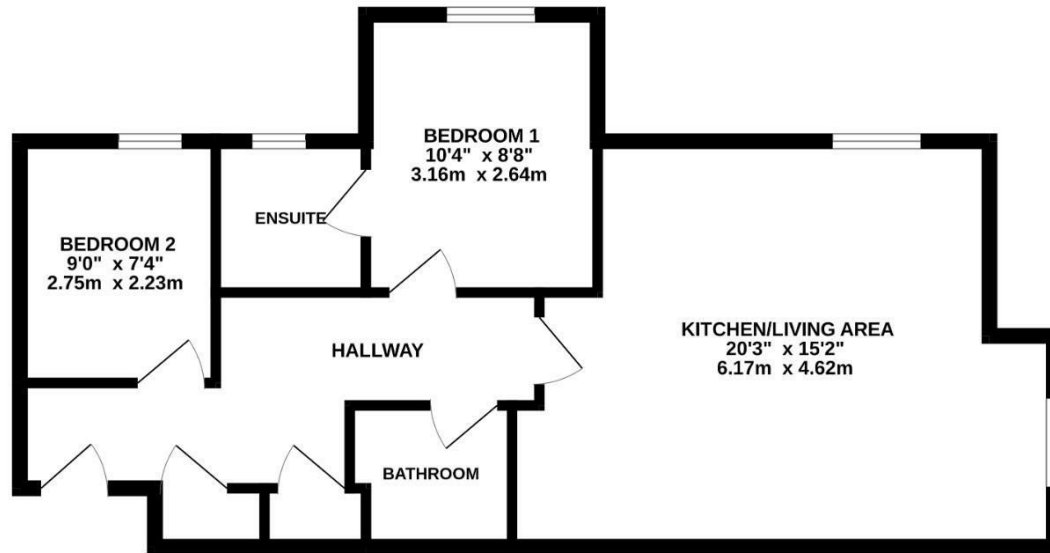

Whilst every attempt has been made to ensure the accuracy of the floorplan contained here, measurements of doors, windows, rooms and any other items are approximate and no responsibility is taken for any error, omission or mis-statement. This plan is for illustrative purposes only and should be used as such by any prospective purchaser. The services, systems and appliances shown have not been tested and no guarantee as to their operability or efficiency can be given.  
Made with Metropix ©2026

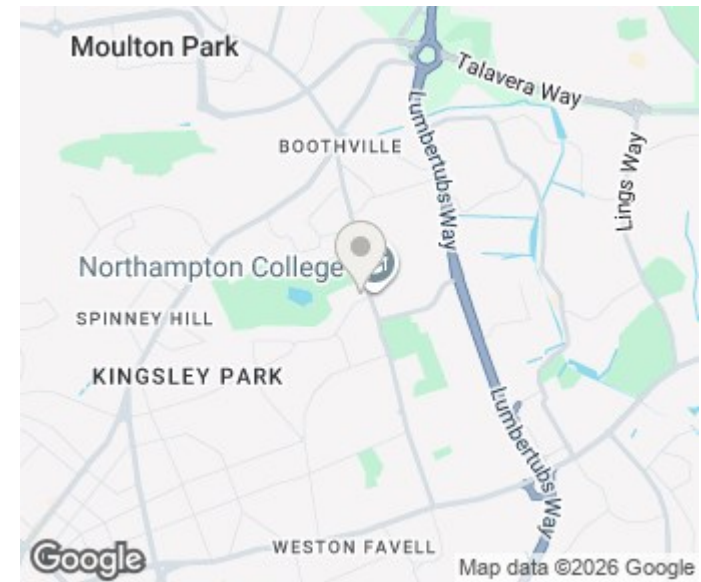

Energy Efficiency Rating		
	Current	Potential
Very energy efficient - lower running costs		
(92 plus) <b>A</b>		
(81-91) <b>B</b>		
(69-80) <b>C</b>		
(55-68) <b>D</b>		
(39-54) <b>E</b>		
(21-38) <b>F</b>		
(1-20) <b>G</b>		
Not energy efficient - higher running costs		
<b>England &amp; Wales</b>	EU Directive 2002/91/EC	

Agents Note: Whilst every care has been taken to prepare these particulars, they are for guidance purposes only. All measurements are approximate and are for general guidance purposes only and whilst every care has been taken to ensure their accuracy, they should not be relied upon and potential buyers/tenants are advised to recheck the measurements

Northampton Office Sales  
39 St Giles Street  
Northampton  
Northamptonshire  
NN1 1JF

01604 624424  
lewis@stonhills.co.uk  
<https://www.stonhills.co.uk/>

