



35 Velder Avenue

, Southsea, PO4 8RT

£190,000

PUBLIC NOTICE – The vendor has been in receipt of an offer of £180,000 subject to contract for the above property. Anyone wishing to place a higher offer must do so before legal exchange of contracts

Three bedroom Bay fronted home / Vacant with no chain ahead / In need of full refurbishment / Excellent first purchase or investment / Perfect for all developers, investors and builders / Gas central heating and mostly double glazed / South facing rear garden / First floor bathroom / Downstairs WC

Close to Milton Common with good access to the M27

- Three bedroom Bay fronted home
- Vacant with no chain ahead
- In need of full refurbishment
- Excellent first purchase or investment
- Perfect for all developers & Builders
- Gas central heating and mostly double glazed
- South facing rear garden
- First floor bathroom
- Downstairs WC
- Close to Milton Common with good access to the M27

Viewing

Please contact our ROK Marsh Office on 02393233267 if you wish to arrange a viewing appointment for this property or require further information.



3



1



2



D

Floor Plan

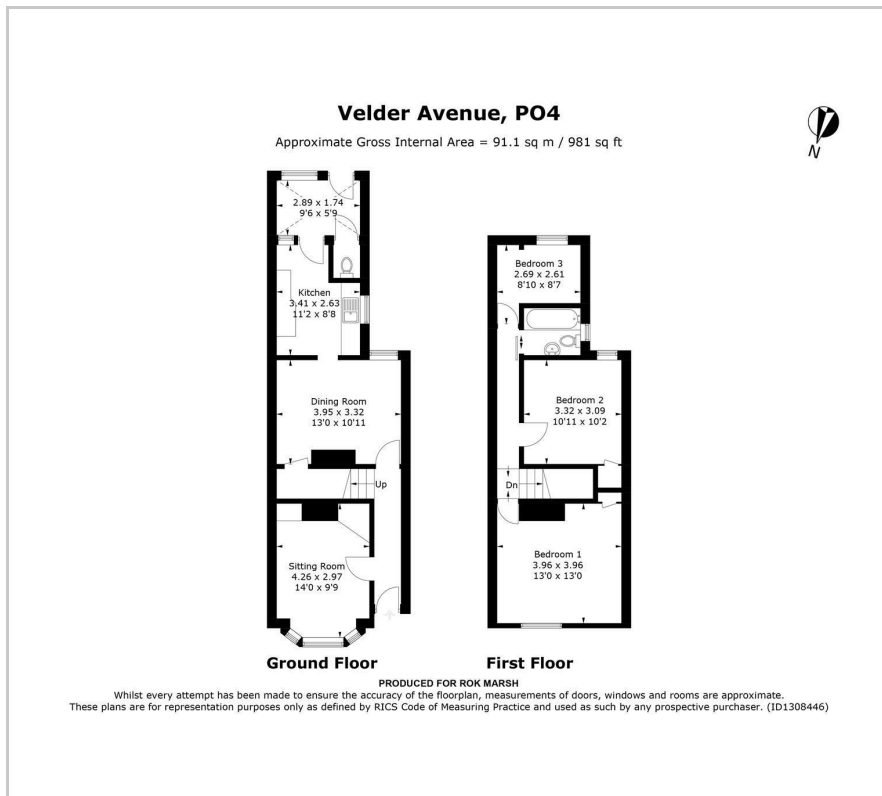

Area Map



Energy Efficiency Graph

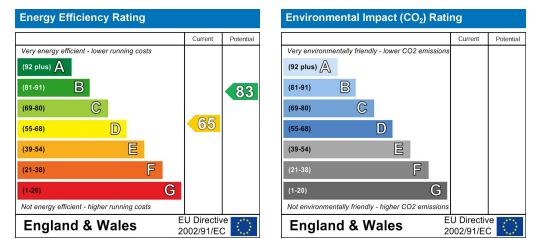

These particulars, whilst believed to be accurate are set out as a general outline only for guidance and do not constitute any part of an offer or contract. Intending purchasers should not rely on them as statements of representation of fact, but must satisfy themselves by inspection or otherwise as to their accuracy. No person in this firm's employment has the authority to make or give any representation or warranty in respect of the property.