



Garden Walk, London, EC2A

BUTLER & STAG





# An exceptional opportunity to reside in a gorgeous fifth floor apartment in the heart of the Shoreditch Triangle.



- Exceptional One Bedroom Apartment
- Over 750 Sq/Ft
- Communal Roof Terrace
- Unfurnished
- Fifth Floor
- Modern and Well-Presented
- Shoreditch Triangle Location
- Available from 16th January 2026

This over-sized property spans more than 750 Sq/Ft of internal living space and is positioned within a secure development tucked away at the end of Garden Walk, round the corner from Rivington Street, just a short stroll from Old Street station and countless amenities.

Modern and well-presented throughout, the apartment comprises of an incredibly spacious kitchen/reception with an additional space for relaxing or working from home, a large double bedroom, contemporary bathroom and plenty of storage. Residents can also enjoy the use of a communal roof terrace.

Perfectly suited to a single professional or a couple, this must-see property is offered unfurnished and is available from 16th January 2026.

EPC Rating C  
Council Tax Band E







## Garden Walk

Approx. Gross Internal Area 72.18 Sq M ( 777 Sq Ft )

BUTLER & STAG

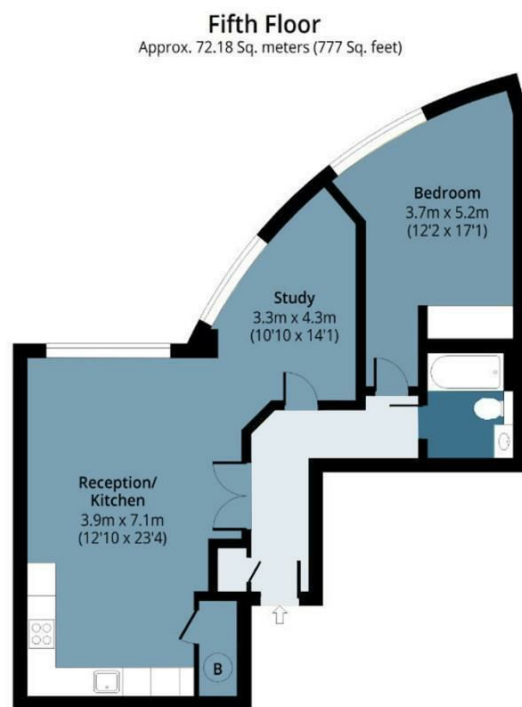

Measurements are approximate and for illustration purposes only. While we do not doubt the accuracy and completeness, we advise you conduct a careful independent assessment of the property to determine monetary value.  
© @modephoto.uk www.modephoto.co.uk

IMPORTANT NOTICE - These particulars have been prepared in good faith and they are not intended to constitute part of an offer or contract. We have not performed a structural survey on this property and the services, appliances and specific fittings have not been tested. All photographs, measurements, floor plans and distances referred to are given as a guide and should not be relied upon.

BUTLER & STAG

☎ 020 8102 1236

🏠 508 Roman Road, Bow, London, E3 5LU

✉ bow@butlerandstag.com

[www.butlerandstag.uk](http://www.butlerandstag.uk)