



MEDWAY STREET

LONDON, SW1P 2TB

£3,000 PER MONTH

SPACIOUS TWO DOUBLE BEDROOM GROUND-FLOOR APARTMENT OCCUPYING A WONDERFUL LOCATION IN WESTMINSTER, CENTRAL LONDON. BENEFITTING FROM ALLOCATED OFF-STREET PARKING. PERFECTLY POSITIONED FOR ACCESS TO ST JAMES' PARK AND PIMLICO TUBE STATIONS.

RP&C.
RICKY, PLANT & CHEN-PORTER



Ormond House

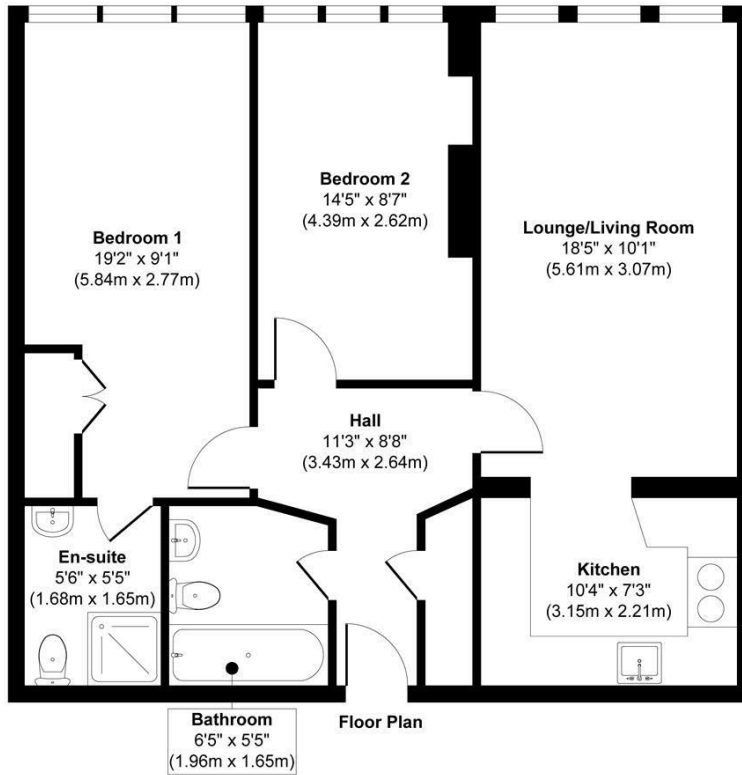

Approx. Gross Internal Floor Area 769 sq. ft / 71.44 sq. m

Illustration for identification purposes only, measurements are approximate, not to scale.
Produced by Elements Property



Energy Efficiency Rating		Current	Potential
<small>Very energy efficient - lower running costs</small>			
(92 plus) A			
(81-91) B			
(69-80) C		74	76
(55-68) D			
(39-54) E			
(21-38) F			
(1-20) G			
<small>Not energy efficient - higher running costs</small>			
England & Wales		EU Directive 2002/91/EC	

Agents Note: Whilst every care has been taken to prepare these particulars, they are for guidance purposes only. All measurements are approximate and are for general guidance purposes only and whilst every care has been taken to ensure their accuracy, they should not be relied upon and potential buyers/tenants are advised to recheck the measurements

RP & C Estate Agents
15 Nelson Street
Southend On Sea
SS1 1EF

01702 844984
info@rpcestateagents.co.uk
www.rpcestateagents.co.uk

