



**POOLE
TOWNSEND**

38 Lightburn Road,
£325,000

5 2 2



- Fantastic 3 storey townhouse • Excellent location within walking distance of town
- 2 reception rooms • Yard with useful store
- Attractive kitchen/diner • No upper chain
- 5 bedrooms • Freehold
- 2 bathrooms • Council tax band



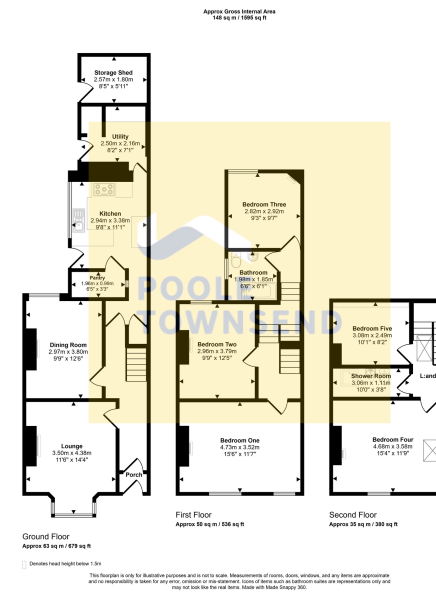

Occupying a central position in the heart of Ulverston, this elegant three-storey townhouse combines period charm with modern practicality. Ideally located within walking distance of the town's independent shops, well-regarded schools and excellent transport links, it offers an enviable lifestyle for families and professionals alike. A welcoming entrance hall with its original tiled floor leads to two bright and versatile reception rooms, while the breakfast kitchen features a walk-in pantry and is complemented by a separate utility room and useful store. Across the first and second floors are five generous bedrooms, a family bathroom and a separate shower room, providing flexible accommodation for growing families, home working or guests. Outside, the enclosed rear courtyard offers a private space to relax and includes a useful garden store for bikes, tools and outdoor equipment.

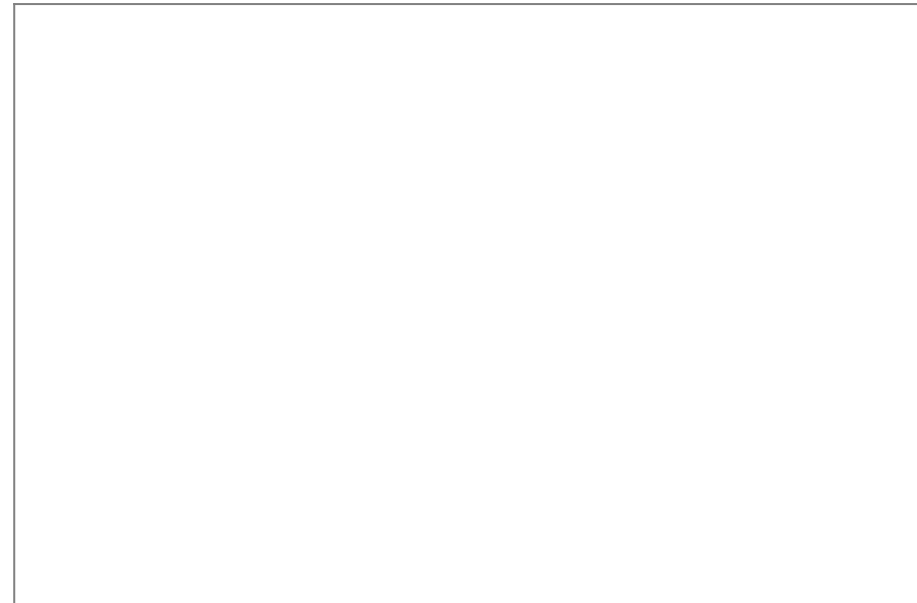

Visit us at
www.pooletownsend.co.uk
enquiries@pooletownsend.co.uk

We are open
 Monday – Friday 9.00 – 5.00
 Saturday 9.00 – 1.00

Barrow 01229 811811
 Ulverston 01229 588111
 Grange 015395 33316
 Kendal 01539 734455
 Milnthorpe 015395 62044