

Payton
Jewell
Caines



7 Maes Bryn, Bridgend - CF31 4TX
Bridgend

£250,000



7 Maes Bryn

Bridgend, Bridgend

Introducing this extended three bedroom semi detached house situated within a pleasant cul-de-sac in the sought after location of Cefn Glas, within easy walking distance of local Primary (Cefn Glas Juniors and Llangewydd Juniors) and Secondary (Bryntirion) Schools as well as a local bus route. The property benefits from an enclosed rear garden and off road parking. Early viewing highly recommended.

- Three bedroom semi detached house
- Downstairs WC and first floor shower room
- Extension / Sun room
- Enclosed rear garden
- Driveway parking to the front
- EPC / Council tax band C



Entrance

Via part panelled / part glazed composite front door into the entrance hall.

Entrance Hall

Stippled ceiling, part emulsioned/part papered walls with dado rail, laminate flooring, radiator, PVCu frosted window to the side of the property and doors leading to the downstairs w.c. and lounge. Stairs leading to the first floor.

Lounge

13' 9" x 10' 6" (4.20m x 3.20m)

Stippled and coved ceiling, emulsioned walls, fitted carpet, under stairs storage, radiator and PVCu window to the front of the property. Feature brick wall with fireplace, wooden surround with marble hearth and gas fire insert. Opening into the dining area.

Downstairs WC

6' 7" x 2' 7" (2.00m x 0.80m)

Stippled ceiling, part emulsioned / part tiled walls, radiator, laminate flooring and PVCu frosted window to the front of the property. Two piece suite comprising low level w.c. and wall mounted wash hand basin with stainless steel taps.

Kitchen / Diner

15' 9" x 10' 2" (4.80m x 3.10m)

Stippled and coved ceiling, emulsioned walls with tiling to the splash back areas, tiled flooring, fire door leading into the integral garage, PVCu window overlooking the rear garden and PVCu frosted door leading out to the rear garden. A range of wall and base units with complementary work surfaces housing a one and half bowl sink drainer with stainless steel mixer tap. Integrated dishwasher, under counter fridge and freezer. Breakfast bar, double oven with four ring whirlpool gas burner and extractor hood above.



Dining Area

9' 2" x 8' 6" (2.80m x 2.60m)

Stippled and coved ceiling, emulsioned walls, fitted carpet, radiator and PVCu French doors leading to the extension / sun room and door leading into the kitchen/diner.

Extension / Sun Room

13' 9" x 6' 7" (4.20m x 2.00m)

Emulsioned ceiling and walls, PVCu window to the rear of the property and PVCu French doors leading onto the patio area with windows either side. Radiator, tiled effect laminate flooring and ceiling light.

Landing

Via stairs with fitted carpet and wooden balustrade, part emulsioned / part papered walls with dado rail and stippled ceiling. Attic access and PVCu frosted window to the side of the property. Doors leading to the shower room, three bedrooms and airing cupboard housing the Worcester boiler.

Bedroom 1

12' 2" x 10' 6" (3.70m x 3.20m)

(12' 2" max x 10' 6" max) or (3.70m max x 3.20m max) measurements are to the wardrobes.

Stippled ceiling, emulsioned walls, fitted carpet, radiator, built in wardrobes and PVCu window to the front of the property.

Bedroom 2

8' 10" x 10' 6" (2.70m x 3.20m)

Stippled ceiling, emulsioned walls, laminate flooring, radiator and PVCu window overlooking the rear of the property.

Bedroom 3

8' 2" x 8' 2" (2.50m x 2.50m)

Stippled ceiling, emulsioned walls, fitted carpet, built in storage, radiator and PVCu double glazed window to the front of the property.

Shower Room

5' 3" x 5' 7" (1.60m x 1.70m)

Emulsioned ceiling with spot lights, tiled walls, vinyl tile effect flooring and PVCu window with fitted blind to the rear of the property. Three piece suite comprising w.c. vanity unit housing the wash hand basin with stainless steel mixer tap and matching wall unit and walk in shower with stainless steel rain forest shower head with hand attachment and stainless steel and glass screen. White towel radiator.

Outside

Enclosed rear garden bound by wall and fencing, the patio area can be accessed via the kitchen/diner and the sun room. Outside tap, paved steps leading to the rear of the garden and area laid to lawn with mature shrubs. External electric socket. Paved driveway to front of the property and garage accessed via up and over door.

Garage

19' 8" x 7' 7" (6.00m x 2.30m)

Via door from the kitchen/diner, electric and plumbing for washing machine, tumble dryer and fridge/freezer. Attic space, accessed via up and over door to the front door.



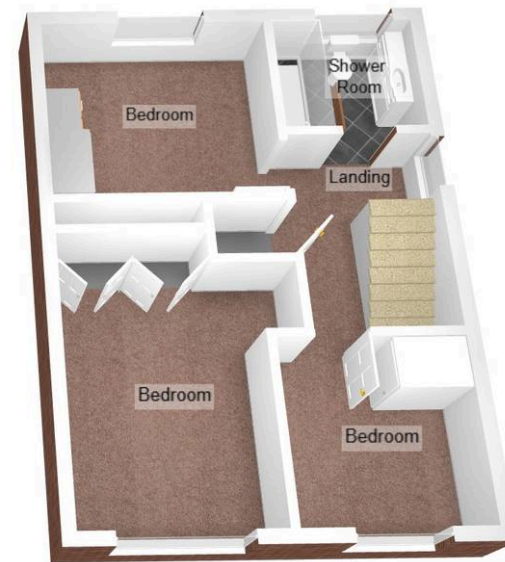

Payton Jewell Caines

Payton Jewell Caines Ltd, 8 Dunraven Place – CF31 1JD

01656654328 • bridgend@pjchomes.co.uk • pjchomes.co.uk/

These property details are provided as a general guide only. Whilst we aim for accuracy, measurements, photographs, floor plans, and descriptions should not be relied upon as statements of fact. Buyers should carry out their own checks regarding the property, services, and specifications. Fixtures and fittings are only included if specifically stated. Appliances and services have not been tested.