



80 Delph Drive, Burscough

Ormskirk

£150,000

Located in the popular Heathfields development, this well presented two bedroom apartment has been freshly updated throughout, benefiting from new decoration and new flooring, creating a stylish and move-in ready home. The accommodation comprises a welcoming hallway, a bright and spacious lounge, fitted kitchen, two double bedrooms, and four piece bathroom. Externally, the property also benefits from allocated parking for added convenience. Offered to the market with no onward chain, this property would make an ideal purchase for first-time buyers, those looking to downsize, or buy-to-let investors alike. Early viewing is highly recommended.

Council Tax band: B

Tenure: Leasehold

- Upper Floor Apartment
- Two Double Bedrooms
- Newly Decorated & New Flooring Throughout
- Allocated Parking
- Spacious With Lounge & Kitchen Separate
- Ideal For Downsize, First Time Buyers or Buy To Let Investors
- Gas Central Heating
- No Onwards Chain

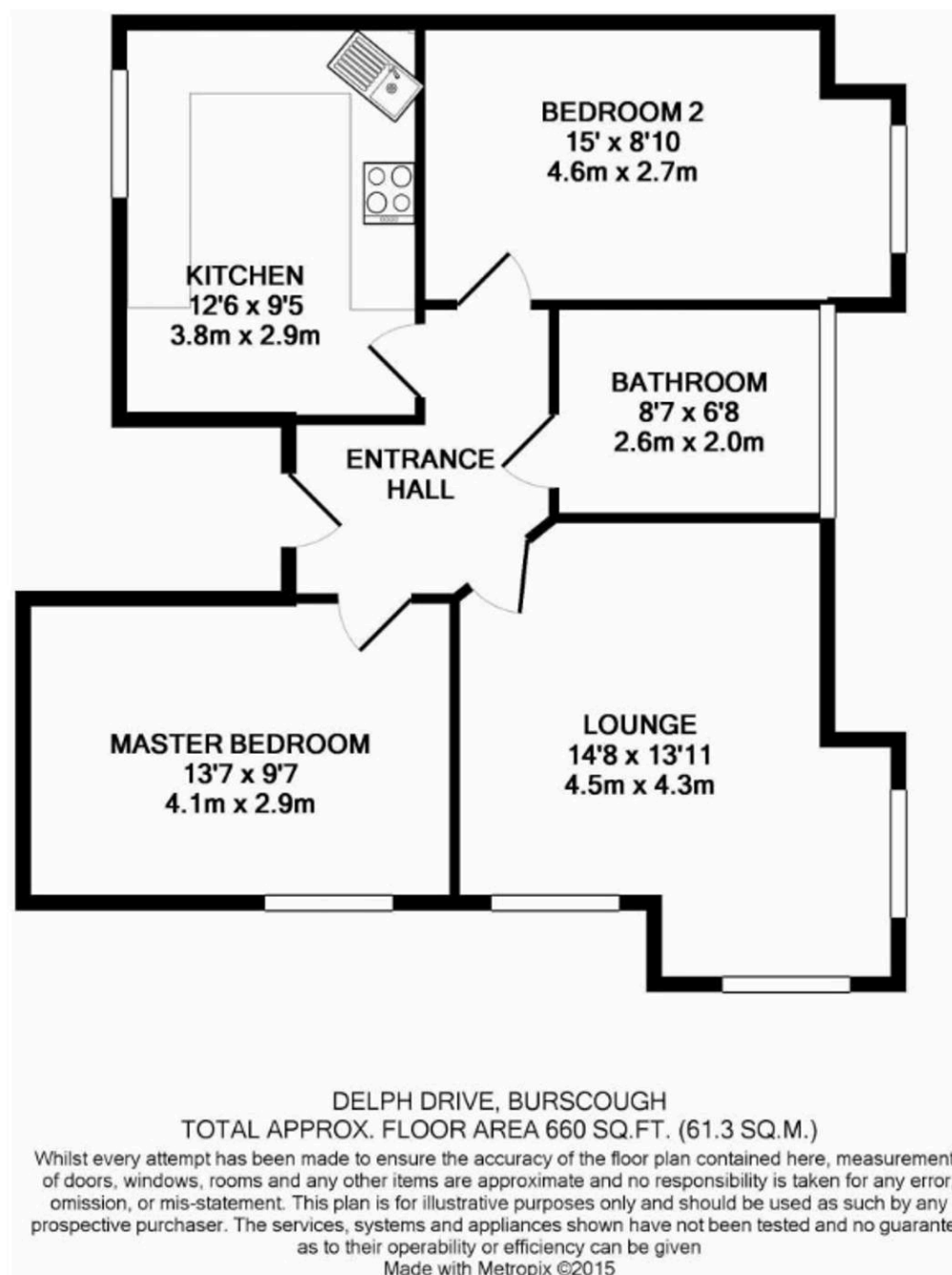

Entrance Hall

Front door to hall with doors leading to lounge, kitchen, two bedrooms and bathroom.

Lounge

14' 0" x 14' 8" (4.27m x 4.48m)

Two windows to front and side.

Kitchen

9' 4" x 13' 0" (2.85m x 3.97m)

A good range of eye and low level units incorporating stainless steel sink and drainer unit. Built in electric hob with extractor over, built in electric oven and integrated dishwasher and washing machine. Built in storage cupboard. Laminate flooring and window to front.

Bedroom One

9' 5" x 11' 6" (2.87m x 3.50m)

Built in wardrobes and window to front.

Bedroom Two

8' 10" x 12' 8" (2.70m x 3.86m)

Built in wardrobe and window to side.

Bathroom

6' 8" x 8' 2" (2.03m x 2.50m)

Four piece suite comprising panelled bath, shower cubicle, pedestal wash hand basin and low level WC. Partly tiles walls, new flooring and window to side.

Allocated parking

Allocated parking space with visitor spaces.







Victoria Estates & Property Management

49 Liverpool Road North, Burscough - L40 0SA

01704 897647 • tori@vepm.co.uk • <http://vepm.co.uk>

