

Elm Grove, SW19

£500,000

A first floor apartment with two bedrooms, two bathrooms and a good sized balcony located within the centre of Wimbledon. There is a high specification throughout, including German & Italian appliances in the kitchen. There is also a share of freehold for the development.

80% NOW SOLD - PLEASE CALL TO VIEW

Elm Grove is a cul-de-sac situated just off of Worple Road and just under half a mile walk from Wimbledon Broadway allowing easy access to the town centre's restaurants and shops. Transport links include overground, underground and a number of good bus routes.

Features

- Share Of The Freehold
- 999 Year Lease
- Balcony
- Two Bedrooms
- Two Bathrooms
- Eco-Conscious Build
- Bike & Parcel Store

Elm Grove, Wimbledon, SW19

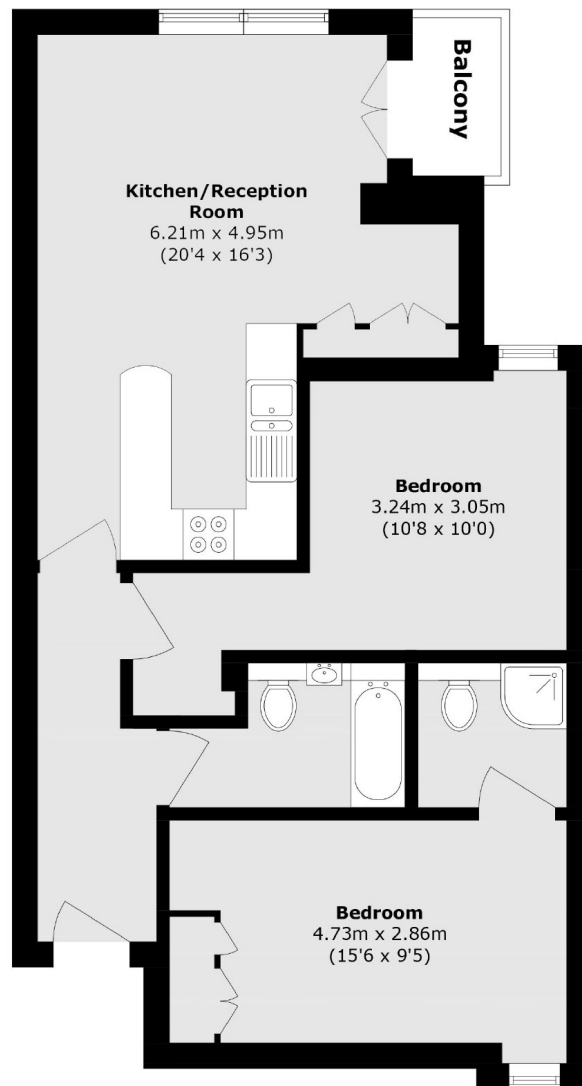

Total area (approx.): 65.6 sq. m (706.1 sq. ft)

Balcony area (approx.): 1.9 sq. m (20.4 sq. ft)