



50 Burgage Road  
Stogursey, Somerset TA5 1RB

**Brightest**move

# Brightest move

£220,000



Brightestmove are enthused to bring to the market a spacious and well-presented three bedroom terraced house, in the highly desirable village location of Stogursey.

With a front outlook of a small and maintained green, the property welcomes you through a convenient porch which opens to a large living room with storage options under the stairs with access to the first floor. Through sliding doors to the kitchen/diner with ample worktop space, wall and base units and access to the rear garden through single and double doors. On the first floor, you have three good sized bedrooms, two of which are doubles and the family bathroom. The garden is stone chipped, with two spacious and handy sheds and you will also find the large oil container, which was installed approx. three years ago.



Nestled on the edge of the Quantock Hills, Stogursey is a charming Somerset village known for its historic character and strong community spirit. The village features traditional cottages, a medieval church, and the remains of a motte-and-bailey castle that reflect its rich heritage. Surrounded by beautiful countryside and within easy reach of the coast, Stogursey offers a peaceful rural lifestyle while remaining well connected to nearby towns.

For more information or an appointment to view please contact the vendors sole agents.

SERVICES: Mains electricity, water and drainage

HEATING: Oil fired central heating

TENURE: Freehold

COUNCIL TAX BAND: B

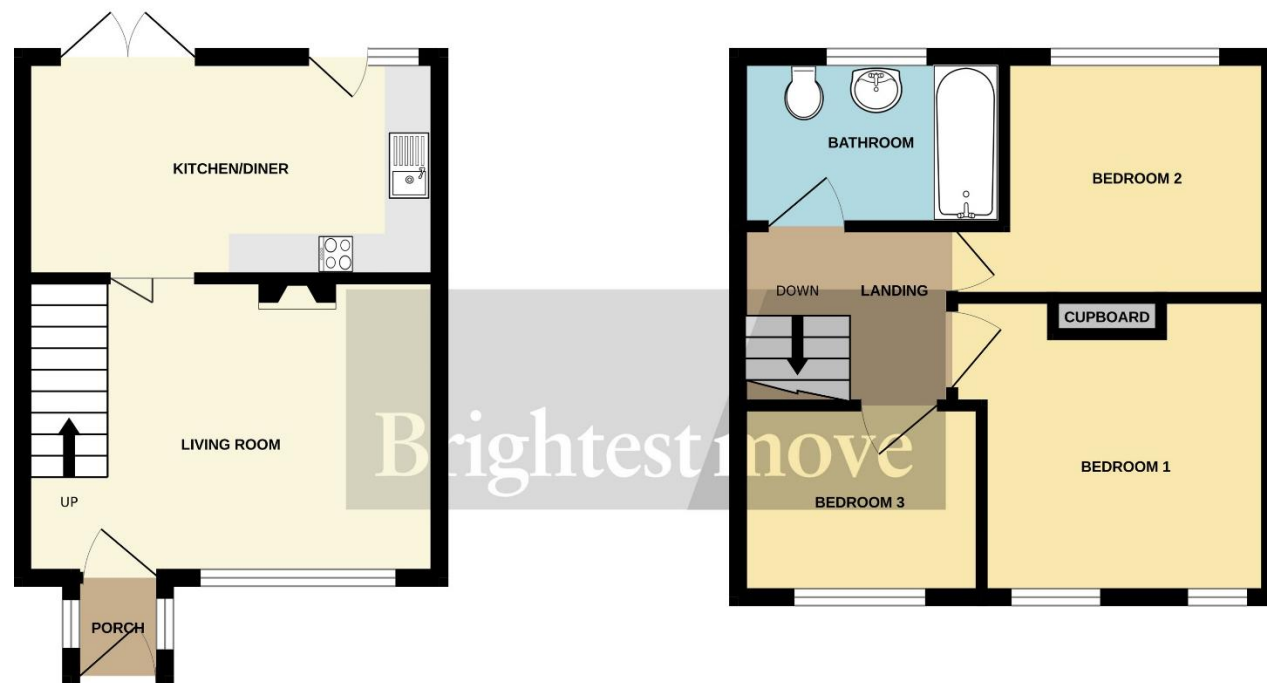

- Living room** 19' 10" x 11' 03" (6.05m x 3.43m)
- Kitchen/Diner** 19' 11" x 8' 05" (6.07m x 2.57m)
- Bedroom One** 13' 05" x 9' 11" (4.09m x 3.02m)
- Bedroom Two** 11' 11" x 8' 07" (3.63m x 2.62m)
- Bedroom Three** 8' 09" x 8' 00" (2.67m x 2.44m)

Score	Energy rating	Current	Potential
92+	A		
81-91	B		
69-80	C		71 C
55-68	D	63 D	
39-54	E		
21-38	F		
1-20	G		

No statement in these details is to be relied upon as representation of fact, and purchasers should satisfy themselves by inspection or otherwise as to the accuracy of the statements contained within. These details do not constitute any part of any offer or contract. CMH Southwest limited trading as Brightest Move and their employees and agents do not have any authority to give warranty or representation whatsoever in respect of this property. These details and all statements herein are provided without any responsibility on the part of CMH Southwest limited trading as Brightest Move or the vendors. CMH Southwest limited trading as Brightest Move has not tested the equipment or central heating system mentioned in these particulars and the purchasers are advised to satisfy themselves as to the working order and condition. Measurements: Great care is taken when measuring, but measurements should not be relied upon for ordering carpets, equipment, etc. This property sheet forms part of our database, and is protected by the database right and copyright laws. No unauthorised copying or distribution without permission.

28 High Street, Bridgwater, Somerset TA6 3BJ

Tel: 01278 420444

bridgwater@brightestmove.co.uk

www.brightestmove.co.uk

**Brightest move**