



Westbourne Grove, W11

£2,747 Per calendar month

Dexters



Westbourne Grove, W11

A spacious two bedroom ground floor apartment set within an attractive building on Westbourne Grove, featuring wooden flooring throughout and a semi open plan layout that opens onto a generous private garden.

Located on Westbourne Grove, surrounded by a wide selection of stylish boutiques, cafés and restaurants. Notting Hill Gate Underground station is the nearest, with Portobello Road also just a short walk away.

Features

- Two Double Bedroom
- One Bathroom
- Large Private Garden
- Wood Flooring
- Open Plan Kitchen
- Contemporary Finish



Westbourne Grove, London, W11

Garden Flat

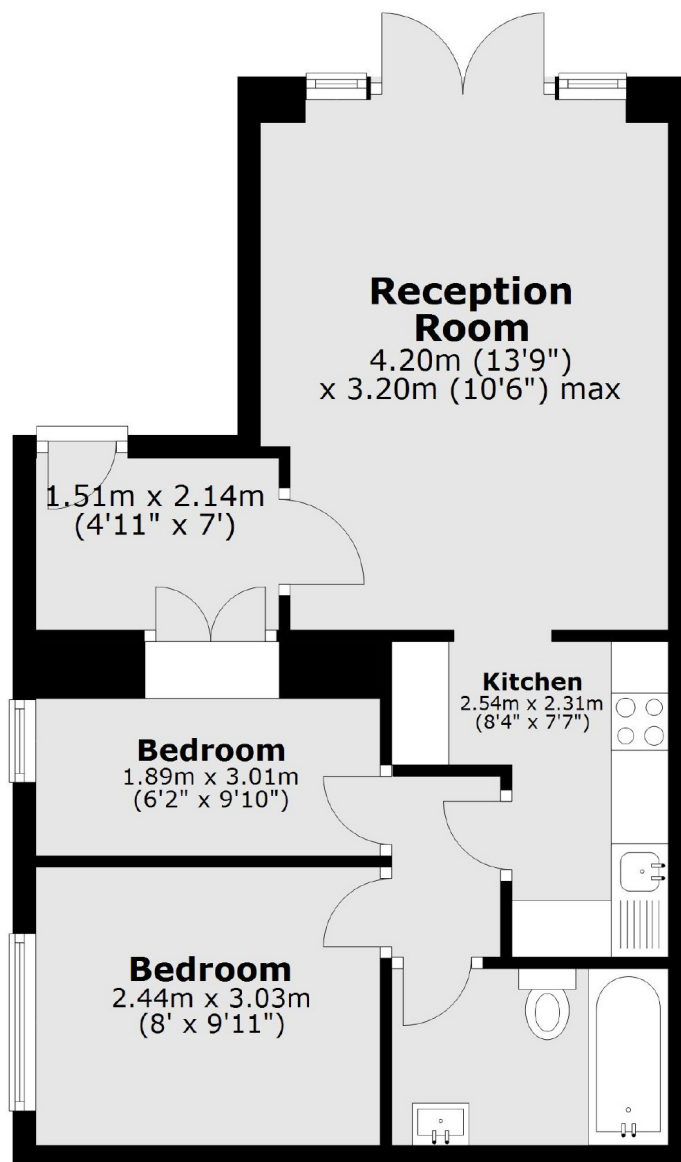

Total area: approx. 44.9 sq. metres (482.8 sq. feet)