

14 Lon Derw, Abergele, Conwy, LL22 7EA

£250,000

3 1 1



This detached bungalow comprises of three bedrooms, a bright and airy lounge/diner, galley style kitchen and a family bathroom. The property also benefits from a fully enclosed rear garden with pleasant views of the wooded hillside, single garage and ample driveway parking. Set within the popular town of Abergele and within walking distance of the town center, with it's wide range of amenities including a variety of shops, leisure facilities and schools for all ages. Access to the A55 Expressway is within one mile, giving excellent transport links to the North Wales coast and beyond.

Key Features

- Detached bungalow
- Large lounge with dining space
- Single garage
- Fully enclosed rear garden
- Council tax - D
- Driveway parking
- Three bedrooms
- Close to amenities
- EPC- D
- Freehold

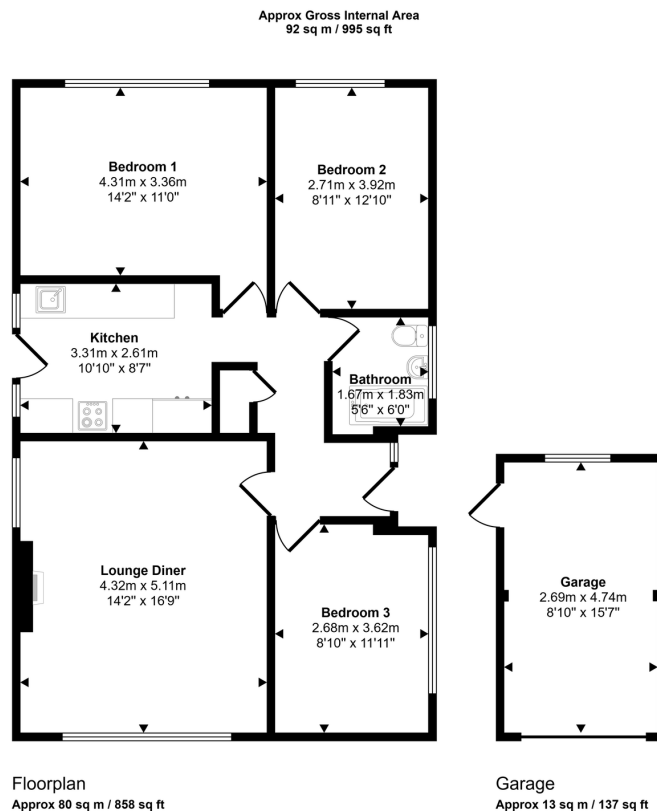

This floorplan is only for illustrative purposes and is not to scale. Measurements of rooms, doors, windows, and any items are approximate and no responsibility is taken for any error, omission or mis-statement. Icons of items such as bathroom suites are representations only and may not look like the real items. Made with Made Snappy 360.