



Orpington Gdns, Edmonton, N18

£2,250 PCM

3 1 1 D

## Floor Plan

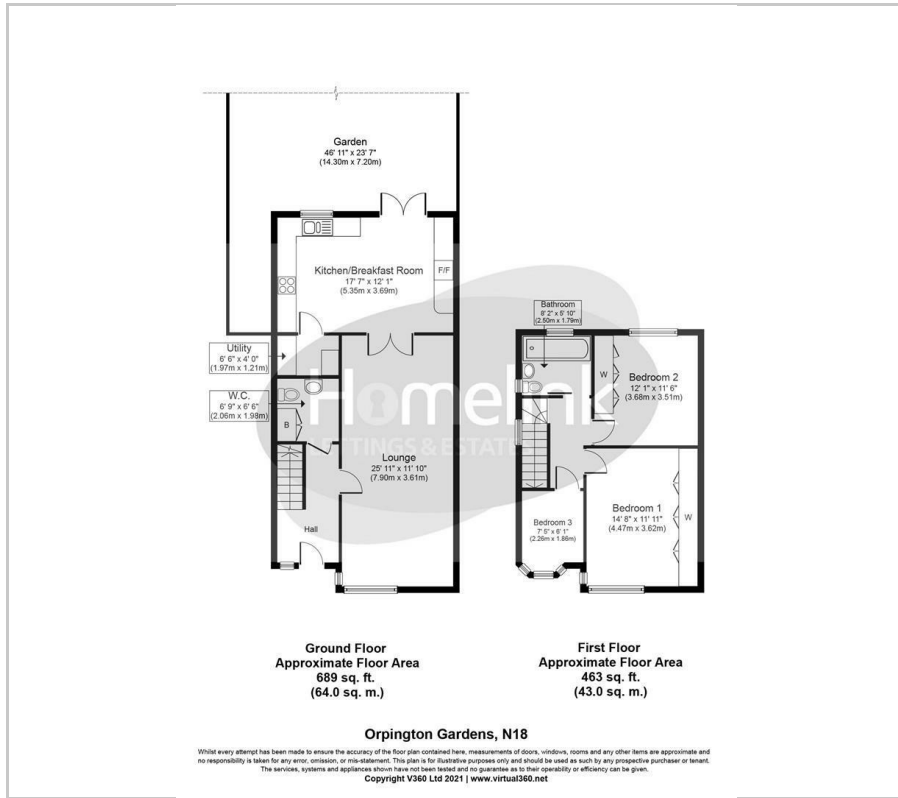

## Area Map

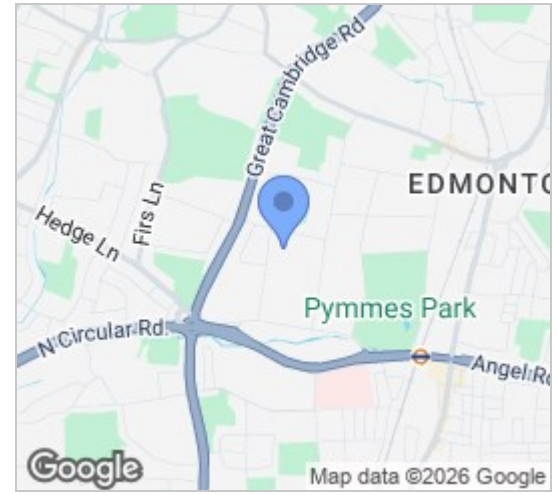

## Energy Efficiency Graph

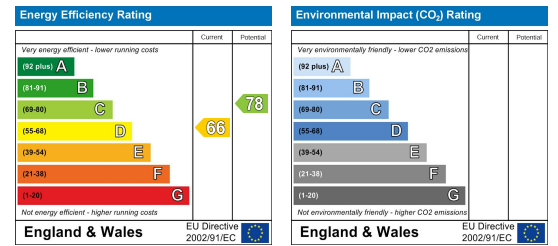

## Viewing

Please contact our Homelink Lettings & Estates Office on 0208 882 2112 if you wish to arrange a viewing appointment for this property or require further information.

- Three Bedroom Semi for rent
- Spacious Kitchen/Breakfast Room
- Large Through Lounge
- Lawned Rear Garden
- Off Street Parking
- Wooden Flooring
- Double Glazing
- Great Road Links
- Ideal Family Home
- Must be Seen



Welcome to this charming three-bedroom semi-detached house located in the desirable area of Orpington Gardens, Edmonton, N18. This delightful property is perfect for working professionals seeking a comfortable and convenient living space.

Upon entering, you will find a spacious reception room that has been newly painted throughout, creating a fresh and inviting atmosphere. The well-proportioned bedrooms offer ample space for relaxation and personalisation, making it an ideal home for families or individuals alike. The property also features a well-appointed bathroom, ensuring all your needs are met.

One of the standout features of this home is the private rear garden, providing a tranquil outdoor space for leisure and entertaining. Additionally, the property boasts off-street parking for two vehicles, a valuable asset in this bustling area.

With its excellent location, this semi-detached house is well-suited for those who commute, offering easy access to local amenities and transport links. This property presents a wonderful opportunity for anyone looking to settle in a vibrant community while enjoying the comforts of a well-maintained home. Don't miss the chance to make this lovely house your new home.

Council tax band - E - Enfield council - £2,644.91 - 26/27



These particulars, whilst believed to be accurate are set out as a general outline only for guidance and do not constitute any part of an offer or contract. Intending purchasers should not rely on them as statements of representation of fact, but must satisfy themselves by inspection or otherwise as to their accuracy. No person in this firm's employment has the authority to make or give any representation or warranty in respect of the property.

Homelink Lettings and Estates  
62 Chase Side, London N14 5PA  
0208 882 2112 [homelink.co.uk](http://homelink.co.uk)

