



**Sherbourne, 24 Stonehurst, Sutton Road, Shrewsbury, SY2 6DD**

1 bedroom apartment — £154,000 Share of Freehold

# Sherbourne, 24 Stonehurst, Sutton Road, Shrewsbury, SY2 6DD

Coopergreenpooks.co.uk

£154,000 Share of Freehold — 1 bedroom apartment

sales@cgpooks.co.uk

Situated within an imposing former school building of character, this well-presented first floor apartment offers neatly presented and well-designed accommodation, while retaining plenty of period features such as high ceilings and large sash windows. The property is located within a very popular residential area, and benefits from private allocated parking and landscaped communal gardens.

## KEY FEATURES

- Impressive communal entrance opening to stunning main hall which has a beautiful staircase, parquet flooring and stained-glass light lantern
- Sherbourne is on the first floor of the building accessed via the stunning central landing, and quietly tucked away through a separate hallway
- Private inner hallway with telephone intercom system
- Large open plan living/dining room with feature chimney breast and recess, window overlooking the gardens, and useful store cupboard
- Modern fitted kitchen with a range of units and space for appliances
- Good-sized double bedroom and en-suite shower room
- Electric heating and fully double-glazed sash windows - installed within the last 6 years
- Neatly kept communal garden, complete with seating and drying areas for residents' use. There is also a communal cellar and bike storage facilities, as well as private storage for each flat
- Allocated parking space to the rear of the building
- Sold with a share of the freehold and managed by the residents with a long lease, no ground rent and an annual service charge of £1,440 PA (with option to pay monthly)
- A fantastic location within a sought-after residential area, just a short distance from excellent amenities such as shops and a doctor's surgery, with lovely walks through the Reabrook Nature Reserve, as well as being within a 30 minute walk of the town centre

## First Floor

Approx. 45.3 sq. metres (487.6 sq. feet)

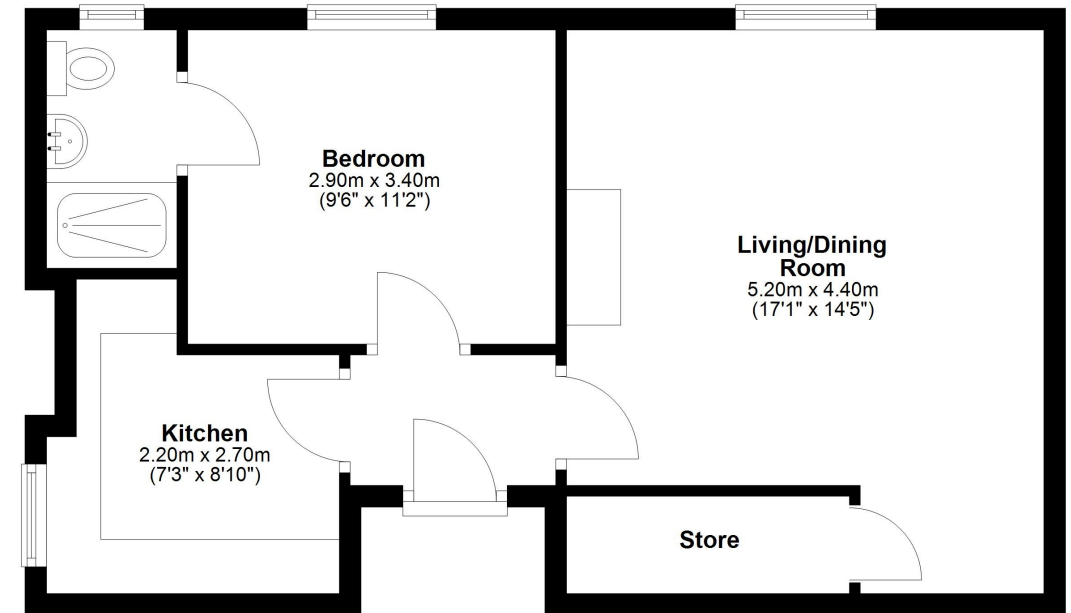

Total area: approx. 45.3 sq. metres (487.6 sq. feet)









Cooper Green Pooks  
3 Barker Street  
Shrewsbury  
SY1 1QF

[www.cgpooks.co.uk](http://www.cgpooks.co.uk)  
[sales@cgpooks.co.uk](mailto:sales@cgpooks.co.uk)  
01743 276666



# Sherbourne, 24 Stonehurst, Sutton Road, Shrewsbury, SY2 6DD

£154,000 Share of Freehold — 1 bedroom apartment

sales@cgbooks.co.uk

rightmove 

 OnTheMarket.com

 **RICS**  
Regulated by RICS

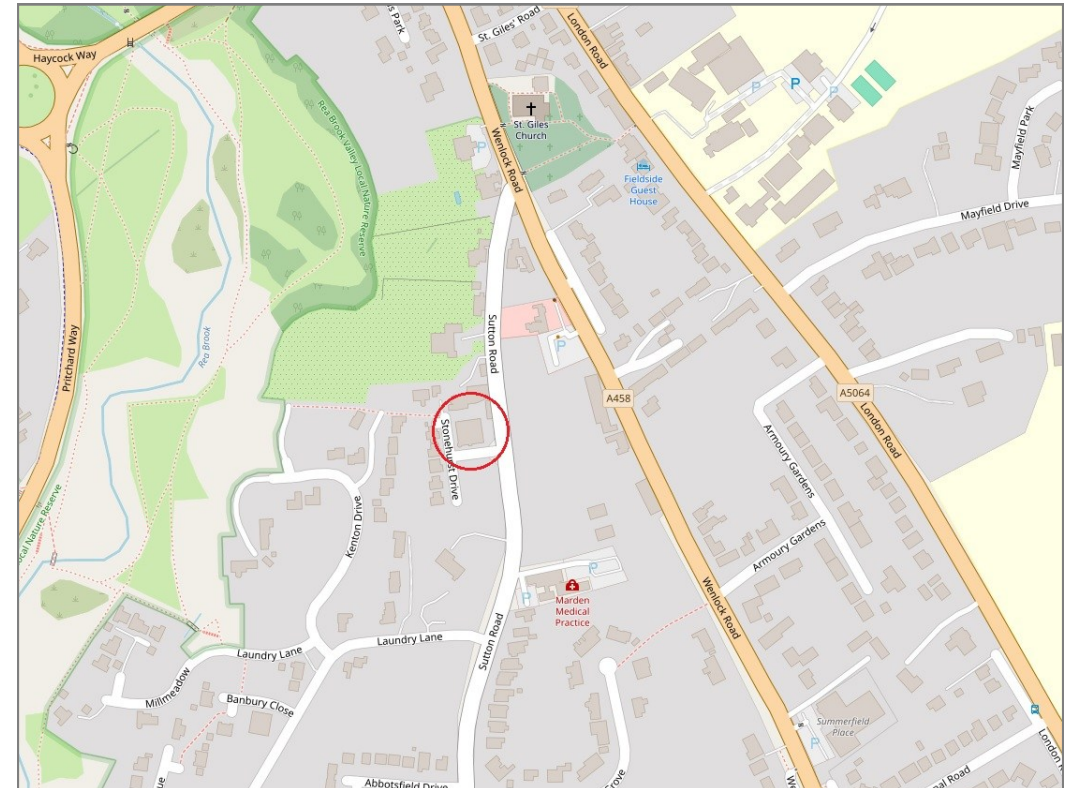
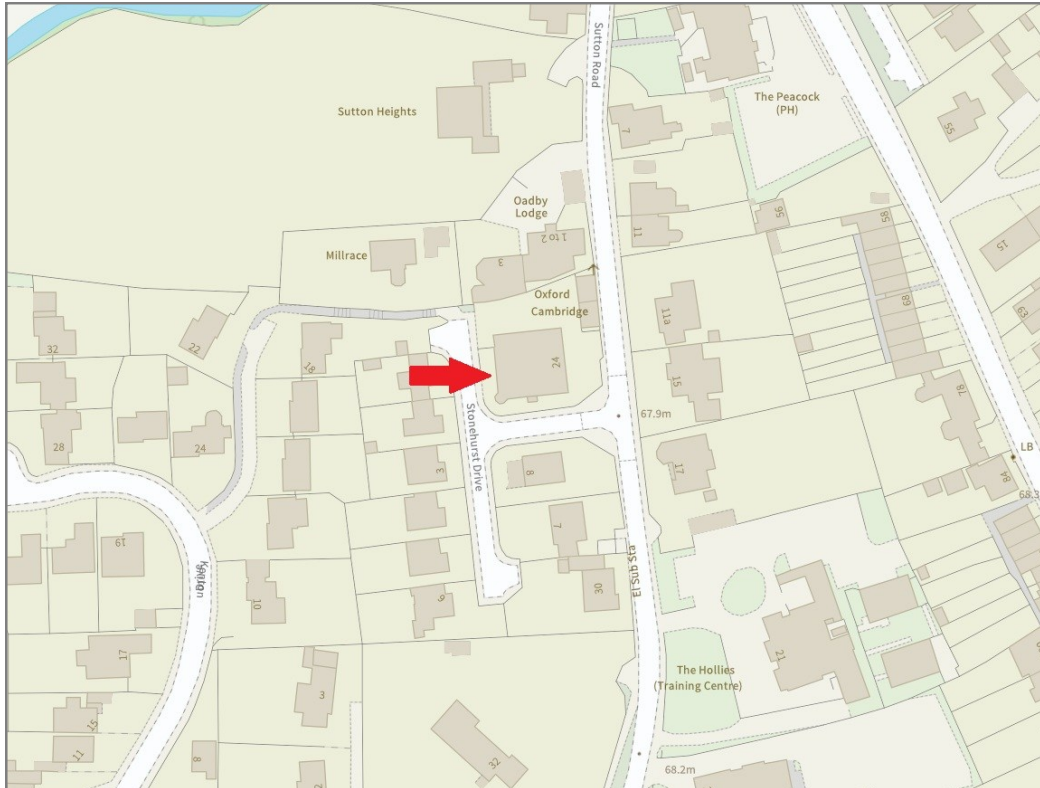

**BOUNDARIES NOT CONFIRMED**

Local Authority	<b>Shropshire Council</b>
Council Tax	<b>Band A</b>
EPC Band	<b>Band D</b>
Services	<b>Mains water, electricity and drainage are connected. Electric heating.</b>

Tenure	<b>Share of Freehold</b>
Lease Length	<b>964 years remaining</b>
Service Charge	<b>£1,440 per annum (option to pay monthly)</b>

# Sherbourne, 24 Stonehurst, Sutton Road, Shrewsbury, SY2 6DD

Coopergreenpooks.co.uk

£154,000 Share of Freehold — 1 bedroom apartment

sales@cgpooks.co.uk

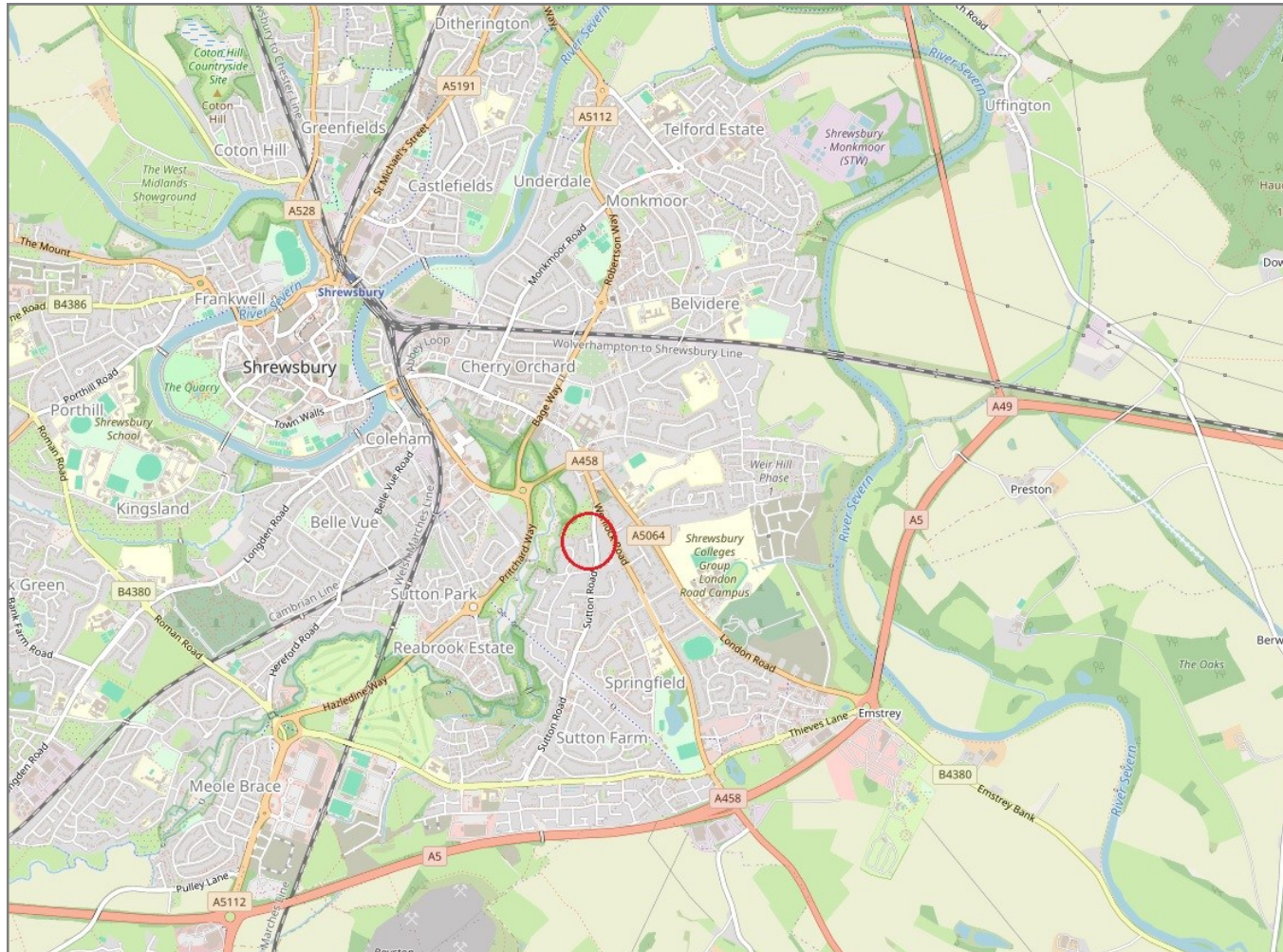

**IMPORTANT NOTICE:** Cooper Green Pooks for themselves and for the lessors or vendors of this property whose agents they are give notice that: 1 No appliances, services or service installations have been tested and no warranty as to suitability or serviceability is implied. Any prospective purchaser or lessee is advised to obtain verification from their surveyor or solicitor. 2. The particulars are set out as a general outline only for the guidance of the intended purchasers or lessees and do not constitute, nor constitute part of, an offer or contract. 3. All descriptions, reference to condition and necessary permissions for use and occupation and other details are given in good faith and are believed to be correct but any intending purchasers or lessees should not rely on them as statements or representation of fact but satisfy themselves by inspection or otherwise as to the correctness of each of them. 4. No person in the employment of Cooper Green Pooks has any authority to make or give any representation or warranty whatsoever in relation to this property. 5. All rentals and prices are quoted exclusive of Stamp Duty, legal and surveyors fees and any other associated purchasers or lessees costs. 6. Floor plans are indicative only and should not be relied on. 7. The plan showing the boundary of the property is indicative only and has not been checked against the legal title so should not be relied on. 8. All dimensions, floor areas and site areas are only approximate and should not be relied on. Dimensions are generally maximum room dimension.