



73 Redhouse Way, Swindon

Swindon

£300,000
mcfarlane
property.com



73 Redhouse Way

Swindon, Swindon

A stylish and spacious three-storey terraced home set in the desirable Redhouse development. This well-designed property offers generous accommodation throughout, including a large kitchen/diner opening onto the rear garden and an additional family room on the ground floor. The first floor features an impressive living room with dual Juliet balconies, filling the space with natural light, along with a well-sized double bedroom.

The top floor hosts two further double bedrooms, including a superb main bedroom complete with fitted wardrobes and a private en-suite. Outside, the property offers a mature, enclosed rear garden, along with a single garage and allocated parking. Positioned close to local amenities, schools, and commuter links, this home combines convenience with modern family living.

- Bright first-floor living room with twin Juliet balconies
- Spacious kitchen/diner with direct garden access
- Three double bedrooms including en-suite main bedroom
- Three-storey terraced town house in sought-after Redhouse
- Garage and allocated parking





Garage

Approx. 14.6 sq. metres (157.5 sq. feet)



Ground Floor

Approx. 38.3 sq. metres (412.8 sq. feet)

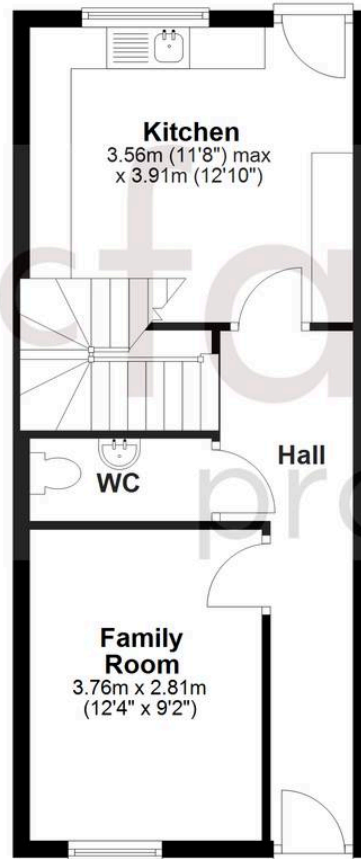

First Floor

Approx. 38.3 sq. metres (412.2 sq. feet)

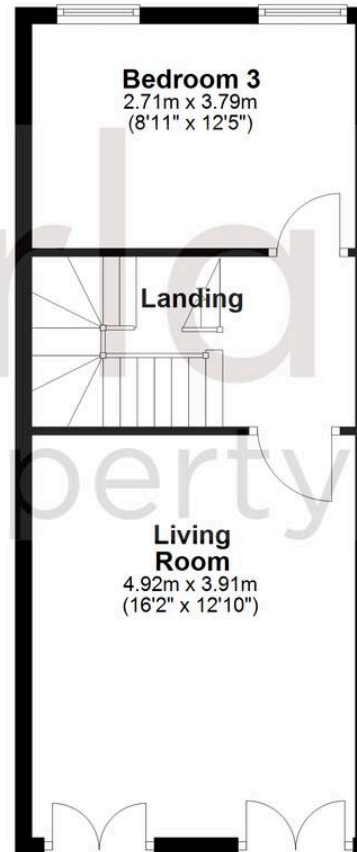

Second Floor

Approx. 35.2 sq. metres (378.4 sq. feet)
(excluding En-suite)

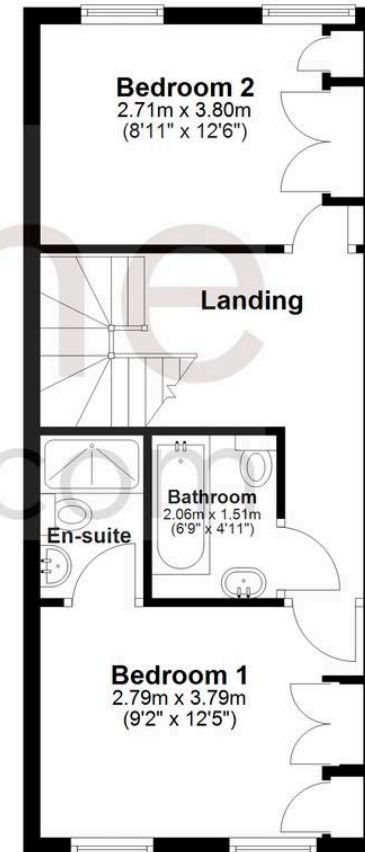

Total area: approx. 126.4 sq. metres (1360.9 sq. feet)

McFarlane Sales & Lettings

North Swindon, Redhouse Village Centre, Swindon - SN25 2FW

01793 296600 • swindon@mcfarlaneproperty.com • www.mcfarlaneproperty.com/