



Dynham Road, NW6

£695,000

Step into this ground floor garden flat in an elegant converted Victorian building, thoughtfully extended to offer a bright, stylish open-plan kitchen/living space ideal for entertaining, plus a guest W/C, share of freehold, and no onward chain.

Dynham Road is ideally situated off West End Lane and is perfectly positioned for West Hampstead underground station (Jubilee line), Thameslink and Overground. It is also close to numerous shops, bars and restaurants.

Features

- Two Bedrooms
- Share Of Freehold
- Private Patio
- Open Plan
- Ground Floor
- No Onward Chain

Dynham Road, London, NW6

Ground Floor

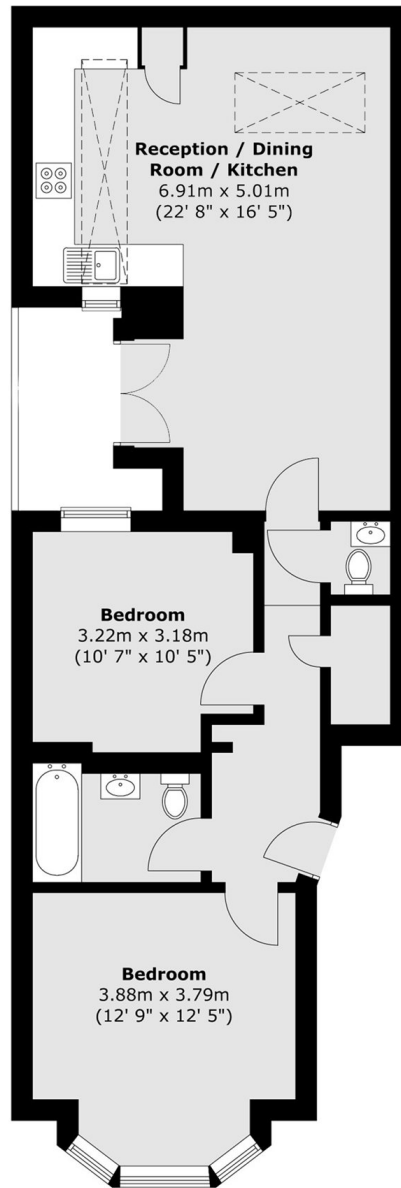

Total area (approx.) : 67.5 sq. m (727 sq. ft)