



St. Marys Road, Kettering **Freehold** £225,000

**Pattison
Lane**

Key Features

 3  1  D  A

- Three Bedroom Semi - Detached Home
- Conservatory
- Refitted Kitchen / Breakfast Room
- Presented in Fantastic Order Throughout
- Close to Local Schools

Occupying an elevated position that affords both an open outlook and a rare sense of privacy, this three-bedroom semi-detached residence has been considerably improved by the current owners to create a stylish and functional family home.

The Ground Floor

Upon entering, the hallway leads into a bright and inviting Lounge, designed for both relaxation and entertaining. To the rear, the heart of the home is the beautifully refitted Kitchen/Breakfast Room, which has been modernised to a high standard, offering a sleek, contemporary space for culinary enthusiasts. Extending the living space further is a generous Conservatory, which serves as a seamless bridge between the interior and the private outdoor space.



The First Floor

The upper level comprises three well-proportioned bedrooms, each thoughtfully laid out to maximise space and light. These rooms are served by a central landing, maintaining a classic and efficient floor plan suitable for growing families or professionals alike.

Exterior & Gardens

One of the standout features of this property is the large, private rear garden. Offering an excellent degree of seclusion, the outdoor space provides a versatile canvas for gardening, play, or alfresco dining. To the front, the property's raised vantage point ensures a pleasant, open vista.

Key Highlights:

- Significantly Upgraded: Contemporary kitchen and modernised interiors throughout.
- Living Space: Spacious lounge plus an additional conservatory.
- Privacy: Elevated front aspect and a substantial, private rear garden.
- Location: Situated in a desirable position with an open outlook.

Viewing is highly advised to fully appreciate the quality of the finish and the unique position of this home.



GROUND FLOOR

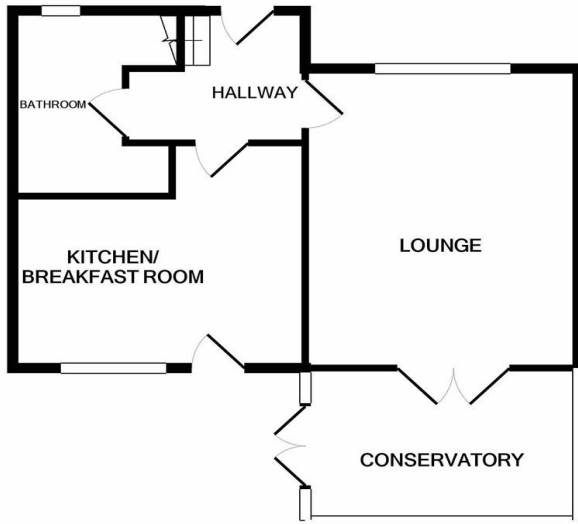

1ST FLOOR

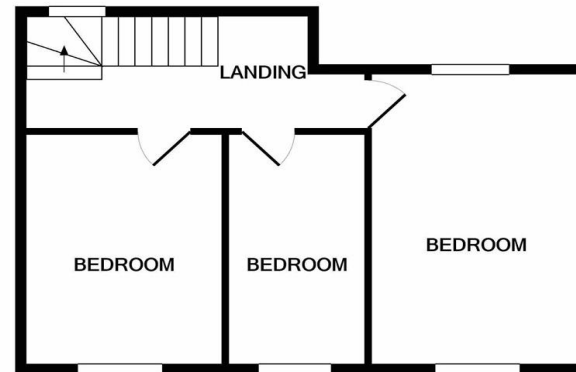

Whilst every attempt has been made to ensure the accuracy of the floor plan contained here, measurements of doors, windows, rooms and any other items are approximate and no responsibility is taken for any error, omission, or mis-statement. This plan is for illustrative purposes only and should be used as such by any prospective purchaser. The services, systems and appliances shown have not been tested and no guarantee as to their operability or efficiency can be given
Made with Metropix ©2020



The accommodation comprises:

ENTRANCE HALL

LOUNGE 11' max x 14'5 (3.35m x 4.39m)

CONSERVATORY

KITCHEN/ BREAKFAST ROOM 13'9 x 10'9 max
(3.88m x 3.27m)

GROUND FLOOR BATHROOM

FIRST FLOOR LANDING

BEDROOM ONE 14'3 x 9'6 max (4.34m x 2.89m)

BEDROOM TWO 11'3 x 9' (3.43m x 2.74m)

BEDROOM THREE 11'5 x 6'3 (3.47m x 1.90m)

OUTSIDE

FRONT GARDEN

REAR GARDEN

To view this property call Pattison Lane on:
01536 524425

Selling your property?

Contact us to arrange a **FREE** home valuation.

 01536 524425

 68-70 Gold Street, Kettering, Northamptonshire, NN16 8JB

 kettering@pattisonlane.co.uk

 www.pattisonlane.co.uk



 SCAN ME



 SCAN ME



Sharman Quinney Holdings Limited is registered in England and Wales under company number 4174227, Registered Office is Cumbria House, 16-20 Hockliffe Street, Leighton Buzzard, Bedfordshire, LU7 1GN. VAT Registration Number is 500 2481 05.

1: These particulars do not constitute part or all of an offer or contract. 2: The measurements indicated are supplied for guidance only and as such must be considered incorrect. 3: Potential buyers are advised to recheck the measurements before committing to any expense. 4: Sharman Quinney has not tested any apparatus, equipment, fixtures, fittings or services and it is the buyers interests to check the working condition of any appliances. 5: Sharman Quinney has not sought to verify the legal title of the property and buyers must obtain verification from their legal representative. 6: Intending purchasers will be asked to produce identification documentation at a later stage and we would ask your co-operation in order that there will be no delay in agreeing the sale. Ref: KPL206655 - 0004

