

Wash Lane, Leigh, WN7 2TE
£365,000

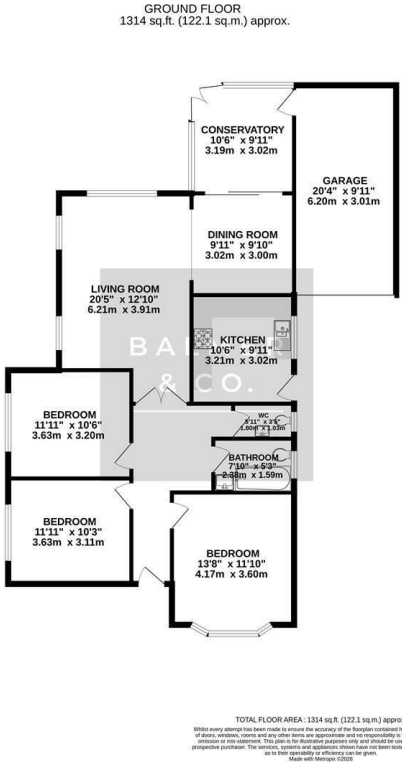

BALMER & CO in LEIGH are delighted to offer FOR SALE this fantastic three bedroom detached bungalow situated in a popular and well regarded residential location in Leigh. Very well maintained by its current owner, this property is very nicely presented throughout and occupies a generous plot. Comprising in brief of entrance hallway, large living room with feature gas fireplace and surround, modern fitted kitchen with integrated appliances, separate dining room, conservatory, three large double bedrooms, modern three piece bathroom, separate W.C, with a single integral garage completing the accommodation on offer. Externally the property is garden fronted with a large horseshoe driveway providing ample off-road parking whilst to the rear there is a fully enclosed, South-West facing, private garden. Early viewings highly recommended, all enquiries welcome.

Floor Plan



Area Map

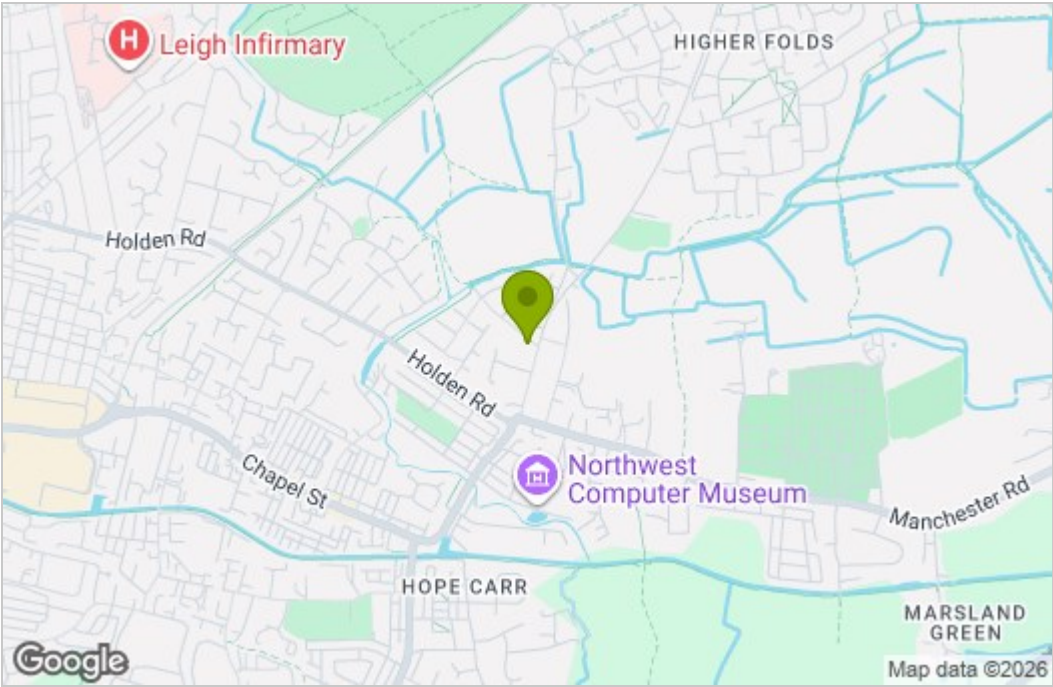

Energy Efficiency Graph

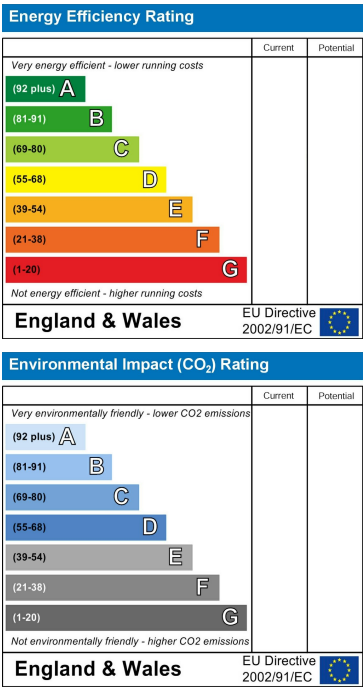

These particulars, whilst believed to be accurate are set out as a general outline only for guidance and do not constitute any part of an offer or contract. Intending purchasers should not rely on them as statements of representation of fact, but must satisfy themselves by inspection or otherwise as to their accuracy. No person in this firm's employment has the authority to make or give any representation or warranty in respect of the property.