



Chestnut Crescent, March, Cambs, PE15 9TG

Semi-Detached Bungalow - 2 Bedrooms - Kitchen/Breakfast Room - Lounge - Conservatory - Bathroom - Single Garage & Driveway - Low Maintenance Front & Rear Gardens - EPC Rating: D - Call To View (01354) 696700

£250,000



Hallway
Double glazed entrance door, radiator, airing cupboard and doors to:

Kitchen/Breakfast Room
3.85m (12'8") x 3.32m (10'11")
Fitted with a matching range of base and eye level units with worktop space over, ceramic sink, tiled splashbacks, plumbing for washing machine, space for fridge/freezer, built-in electric fan assisted double oven, built-in four ring electric hob with pull out extractor hood over, boiler/pantry cupboard, radiator, vinyl flooring, ceiling spotlights, door to:-

Conservatory
Brick and uPVC construction, radiator, vinyl flooring and double doors to the enclosed rear garden.

Lounge
5.13m (16'10") x 3.32m (10'11")
Double glazed bow window to front, fireplace and radiator.

Bedroom 1
3.69m (12'1") x 3.03m (9'11")
Double glazed window to front, fitted with a range of wardrobes with drawers and radiator.

Bedroom 2
3.85m (12'8") x 3.03m (9'11")
Double glazed window to rear, meter cupboard and radiator.

Bathroom
Recently refitted with three piece suite comprising panelled bath with separate shower over and folding glass screen, wash hand basin in vanity unit with storage under, WC with hidden cistern, two double glazed windows to side, vinyl flooring and extractor fan.

Outside
There is a front garden laid to stone chippings and a block weave driveway to the side leading to the garage which has up and over door, electric and rear door to enclosed rear garden. The enclosed rear garden is mainly laid to patio & artificial grass for low maintenance with plants, shrubs and timber shed.

EPC Rating: D

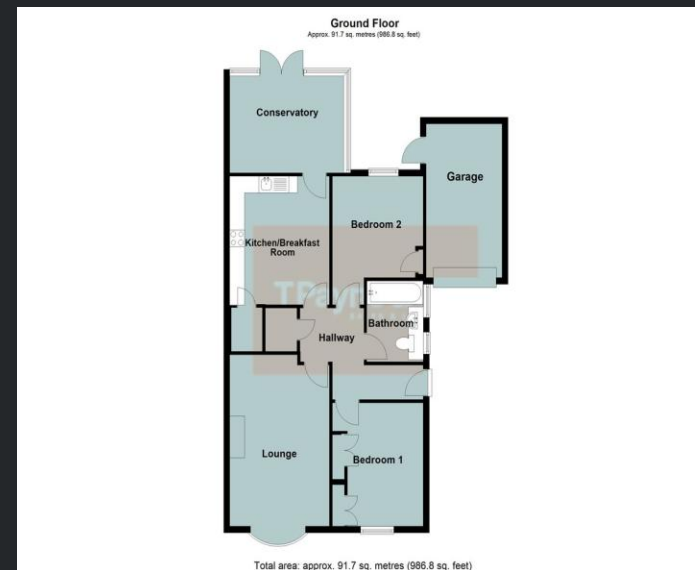

Call to arrange a viewing **01354 696700** **T Payne & Co**
SALES & LETTINGS

Agents Notes: Whilst every care has been taken to prepare these sales particulars, they are for guidance purposes only. All measurements are approximate and for general guidance purposes only and whilst every care has been taken to ensure their accuracy, they should not be relied upon and potential buyers are advised to recheck the measurements.