

CHARLOTTE COURT, EAST BARNET ROAD, EN4

£2,450 PCM

* HIGH SPECIFICATION PENTHOUSE APARTMENT * Goldman Greg are delighted to offer this newly built two double bedroom furnished luxury penthouse apartment located within Charlotte Court on East Barnet Road.

The property benefits from a huge balcony, fully fitted kitchen with built in appliances and air conditioning perfect for the summer months!

Gas and water are included within the rent.

Available NOW!



Goldman Greg

East Barnet Road, EN4 8QZ

Approx Gross Internal Area = 72.45 sq m / 780 sq ft

Balcony = 23.04 sq m / 248 sq ft

Total = 95.49 sq m / 1028 sq ft

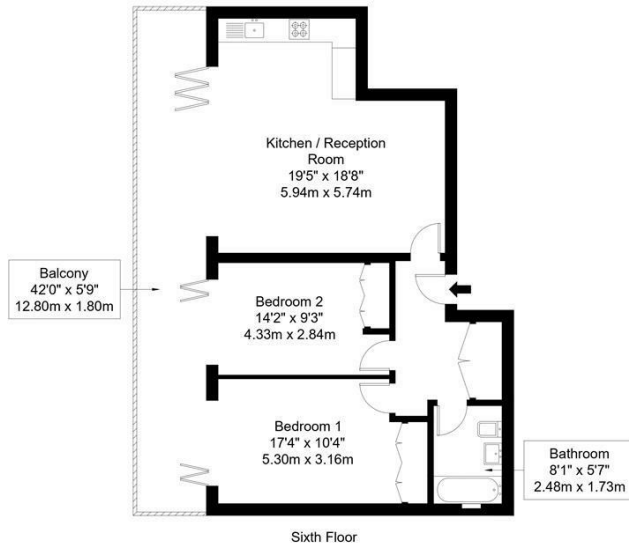

Ref :

Copyright **BLEU PLAN**

The Floor plan is not to scale and measurements and areas shown are approximate and therefore should be used for illustrative purposes only. The plan has been prepared in accordance with the RICS code of Measuring Practice and whilst we have confidence in the information produced it must not be relied on. Maximum lengths and widths are represented on the floor plan. If there is any aspect of particular importance, you should carry out or commission your own inspection of the property.
Copyright @ BLEUPLAN

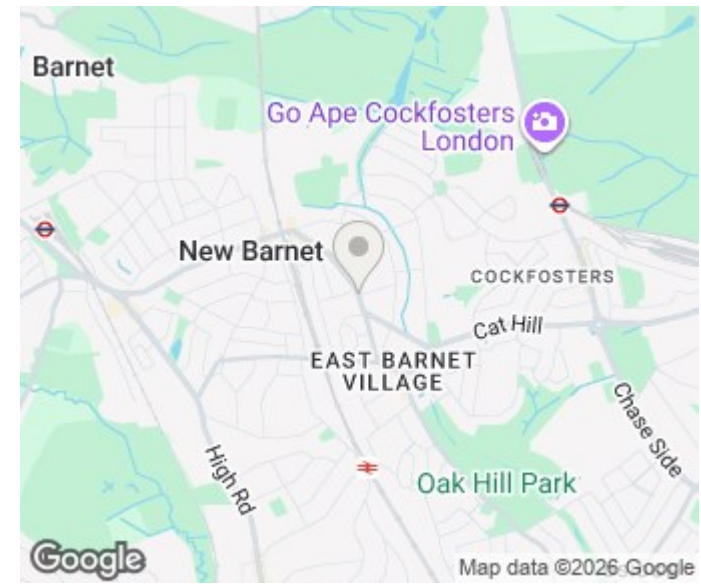

Energy Efficiency Rating		Current	Potential
Very energy efficient - lower running costs			
(92 plus) A			
(81-91) B		82	82
(69-80) C			
(55-68) D			
(39-54) E			
(21-38) F			
(1-20) G			
Not energy efficient - higher running costs			
England & Wales		EU Directive 2002/91/EC	

Agents Note: Whilst every care has been taken to prepare these particulars, they are for guidance purposes only. All measurements are approximate and are for general guidance purposes only and whilst every care has been taken to ensure their accuracy, they should not be relied upon and potential buyers/tenants are advised to recheck the measurements

Goldman Greg
143 Leman Street
London
E1 8EY

02079770018
leads@goldmangreg.co.uk
www.goldmangreg.co.uk

