



## Stockwell Gardens, SW9

£2,900 Per calendar month

Spacious three double bedroom flat with a generous kitchen/dining space finished to a modern standard. This property won't be around for long so please book in fast.

Stockwell Gardens offers an enviable location giving direct access to Stockwell tube station, giving you a quick commute on both Northern and Victoria lines.

### Features

- Three Double Bedrooms
- Kitchen/Dining Room
- Second Floor Flat
- Modern Decor
- Separate WC
- Close To Transport

# Stockwell Gardens, London, SW9

## Second Floor

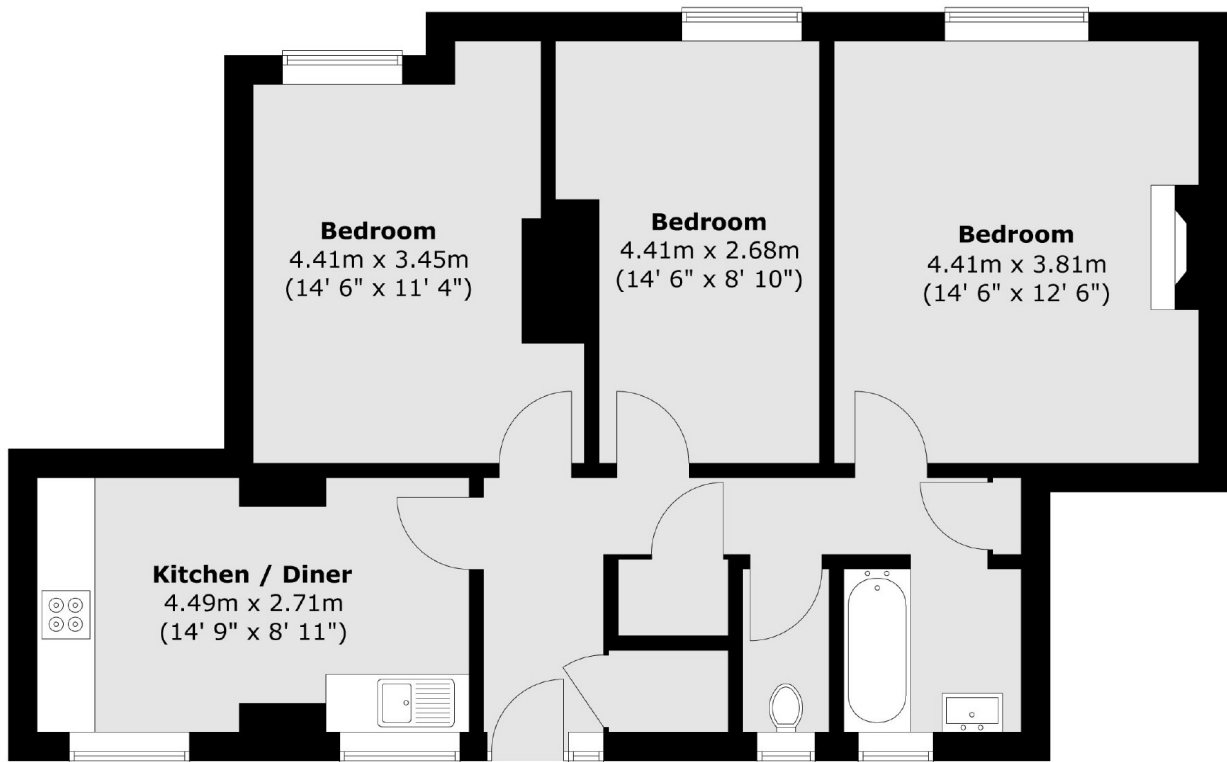

Total area (approx.) : 70.9 sq. m (763 sq. ft)