



**15 Forest Drive, Skelmersdale**

Skelmersdale

Guide Price **£199,950**

# 15 Forest Drive

Skelmersdale

Well-presented three-bed semi on Forest Drive with driveway, EV charging, modern kitchen diner, enclosed garden, no onward chain. Ideal for families or first-time buyers. Ready to move in.

Council Tax band: B

Tenure: Freehold

EPC Energy Efficiency Rating: E

EPC Environmental Impact Rating: E

- Three-bedroom semi detached home
- New Grey shaker-style kitchen
- Brand new kitchen appliances
- French doors to the rear garden
- Driveway with electric vehicle charging point
- Enclosed rear garden with patio and decking
- Neutral décor throughout





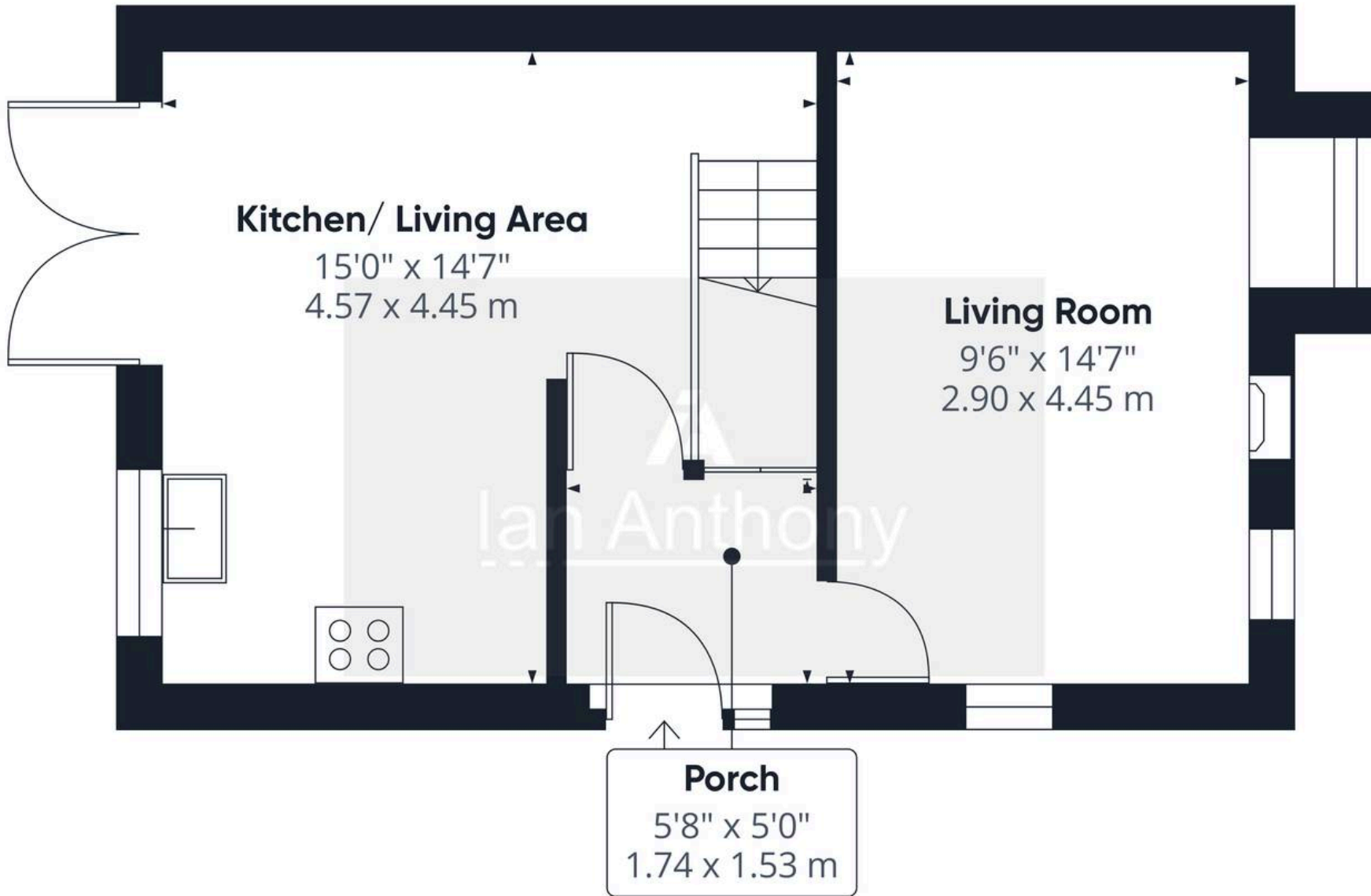

Approximate total area<sup>(1)</sup>  
361 ft<sup>2</sup>  
33.5 m<sup>2</sup>

(1) Excluding balconies and terraces

Calculations reference the RICS IPMS 3C standard. Measurements are approximate and not to scale. This floor plan is intended for illustration only.

GIRAFFE360



Ground Floor



## IAN ANTHONY

5 Burscough Street, Ormskirk - L39 2EG

01695580888

[enquiries@iananthonyestates.co.uk](mailto:enquiries@iananthonyestates.co.uk)

[iananthonyestates.co.uk/](http://iananthonyestates.co.uk/)

