



## Lake Farm Llandewi

Gower, SA3 1AU

Offers in the region of £1,150,000

A handsome Gower farmhouse with 3.68 acres, beautiful gardens, paddocks and a wonderful sense of peace at the western edge of the peninsula.

Occupying an idyllic position within the rolling landscape of rural Gower, Lake Farm is a beautifully balanced smallholding where character, comfort and practicality come together effortlessly. The property offers 3165sqft of accommodation within the main house, complemented by a range of useful outbuildings, mature gardens and approximately 2.76 acres of land arranged as paddocks and meadow.

- Beautifully restored Gower farmhouse with original longhouse heritage
- 3.68 acre smallholding with mature gardens and paddocks
- Versatile accommodation including annexe potential and attic conversion scope
- Superb range of outbuildings including a substantial barn with power and lighting

### Viewing

Please contact our The Greenroom Office on 01792 986 099 if you wish to arrange a viewing appointment for this property or require further information.



4



3



3



E

# Floor Plan

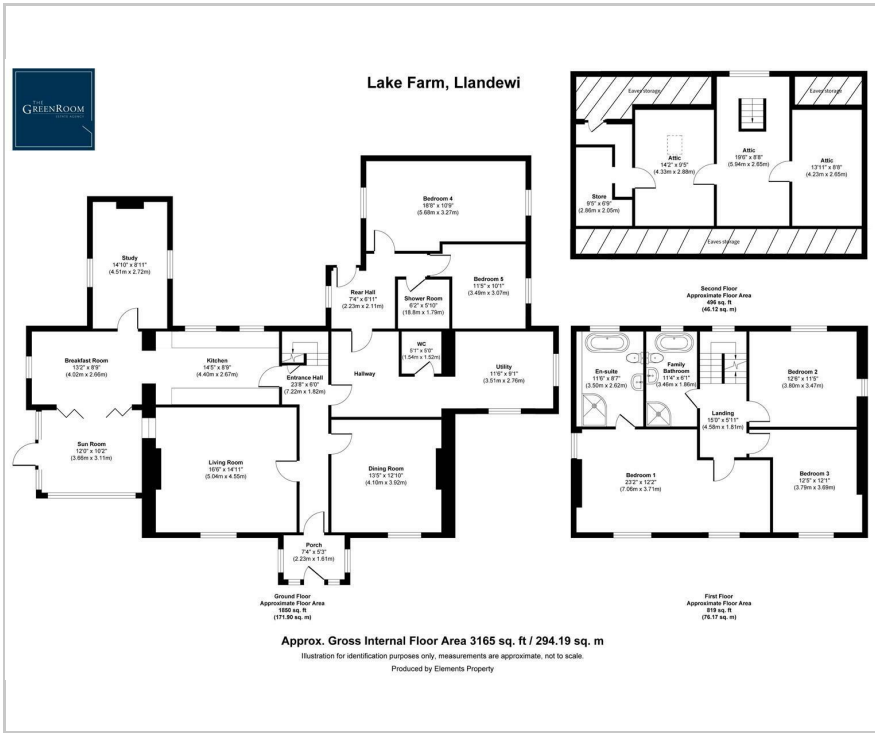

# Area Map



# Energy Efficiency Graph

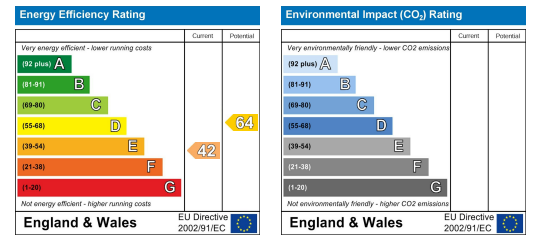

These particulars, whilst believed to be accurate are set out as a general outline only for guidance and do not constitute any part of an offer or contract. Intending purchasers should not rely on them as statements of representation of fact, but must satisfy themselves by inspection or otherwise as to their accuracy. No person in this firm's employment has the authority to make or give any representation or warranty in respect of the property.

Gower House, 28-30 Dunns Lane, Mumbles, SA3 4AA

T: 01792 986099

E: info@thegreenroomhomes.com

www.thegreenroomhomes.com

Registered office: 31 Pwlldu Lane, Bishopston, SA3 3HA