



# Primrose Walk

Grange Park, Northampton

oriordanbond  
SALES & LETTINGS



GROUND FLOOR  
509 sq.ft. (47.3 sq.m.) approx.

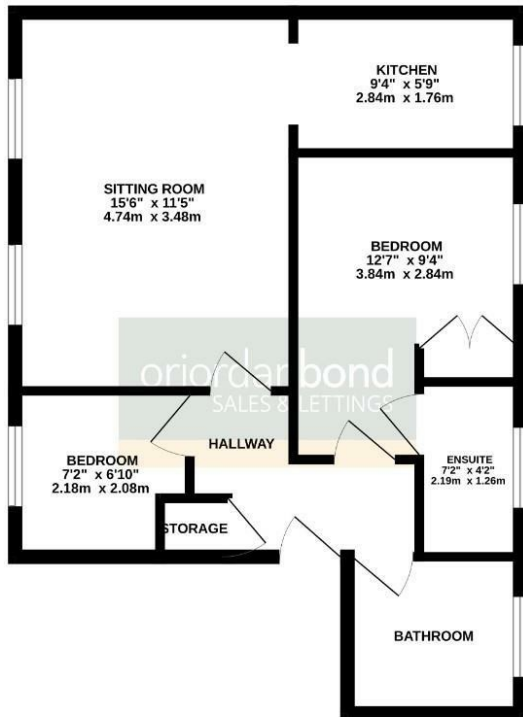

TOTAL FLOOR AREA : 509 sq.ft. (47.3 sq.m.) approx.

Whilst every attempt has been made to ensure the accuracy of the floorplan contained here, measurements of doors, windows, rooms and any other items are approximate and no responsibility is taken for any error, omission or mis-statement. This plan is for illustrative purposes only and should be used as such by any prospective purchaser. The services, systems and appliances shown have not been tested and no guarantee as to their operability or efficiency can be given.  
Made with Microtop. ©2020

## Primrose Walk

Grange Park  
NN4 5DE

OFFERS OVER £150,000

This well presented two bedroom top floor apartment is offered for sale within the desirable area of Grange Park with good access to local amenities, Foxfield Country Park and Junction 15 for the M1 and A45.

The accommodation comprises entrance hall, sitting/dining room, kitchen, three-piece bathroom suite and two bedrooms with en-suite shower room to the master. Outside is allocated parking for one car. Further benefits include uPVC double glazing and gas radiator heating. (B/509/-)

### Additional information

- Council Tax Band: B
- Energy Efficiency Rating: C

### Viewing

Viewing strictly by appointment – details below

### Disclaimer

O’Riordan Bond Estate Agents Limited has not tested apparatus, equipment, fittings or services and so cannot verify they are in working order. The buyer is advised to obtain verification from their solicitor or surveyor.

O’Riordan Bond Grange Park Sales  
01604 432007

grangepark@oriordanbond.co.uk

