



Priory Road, Reigate
£400,000





Rarely available at this price, a charming two bedroom, freehold, Victorian home with it's own private garden within walking distance to Priory Park.
What more could you want!





Situated on the south side of Reigate, this Victorian end-of-terrace home offers an increasingly rare opportunity to purchase a freehold property with private outside space at this price point.

Full of character and natural light, the property provides well-balanced accommodation across two floors. The ground floor features a welcoming living room to the front, and a separate dining room which makes an ideal space for entertaining or working from home. The modern fitted kitchen has wooden work surfaces and contrasting units in a shaker style with white metro tiling completing the look.

The bathroom is on the ground floor and, like the kitchen, has also been updated in recent years.

Upstairs, the property offers two well-proportioned double bedrooms, both benefiting from excellent natural light and generous proportions.

Externally, the property enjoys the advantage of a private garden. The garden is accessed via a private path along the side of the neighbours garden. A lovely, enclosed space with a patio, lawn and raised flower bed complete with olive trees. It's the ideal space to enjoy a BBQ in the sunshine!



Need to know

- Two double bedroom end of terrace home
- Conveniently located on the south of Reigate, within a short walk to Priory Park
- Lovely, private rear garden
- Modern shaker style kitchen with woodblock work surfaces
- Ground floor bathroom
- Two well proportioned, double bedrooms
- Good size living room and separate dining room
- Walking distance to Priory Park and local shops as well as Reigate town centre
- Close to Reigate Priory School, Sandcross School and Reigate School.

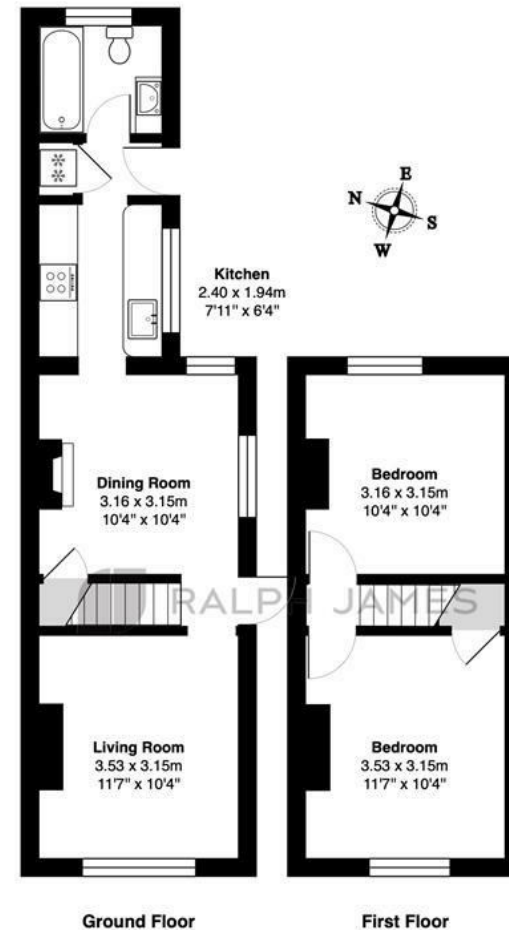

Ground Floor

First Floor

Priory Road, Reigate

Total Area: 59.1 m² ... 636 ft²

FOR ILLUSTRATIVE PURPOSES ONLY.

Whilst every attempt has been made to ensure the accuracy of the floor plan shown, all measurements, positioning, fixtures, features, fittings and any other data shown are an approximate interpretation for illustrative purposes only and are not to scale.

No responsibility is taken for any error, omission, miss-statement or use of data shown.

The above statement applies to both 'Still Moving London LTD' and the Company or individual displaying this floor plan.

Unauthorised reproduction prohibited.

Â© Still Moving London LTD (www.stillmoving.london)

 RALPH JAMES

Interested?

reigate@ralphjames.co.uk
01737 333677

ralphjames.co.uk