



Apartment (EPC Rating: B)

6-10 WHIPPENDELL ROAD, WATFORD,  
HERTFORDSHIRE, WD18 7LU

PCM

£1,300 PCM

# 1 Bedroom Apartment located in Hertfordshire

STUNNING ONE BEDROOM GROUND FLOOR APARTMENT - JUST 0.4 MILES FROM WATFORD TOWN CENTRE - 0.9 MILES FROM WATFORD JUNCTION STATION - PARKING FOR ONE CAR IN A GATED DEVELOPMENT

Located just a short walk from Watford Town Centre, this recently built and beautifully presented ground floor apartment offers modern living in a secure gated development.

The property benefits from a communal entrance with entry phone system and comprises an entrance hallway with two useful storage cupboards, a spacious double bedroom, a stunning open-plan living/kitchen area with integrated appliances including a fridge/freezer, washing machine, dishwasher, and brand new hob and oven, as well as a fully tiled contemporary grey bathroom.

Further benefits include electric heating, underfloor heating, double glazing, and one allocated parking space within the gated development.

Offered unfurnished and available from August 2026.

GATED PARKING AREA 1 SPACE



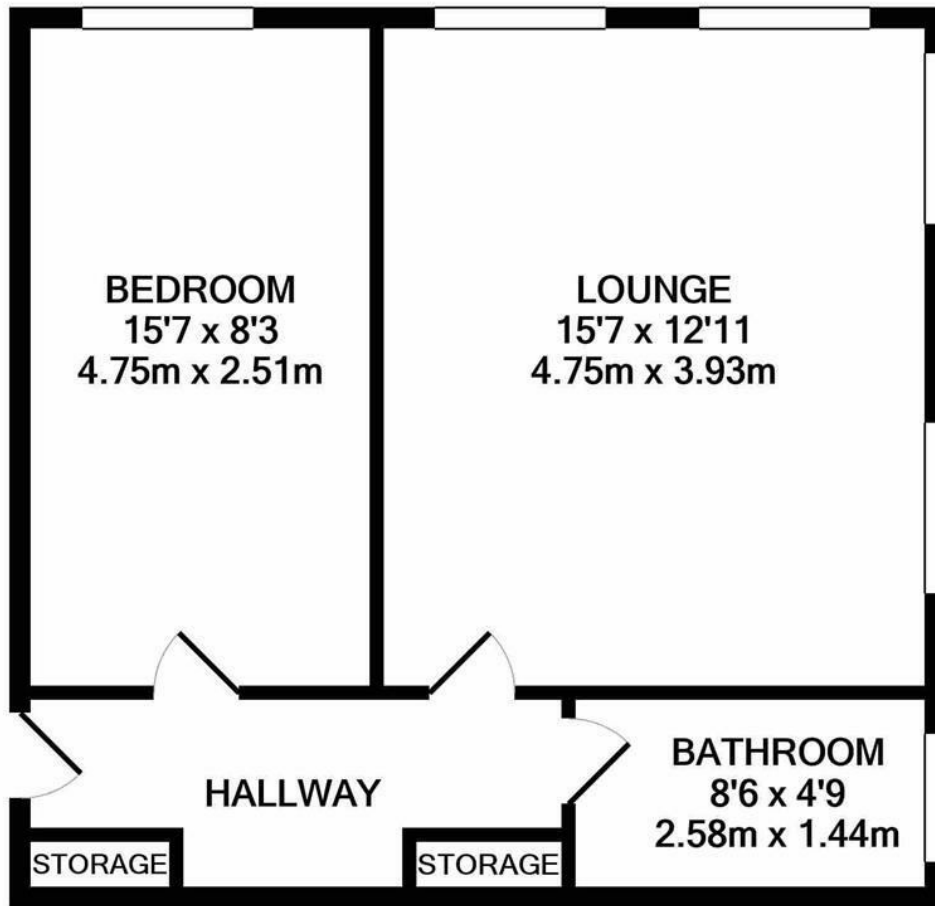

TOTAL APPROX. FLOOR AREA 429 SQ.FT. (39.9 SQ.M.)

Whilst every attempt has been made to ensure the accuracy of the floor plan contained here, measurements of doors, windows, rooms and any other items are approximate and no responsibility is taken for any error, omission, or mis-statement. This plan is for illustrative purposes only and should be used as such by any prospective purchaser. The services, systems and appliances shown have not been tested and no guarantee as to their operability or efficiency can be given  
Made with Metropix ©2020

Council Tax Band

**B**

Energy Performance Graph

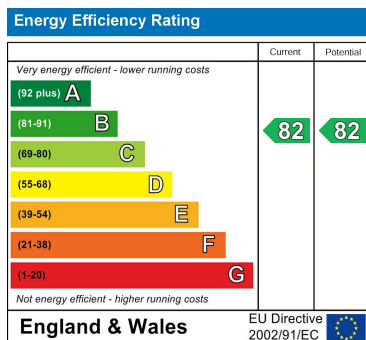

Call us on

**01923 220 012**

**rentals@warrenanthony.co.uk**

**www.warrenanthony.co.uk**

Agents Note: Whilst every care has been taken to prepare these particulars, they are for guidance purposes only. All measurements are approximate and are for general guidance purposes only and whilst every care has been taken to ensure their accuracy, they should not be relied upon and potential buyers are advised to recheck the