



131 Carpenders Avenue, Watford

Prices From £675,000





131 Carpenders Avenue

Watford, Watford

A RECENTLY REFURBISHED AND EXCEPTIONALLY PRESENTED TWO DOUBLE BEDROOM / TWO BATHROOM SEMI DETACHED BUNGALOW IN THE HEART OF CARPENDERS PARK MOMENTS FROM THE STATION.

This beautifully presented two bedroom semi detached bungalow offers an exceptional standard of single level living, having been recently refurbished throughout. The property boasts a spacious open plan living, dining and kitchen area, designed to create a bright and welcoming environment ideal for both relaxing and entertaining. The kitchen is fitted with contemporary units and integrated appliances, providing a modern and functional space for culinary enthusiasts. Both bedrooms are generous doubles, with the principal bedroom benefitting from a built in wardrobe, while the second bathroom is finished to a similarly high specification. The property measures approximately 877 square feet, maximising every inch of space for comfortable living. Additional features include double glazed windows, gas central heating, and ample built-in storage, ensuring the home is both energy efficient and practical. Located within walking distance of Carpenders Park Station and local shops, this property offers excellent convenience for commuters and those seeking easy access to every-day amenities.



The outside space is equally impressive, featuring a large private rear garden that has been beautifully manicured to provide a tranquil







Approximate Gross Internal Area
81.5 sq m / 877 sq ft

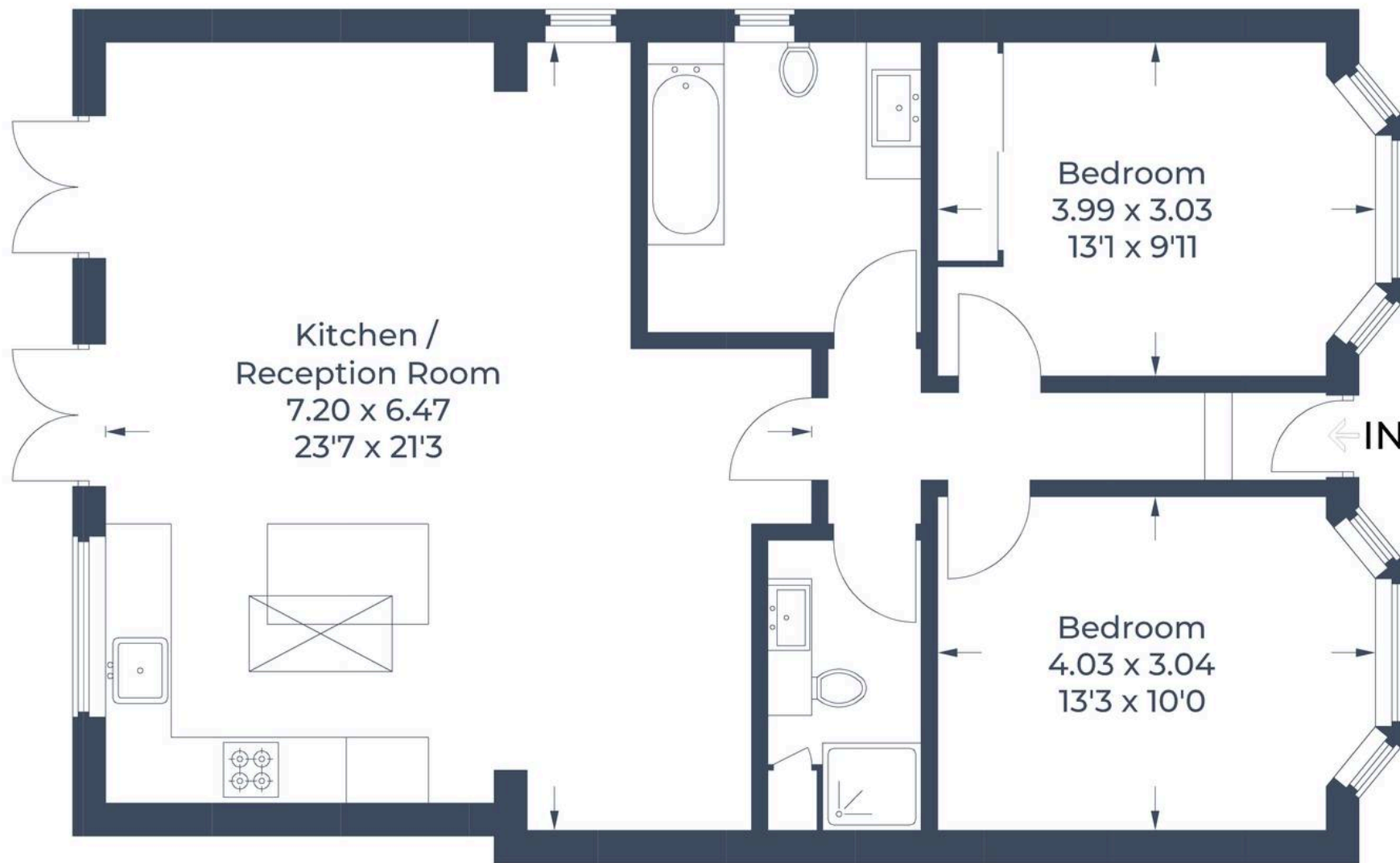

Illustration for identification purposes only,
measurements are approximate, not to scale.
© CJ Property Marketing Produced for Fairfield Estates





Fairfield – Oxhey

1 Station Approach, Watford – WD19 7DT

020 8428 0540 • rob@fairfieldstates.co.uk • fairfieldstates.co.uk/

We have prepared these particulars as a general guide of the property and they are not intended to constitute part of an offer or contract. We have not carried out a detailed survey of the property and we have not tested any apparatus, fixtures, fittings, or services. All measurements and floorplans are approximate, and photographs are for guidance only. These should not be relied upon for the purchase of carpets or any other fixtures or fittings. Lease details, service