



Shortland Road, Kettering **Freehold** £210,000

**Pattison
Lane**

Key Features

 2  1  B  B

- End Terrace Home
- Beautifully Presented Throughout
- Two Double Sized Bedrooms
- Modern Kitchen
- Living / Dining Room

Charming Two-Bedroom End-Terrace in a Prime Kettering Location

Positioned in a sought-after residential estate, this beautifully presented two-bedroom end-of-terrace home offers the perfect blend of modern living and convenience. Ideally located, the property sits within easy reach of local amenities, including shops, local pub, and excellent transport links for commuters.



A welcoming entrance hallway leads into a bright and expansive living/dining area, perfect for entertaining. The floor is completed by a contemporary kitchen and a practical downstairs guest cloakroom (WC).

Upstairs features two generously sized double bedrooms. The primary bedroom boasts the added luxury of a built-in wardrobe, providing ample storage. A sleek family bathroom serves both rooms.

To the rear, enjoy a private, enclosed garden-ideal for summer hosting. The front of the property provides the benefit of off-road parking for two vehicles.

Viewings are highly advised to appreciate all this home has to offer!

Entrance Hall

Cloakroom

Kitchen 11'4 x 6'10 (3.45m x 2.08m)

Living Room / Dining Room 15'11 x 10'10
(4.85m x 3.30m)



GROUND FLOOR



1ST FLOOR

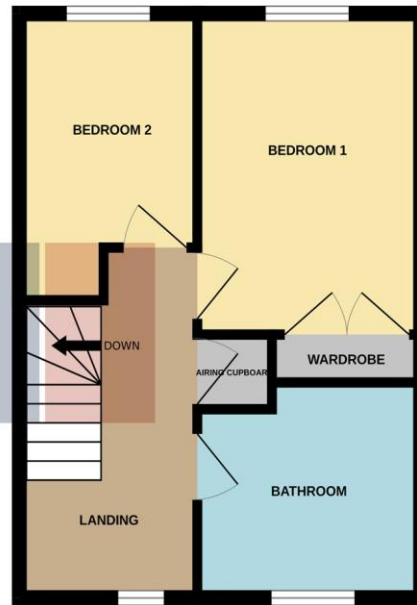

Whilst every attempt has been made to ensure the accuracy of the floorplan contained here, measurements of doors, windows, rooms and any other items are approximate and no responsibility is taken for any error, omission or mis-statement. This plan is for illustrative purposes only and should be used as such by any prospective purchaser. The services, systems and appliances shown have not been tested and no guarantee as to their operability or efficiency can be given.
Made with Metropix ©2026

First Floor

Bedroom One 13'11 plus wardrobes x 8'10 (4.24m x 2.69m)

Bedroom Two 11'10 max x 6'10 (3.60m x 2.08m)

Bathroom 8'9 x 6'2 (2.66m x 1.87m)

Outside

Front

Two off Road Parking Spaces

Rear Garden

AGENTS NOTE:

Annual Management / Service Charge - £195.00

To view this property call Pattison Lane on:
01536 524425

Selling your property?

Contact us to arrange a **FREE** home valuation.

 01536 524425

 68-70 Gold Street, Kettering, Northamptonshire, NN16 8JB

 kettering@pattisonlane.co.uk

 www.pattisonlane.co.uk



 SCAN ME



 SCAN ME



Sharman Quinney Holdings Limited is registered in England and Wales under company number 4174227, Registered Office is Cumbria House, 16-20 Hockliffe Street, Leighton Buzzard, Bedfordshire, LU7 1GN. VAT Registration Number is 500 2481 05.

1: These particulars do not constitute part or all of an offer or contract. 2: The measurements indicated are supplied for guidance only and as such must be considered incorrect. 3: Potential buyers are advised to recheck the measurements before committing to any expense. 4: Sharman Quinney has not tested any apparatus, equipment, fixtures, fittings or services and it is the buyers interests to check the working condition of any appliances. 5: Sharman Quinney has not sought to verify the legal title of the property and buyers must obtain verification from their legal representative. 6: Intending purchasers will be asked to produce identification documentation at a later stage and we would ask your co-operation in order that there will be no delay in agreeing the sale. Ref: KPL206808 - 0001

