

177 Roseden Way
Newcastle Great Park
Newcastle Upon Tyne
NE13 9DS

Offers Over
£390,000



177 Roseden Way
Newcastle Great Park
Newcastle Upon Tyne
NE13 9DS

- 4 Bed 'Westminster' Detached House
- 21' Kitchen/Dining Room with French doors
- Cloakroom/WC
- Study/Bedroom 5
- Garage Space/Storage
- Lounge with Media Wall & French Doors
- Utility and Laundry Rooms
- Master Bedroom with Balcony and En Suite Shower/WC
- Family Bathroom/WC with Shower
- South Facing Family Garden



4



2



1



C







Ground Floor
Floor area 65.9 sq.m. (709 sq.ft.)

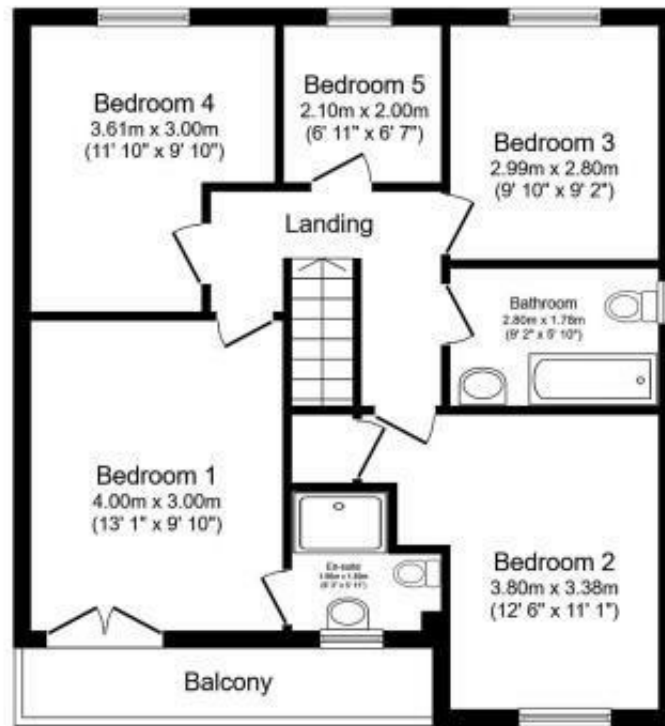

First Floor
Floor area 65.9 sq.m. (709 sq.ft.)

Total floor area: 131.7 sq.m. (1,418 sq.ft.)

This floor plan is for illustrative purposes only. It is not drawn to scale. Any measurements, floor areas (including any total floor area), openings and orientations are approximate. No details are guaranteed, they cannot be relied upon for any purpose and do not form any part of any agreement. No liability is taken for any error, omission or misstatement. A party must rely upon its own inspection(s).



EPC Rating: C
Council Tax Band: E

CONTACT

2 Middleton South, Newcastle Great Park,
Newcastle upon Tyne, NE13 9BJ

E: greatpark@goodfellowsestateagents.com
T: 0191 2848100

Whilst every care has been taken to prepare these particulars, they are for guidance purposes only. All measurements are approximate and whilst every care has been taken to ensure their accuracy, they should not be relied upon and potential buyers/tenants are advised to recheck the measurements. The agent has not tested any equipment, services, fixtures or fittings and makes no representation regarding their condition.

