

Unit 6 13 Burton Place, Manchester, Lancashire, M15 4PT

Tel: 0161 637 8336

Email: contactus@ascendproperties.com

www.ascendproperties.com

Ascend

Built on higher standards



Windrow Close, Bolton, BL3

£1,600 PCM

Welcome to Aerie a brand-new collection of 3 and 4-bedroom modern homes made for renters, right in the heart of Bolton. Set within a growing community, these new-build homes offer the perfect balance of green space, everyday convenience and easy transport links, providing everything you need to feel right at home. Led by modern, intuitive design inside and out, every home at Aerie is thoughtfully built for comfortable, connected living. Expect stylish interiors, flexible layouts that suit your lifestyle, and energy-efficient features that make your life easier and greener, from the moment you walk through the door.

Step outside and you'll find the best of Bolton at your feet. This historic former mill town is now the UK's largest town, home to a diverse and welcoming community. Whether you're after peaceful parks, great schools, everyday essentials or a short trip into Manchester, Aerie puts it all within easy reach. Looking for a place to settle in and spread out? You'll find it at Aerie.

"The Twelve77 is a spacious four-bedroom home to rent, thoughtfully designed to give you and your family plenty of room to grow.

On the ground floor, you'll find a fully open-plan layout featuring a modern kitchen with integrated appliances and a dining area at the front. A cleverly combined WC and utility room sit centrally to save space, while a large living area at the rear opens through full-height glass doors to a generous garden. Floor-to-ceiling VELFAC windows flood the home with natural light and help retain warmth throughout the year.



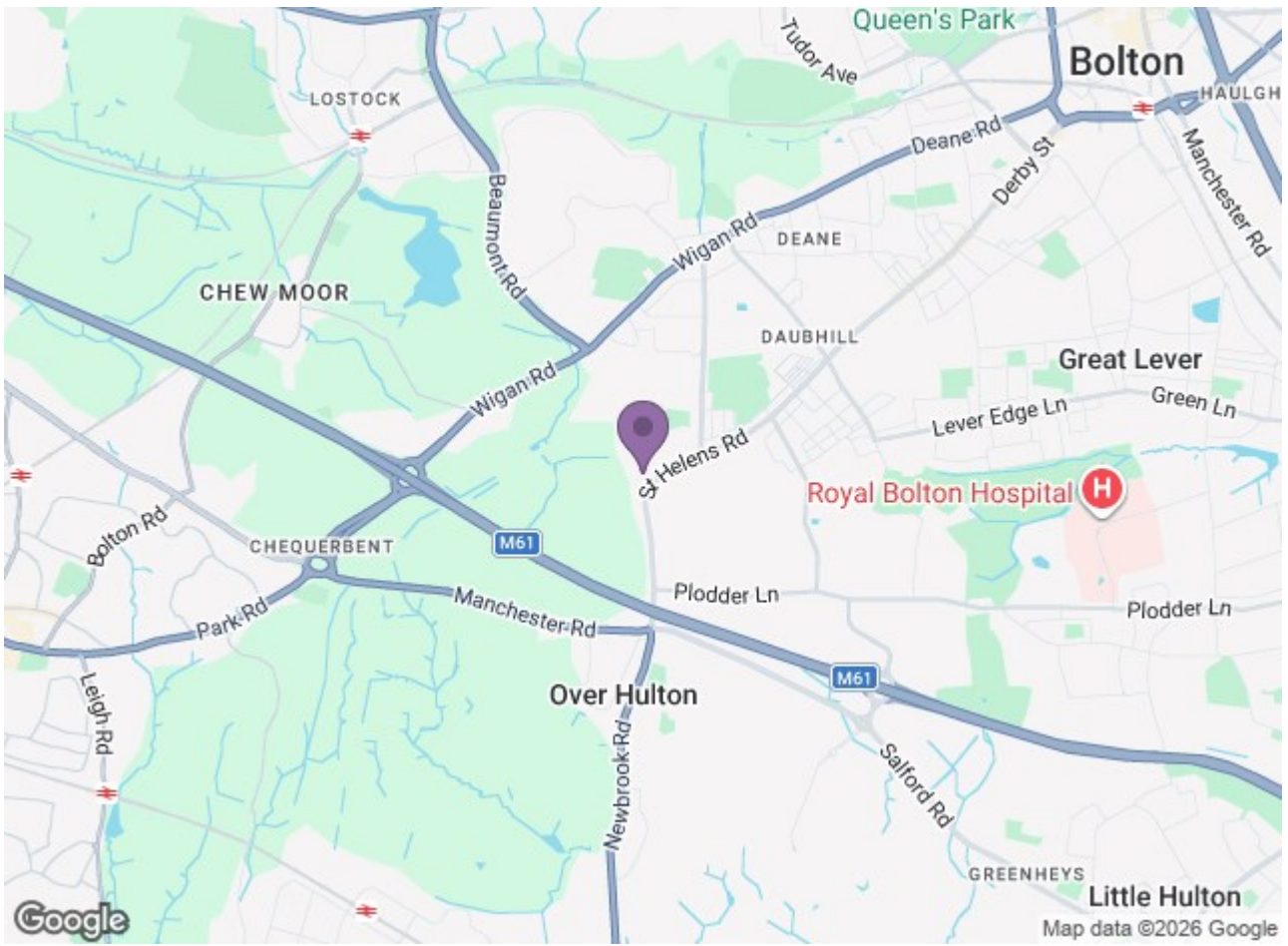
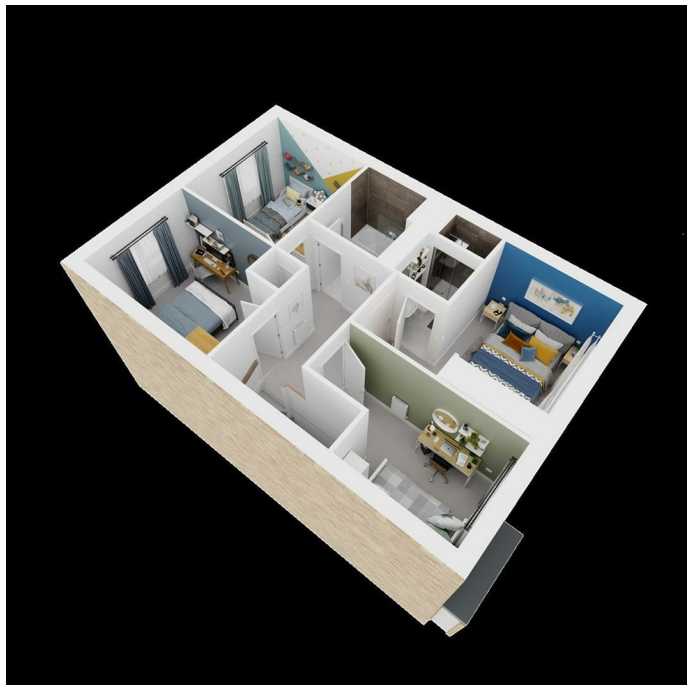

Energy Efficiency Rating		Environmental Impact (CO ₂) Rating	
Current	Potential	Current	Potential
85	93	G	G
England & Wales		England & Wales	