



YORK WAY, N7

£350,000

One double bedroom
Split-level apartment
No onward chain
Private patio
Over 600 sq ft
Long lease

@marshandparsons
marshandparsons.co.uk

MARSH &
PARSONS



ABOUT THE PROPERTY

A spacious one double bedroom split-level apartment featuring a spacious kitchen and reception room, access to a private terrace and a family bathroom. The property is presented to the market with no onward chain.

The property is well-situated, close to Caledonian Park and within easy reach of the increasingly popular King's Cross area. Local transport links include Caledonian Road station, nearby bus routes, and both Camden and Kentish Town are within a short drive.



STEP INSIDE YORK WAY

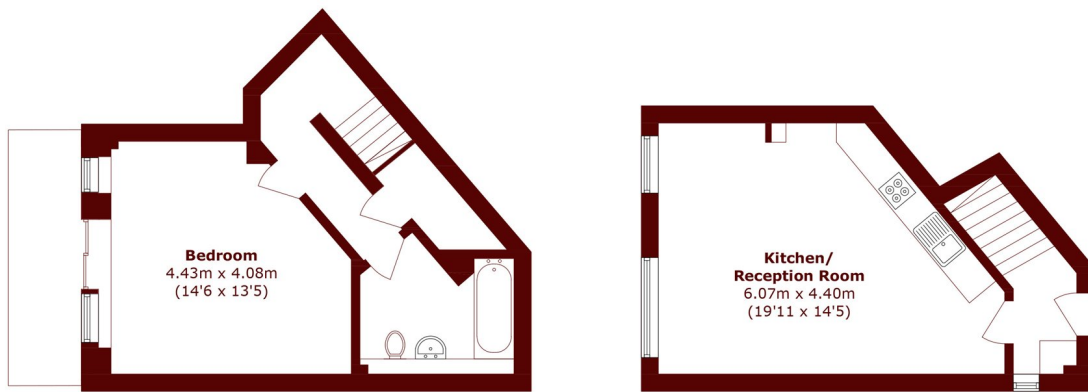

Lower Ground Floor

Ground Floor

Total area (approx.): 58.2 sq. m (626.4 sq. ft)

Camden
020 7244 2200

Energy Rating: C We aim to make our particulars both accurate and reliable. However, they are not guaranteed; nor do they form part of an offer or contract. If you require clarification on any points then please contact us, especially if you're traveling some distance to view. Please note that appliances and heating systems have not been tested and therefore no warranties can be given as to their good working order

**MARSH &
PARSONS**