



3b Hardcastle Gardens, Bolton

Offers Over £249,900

Miller Metcalfe
Every step of the way

3b Hardcastle Gardens

Bolton

Introducing this stunning 2-bedroom top floor penthouse apartment with stunning views and is located in a prime prestigious residential area. Boasting modern finishes and spacious living areas, this property offers a comfortable and stylish living space. The apartment features a well-equipped kitchen with fitted appliances, a bright and airy living room, two double bedrooms, and a shower room. The property also benefits from secure underground parking, providing convenience for residents. Situated in a sought-after neighbourhood, residents will enjoy easy access to local amenities, shops, restaurants, and excellent transport links. This apartment is ideal for anyone looking for a contemporary living space in a desirable location. Don't miss the opportunity to make this apartment your new home. Contact us today to arrange a viewing and secure this fantastic property.

Council Tax band: E

Tenure: Leasehold

EPC Energy Efficiency Rating: C

EPC Environmental Impact Rating:





GROUND FLOOR
904 sq.ft. (84.0 sq.m.) approx.

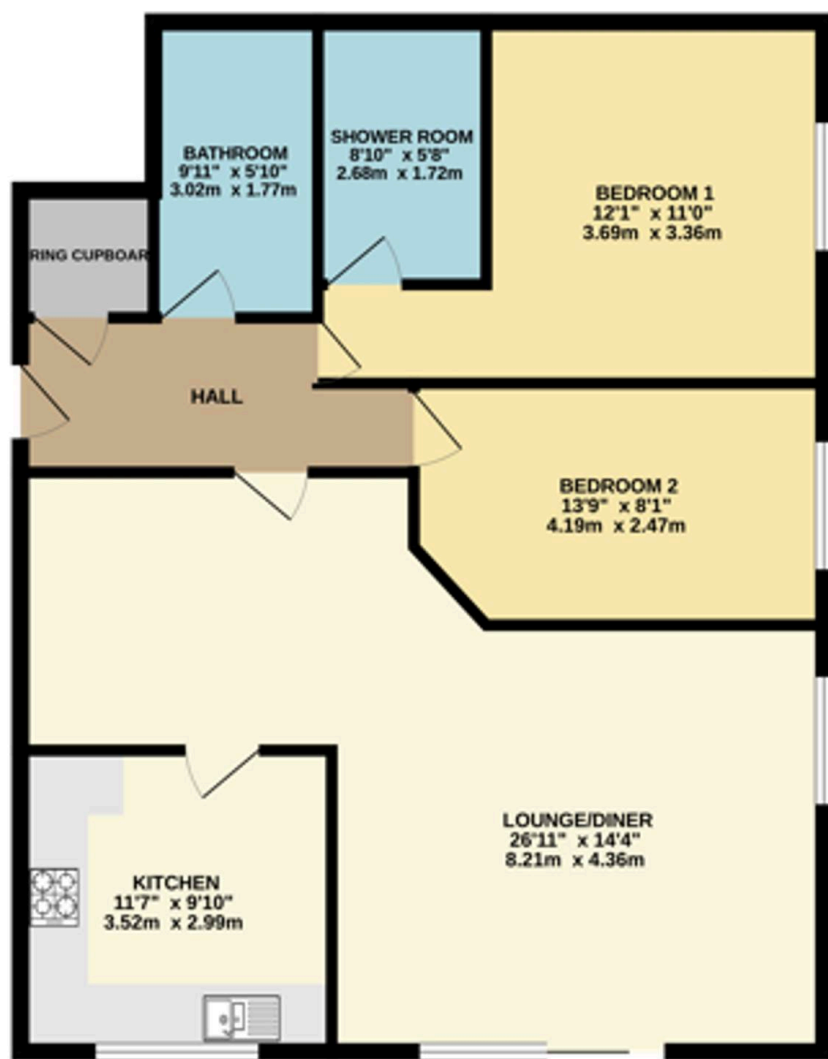

TOTAL FLOOR AREA: 904 sq.ft. (84.0 sq.m.) approx.

Whilst every attempt has been made to ensure the accuracy of the description contained here, measurements of doors, windows, rooms and any other items are approximate and no responsibility is taken for any error, omission or mis-statement. This plan is for illustrative purposes only and should be used as such by any prospective purchaser. The services, systems and appliances shown have not been tested and no guarantee as to their operability or efficiency can be given.
Made with Netragon C2025



Miller Metcalfe Harwood

Miller Metcalfe Sales & Lettings, 87A Lea Gate - BL2 4BQ

01204 308000 • harwood@millermetcalfe.co.uk • millermetcalfe.co.uk/

Miller Metcalfe
Every step of the way