





Norris Road, Hillsborough, Sheffield, S6 4QR

Offers In Region Of £210,000

3  1  1 



A well-presented three bedroom mid terrace property situated in this popular part of Hillsborough, offering well-proportioned accommodation over three levels and ideal for a range of buyers including first time buyers and investors alike.

The ground floor comprises a comfortable living room to the front aspect, with a kitchen/diner to the rear providing a practical and sociable space. To the first floor are two good-sized bedrooms along with a family bathroom, while the second floor hosts a further double bedroom, creating a versatile layout suited to modern living.

Externally, the property benefits from a low maintenance rear garden, with on street parking available to the front.

Located close to a range of local amenities, transport links and well-regarded schools, this is a well-positioned home in a convenient and popular residential area.

A great opportunity for those looking to step onto the ladder or add to a portfolio.



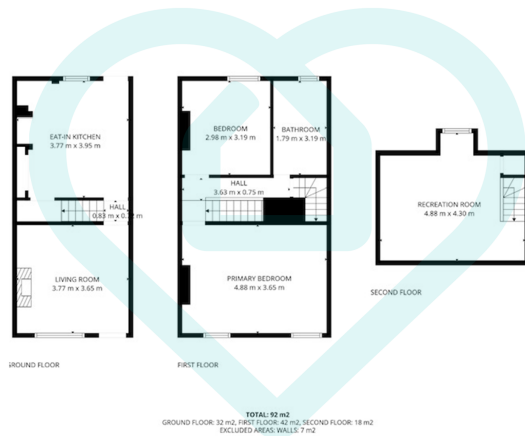

This floor plan is for illustrative purposes only. All measurements and layouts are approximations and do not necessarily capture the precise specifications of the property. No responsibility is taken for any error, omission, or misstatement. We always recommend viewing in person to confirm the exact floor plan of a property. Made with Metropix.



- Three bedroom mid terrace property
- Spacious living room to the front aspect
- Two well-proportioned bedrooms to the first floor
- Popular Hillsborough location
- On street parking available
- Ideal for first time buyers or investors
- Kitchen/diner to the rear providing a practical layout
- Family bathroom with a straightforward layout
- Low maintenance rear garden space
- Located close to well-regarded local schools, making it a great option for families

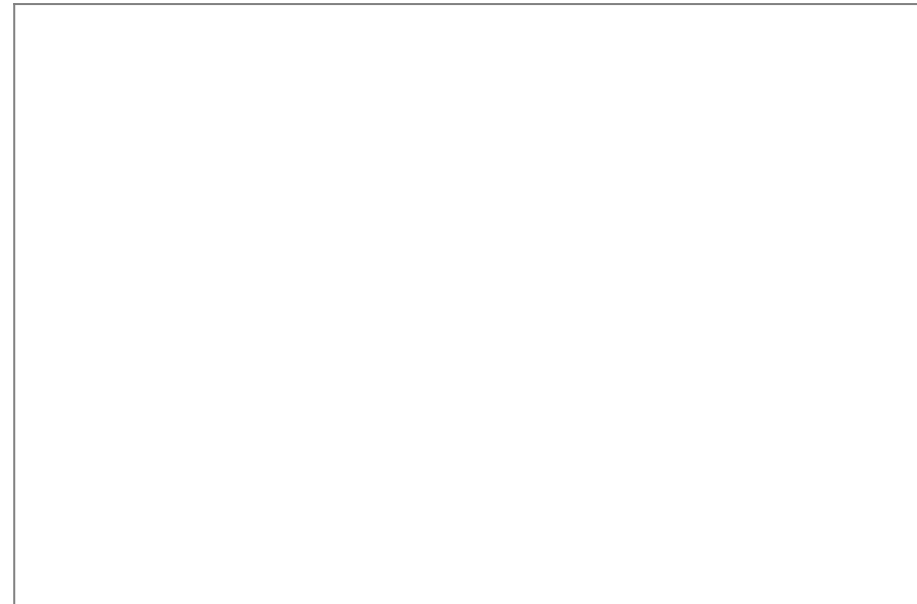

Sales | Lettings | New Homes

VAT Reg Number: 191 3588 84
 Company Reg Number: 08610489
 Company Reg Address: 67 Middlewood Road, Hillsborough, Sheffield, S6 4GX.

The MorfittSmith Building
 67 Middlewood Road
 Hillsborough
 Sheffield
 S6 4GX

Get in touch - arrange an appointment



0114 232 1764
 sales@morfittsmith.co.uk
 lettings@morfittsmith.co.uk
 newhomes@morfittsmith.co.uk
 www.morfittsmith.co.uk



@MorfittSmith
 @MorfittSmith
 MorfittSmith
 Estate & Letting Agent