



## Cairnfield Avenue, NW2 £325,000

This two double bedroom, top floor apartment measures in excess of 670 sq ft. This bright and spacious property offers a good sized reception dining area, separate modern fitted kitchen and bathroom. The property comes with a long lease and no onward chain.

Cairnfield Avenue is situated just moments from an array of amenities and the popular 86 acre Gladstone Park. The North Circular (A406) is located nearby, connecting to the M1 motorway and the A41, offering easy access in and out of London.

### Features

- Top Floor
- Two Double Bedrooms
- Reception Room
- Modern Fitted Kitchen
- Leasehold
- No Onward Chain

Cairnfield Avenue,  
London, NW2

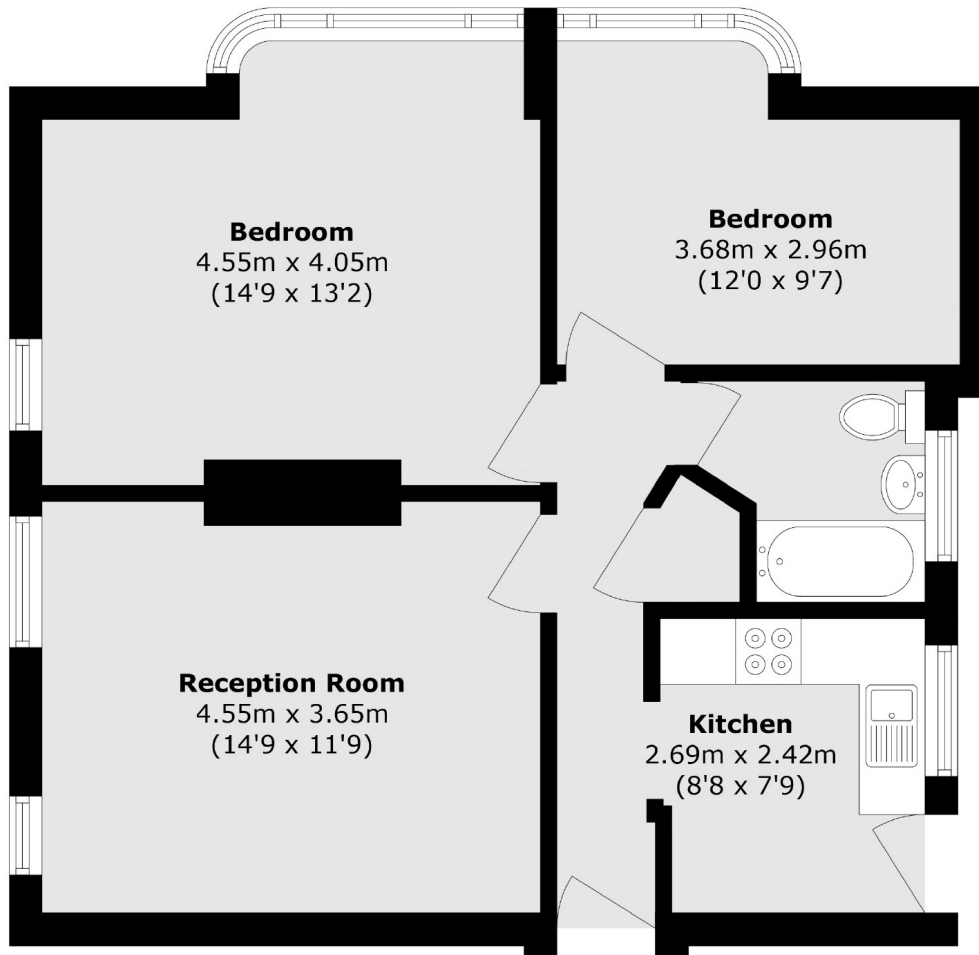

Total area (approx.): 62.5 sq. m (672.7 sq. ft)