



- Two bedroom apartment
- First floor
- No onward chain
- Share of freehold

6a Murray Road, Northwood, Middlesex, HA6 2YJ

Guide Price £369,950

Offered to the market with no onward chain. A well-presented two-bedroom first floor apartment located in the heart of Northwood. This appealing property is offered with the benefit of a brand new 999 year lease, garage, and off-street parking. An ideal opportunity for first-time buyers or investors, the apartment provides comfortable living in a highly sought-after location. With convenient access to local amenities, transport links, and green spaces, it combines practicality with lifestyle appeal. Early internal viewing is highly recommended to avoid disappointment.



Property Description

PROPERTY

Perfectly positioned in the heart of Northwood, this stylish two-bedroom first floor apartment offers modern interiors and a superbly convenient location-ideal for first-time buyers, downsizers, or investors alike.

Entering the property at ground level, stairs rise to a bright and welcoming first-floor landing providing access to all rooms. To the right, you'll find a well-designed 12ft kitchen/reception room, featuring a sleek fitted kitchen with an excellent range of storage units, ample worktop space, and a selection of high-quality integrated appliances-perfectly suited for modern living. The apartment is completed by two generously sized bedrooms, both offering built-in storage, along with a contemporary family bathroom. This well-appointed home combines comfort, style, and convenience, all within close proximity to local amenities and transport links.

LOCATION

Murray Road is a prestigious and highly sought-after residential address, ideally situated within walking distance of Northwood High Street. Residents enjoy convenient access to a wide range of amenities, including a Waitrose supermarket, a variety of restaurants and bars, and the Metropolitan Line Station, offering direct connections to Baker Street, the City, as well as Harrow-on-the-Hill, Watford, and Rickmansworth. The area is well-served by a selection of excellent schools, both in the private and state sectors, making it especially attractive to families. For motorists, the M25 and M1 motorways are easily accessible, providing fast links to central London and beyond.

OUTSIDE

At the front of the house, there is a large gravel driveway offering shared off-street parking for two vehicles."

DETAILS OF SALE

Tenure: Share of Freehold

Lease: 999 years remaining on the lease.

The vendor pays £60 a month into a community fund which covers things like gardening, communal electricity, and other shared costs.





Murray Road

Approximate Gross Internal Floor Area = 64.20 sq m / 691 sq ft

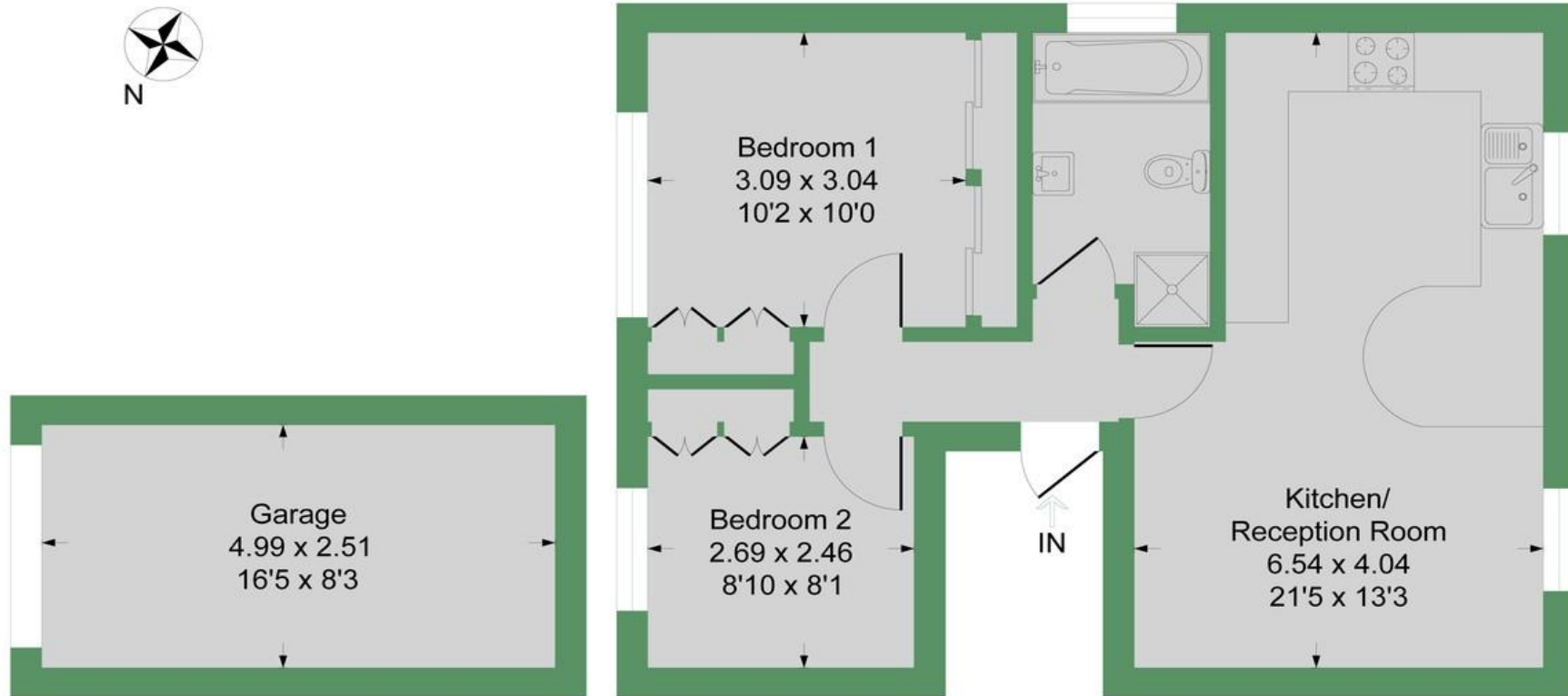

Garage
Approximate Floor Area
135.00 sq.ft
(12.50 sq.m)

Ground Floor
Approximate Floor Area
556.00 sq.ft
(51.70 sq.m)



Illustration for identification purposes only, measurements are approximate, not to scale.

Hillingdon office
11 Crescent Parade
Hillingdon
UB10 OLG

Uxbridge office
41 Belmont Road
Uxbridge
UB8 1QT

Hillingdon office 01895 231311
Uxbridge office 01895 707777
info@andrewsresidential.co.uk
www.andrewsresidential.co.uk

Agents Note: Whilst every care has been taken to prepare these sales particulars, they are for guidance purposes only. All measurements are approximate and for general guidance purposes only and whilst every care has been taken to ensure their accuracy, they should not be relied upon and potential buyers are advised to recheck the measurements.