



Bittern Close, Necton, Swaffham, PE37 8NP

AVAILABLE CHAIN FREE!

Well presented, detached three bedroom bungalow situated in a cul-de-sac location within the popular well serviced village of Necton. The property offers well presented gardens, garage, parking, en-suite, conservatory, GCH and UPVC double glazing.

Guide Price £270,000 - £280,000 Freehold

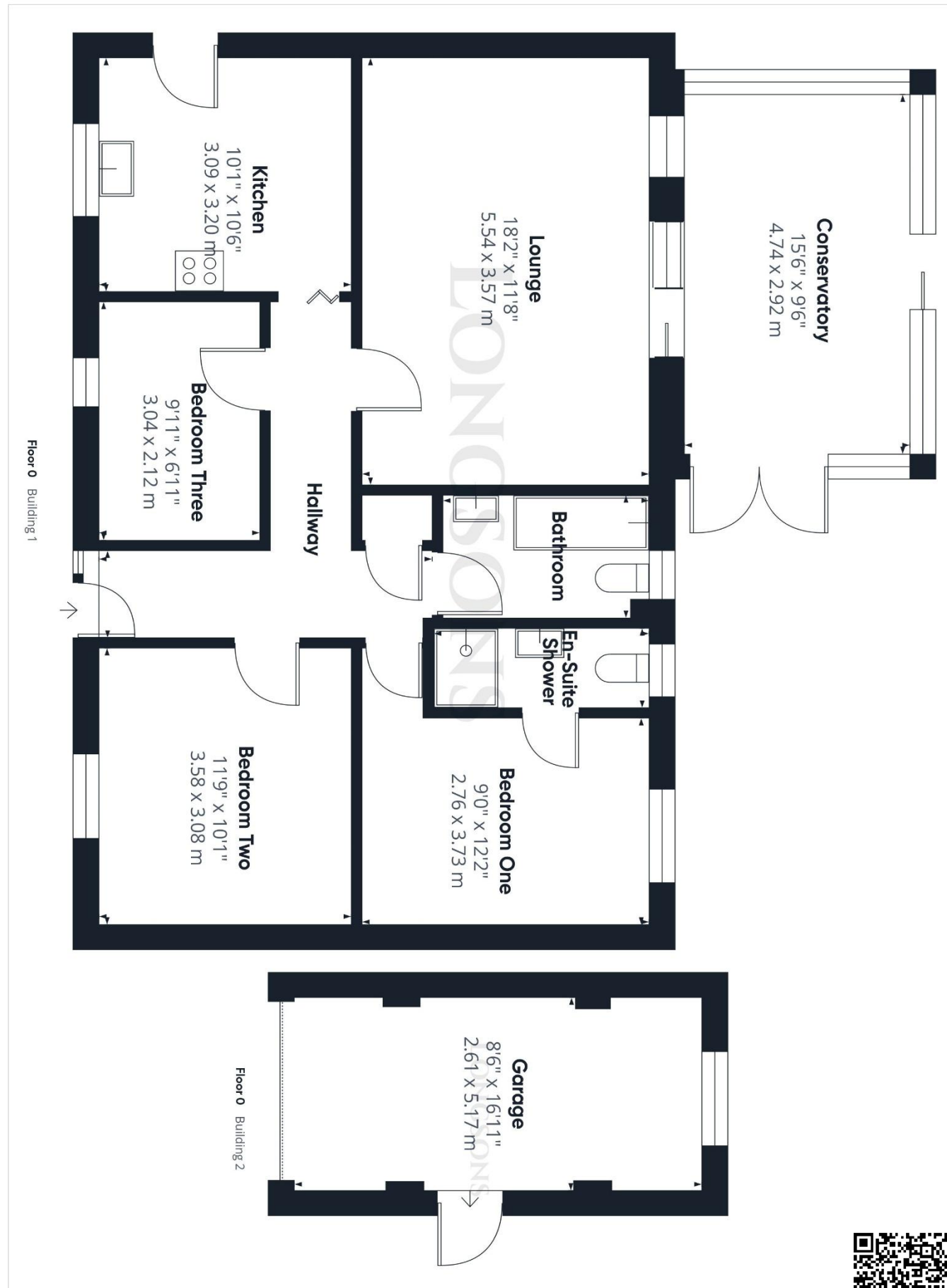



splashback, obscure glass UPVC double glazed window to rear.

Garage
16'11" (5.16m) x 8'6" (2.59m)

Motorised main roller door to front, personnel door opening to rear garden, window to rear, electric power and lights.

Outside Front

Front garden laid to lawn, path to front door, area laid to shingle, driveway providing off-road parking, outside lights, gated access to rear garden.

Rear Garden

Enclosed rear garden laid to lawn, selection of established shrubs, trees and plants to beds and borders, covered paved patio seating area, two wooden garden sheds, garden pond, outside lights, outside tap, wooden fence to perimeter, gated access to front.

Agent's Note

EPC rating B81 (Full copy available on request)
 Council tax band C (Own enquiries should be made via Breckland District Council)

- Detached Three Bedroom Bungalow
- Well Presented
- Popular Village Location
- Energy Efficiency Rating B81
- Conservatory
- Garage, Gardens and Parking
- Gas Central Heating and UPVC Double Glazing
- En-Suite Shower Room and Family Bathroom
- Available Chain Free!

Please note we have not tested any apparatus, fixtures, fittings, or services. Interested parties must undertake their own investigation into the working order of these items. All measurements are approximate and photographs provided for guidance only.

Situated in a cul-de-sac location within the popular well serviced village of Necton, Longsons are delighted to bring to the market this well presented detached three bedroom bungalow. The property offers garage, parking, en-suite shower room, well presented gardens, leased solar panels, gas central heating, conservatory and UPVC double glazing.

Available CHAIN FREE!

Briefly, the property offers entrance hall, lounge, conservatory, kitchen, three bedrooms with en-suite shower room to bedroom one, bathroom, garage, gardens, parking, leased solar panels, gas central heating and UPVC double glazing.

NECTON

The popular Norfolk village of Necton is well serviced with amenities including shop, post office, doctors surgery, butchers, local pub, social club, excellent primary school and activity park for the children. The village is situated between Kings Lynn and Norwich, just a short drive away from the historic market town of Swaffham.

Entrance Hall

UPVC double glazed entrance door to front, built-in cupboard housing hot water cylinder, radiator, loft access.

Lounge

18'2" (5.54m) x 11'8" (3.56m)

Feature fireplace currently not in use, double glazed sliding patio doors opening to conservatory, UPVC double glazed window to rear, radiator.

Conservatory

15'6" (4.72m) x 9'6" (2.9m)

Modern UPVC double glazed conservatory, entrance door opening to rear garden, radiator providing year round usage, electric power and lights.

Kitchen

10'6" (3.2m) x 10'1" (3.07m)

Fitted kitchen units to walls and floor, work surface over, stainless steel sink unit with mixer tap and drainer, space and plumbing for washing machine and dishwasher, space for electric cooker with extractor hood over, space for under counter fridge and freezer, UPVC double glazed entrance door

opening to side, UPVC double glazed window to front, tiled splashback.

Bedroom One

12'2" (3.71m) x 9'0" (2.74m)

UPVC double glazed window to rear, radiator, door to en-suite shower room.

En-suite Shower Room

Shower cubicle, hand wash basin set within fitted cabinet, WC, towel radiator, tiled splashback, obscure glass UPVC double glazed window to rear, extractor fan.

Bedroom Two

11'9" (3.58m) x 10'1" (3.07m)

UPVC double glazed window to front, radiator.

Bedroom Three

9'11" (3.02m) x 6'11" (2.11m)

UPVC double glazed window to front, radiator.

Bathroom

Suite comprising bath with mixer shower over and shower screen, hand wash basin, WC, radiator, tiled

