



Osiers Road, Wandsworth, SW18

Guide Price £550,000 - £625,000

2 2 1



PLEASE SELECT 3 FOR JONATHAN ON CALLING - GUIDE PRICE £550K - £625K – Stunning two double bedroom second floor apartment (751 Sq.Ft) with two private balconies and access to landscaped communal gardens, superbly located in the Riverside Quarter between Putney and Wandsworth Town. With the River Thames and Wandsworth Park literally on the doorstep, this fabulous property offers bright, well planned accommodation with stylish interiors and contemporary finish throughout. Features include a generous open plan dual aspect reception/kitchen, modern bathroom, gas central heating, double glazing, high ceilings and wood effect flooring.

Jonathan Woods
jonathanwoods.exp.uk.com
jw@jonathanwoodsrealestate.com
07498 214 463



Key Features

- PLEASE SELECT 3 FOR JONATHAN ON CALLING
- POPULAR MODERN DEVELOPMENT
- CONTEMPORARY FINISH
- 2 BALCONIES
- STUNNING 2 BED, 2 BATH, 2ND FLOOR APARTMENT
- SOUGHT AFTER RIVERSIDE QUARTER LOCATION
- LIGHT AND SPACIOUS OPEN PLAN RECEPTION/KITCHEN
- LANDSCAPED COMMUNAL GARDENS
- MOMENTS FROM WANDSWORTH TOWN AND EAST PUTNEY STATIONS CLOSE TO SHOPS, BARS AND RESTAURANTS

Osiers Road

Approximate Gross Internal Area = 69.8 sq m / 751 sq ft
Including Limited Use Area (0.9 sq m / 10 sq ft)

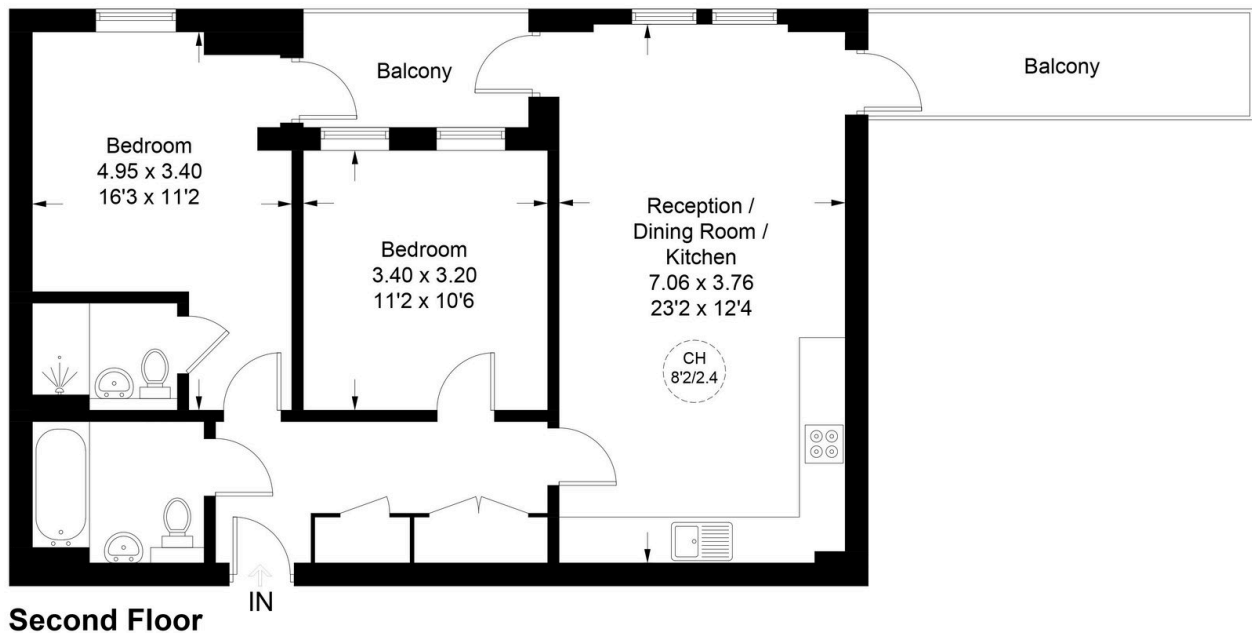

Illustration for identification purposes only, not for valuation purposes, measurements are approximate, not to scale. IPMS2