



**Connells**

Orchard Bank  
Chart Sutton Maidstone



### Property Description

Located within the desirable and semi-rural setting of Chart Sutton, this well-presented home offers an excellent opportunity to enjoy countryside living whilst remaining conveniently close to Maidstone.

The ground floor accommodation is both practical and inviting. It features a bright and spacious living room, perfect for everyday living and entertaining. At the rear, the kitchen is well designed, offering ample storage and workspace, including a large pantry. The living room provides direct access to the rear garden, making it ideal for indoor/outdoor living.

Upstairs, the property features spacious bedrooms, perfect for families, guests, or those working from home. Each bedroom offers a pleasant outlook.

The rear garden offers a spacious, private, and low-maintenance outdoor area, perfect for relaxation or entertaining. Additionally, there is a vegetable patch and a large greenhouse for growing your own produce.

Chart Sutton is a well-regarded village that offers a tranquil lifestyle, surrounded by open countryside. Despite its peaceful setting, it is conveniently located within easy reach of Maidstone town centre, which boasts a variety of shopping, dining, and leisure facilities. The area is also served by reputable schools and good transport links, including mainline stations with services to London.











**Ground Floor**

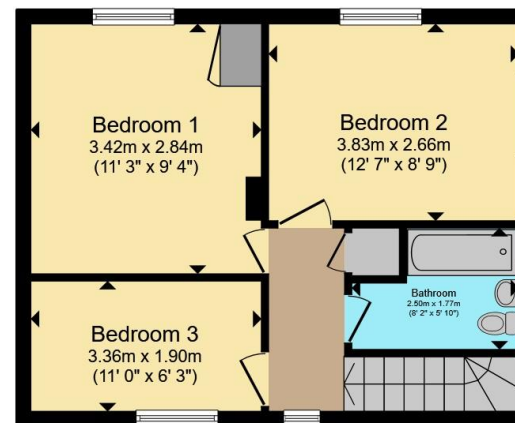

**First Floor**

Total floor area 93.7 m<sup>2</sup> (1,008 sq.ft.) approx

This floor plan is for illustrative purposes only. It is not drawn to scale. Any measurements, floor areas (including any total floor area), openings and orientation are approximate. No details are guaranteed, they cannot be relied upon for any purpose and they do not form part of any agreement. No liability is taken for any error, omission or misstatement. A party must rely upon its own inspection(s). Powered by [www.propertybox.io](http://www.propertybox.io)



To view this property please contact Connells on

**T 01622 751034**

**E [maidstone@connells.co.uk](mailto:maidstone@connells.co.uk)**

30 King Street  
MAIDSTONE ME14 1BS

EPC Rating: C Council Tax  
Band: C

Tenure: Freehold

**view this property online [connells.co.uk/Property/MAI408513](http://connells.co.uk/Property/MAI408513)**



1. MONEY LAUNDERING REGULATIONS Intending purchasers will be asked to produce identification documentation at a later stage and we would ask for your co-operation in order that there will be no delay in agreeing the sale. 2. These particulars do not constitute part or all of an offer or contract. 3. The measurements indicated are supplied for guidance only and as such must be considered incorrect. Potential buyers are advised to recheck measurements before committing to any expense. 4. We have not tested any apparatus, equipment, fixtures, fittings or services and it is in the buyers interest to check the working condition of any appliances.

Connells Residential is registered in England and Wales under company number 1489613, Registered Office is Cumbria House, 16-20 Hockliffe Street, Leighton Buzzard, Bedfordshire, LU7 1GN. VAT Registration Number is 500 2481 05.

**See all our properties at [www.connells.co.uk](http://www.connells.co.uk) | [www.rightmove.co.uk](http://www.rightmove.co.uk) | [www.zoopla.co.uk](http://www.zoopla.co.uk)**

Property Ref: MAI408513 - 0004