



19 Holme Lane, Scunthorpe, DN16 3RP

£449,950

On one of our areas most sought after streets, the tree lined Holme Lane in Bottesford. This is an incredibly unique home with an elevated position and sweeping driveway behind secure gates, with the house itself mostly spread across one level, it's incredibly flexible with up to five or even six bedrooms, but most likely a very comfortable three/four bed with multiple reception rooms, perfect for modern family life.

The front door is up the steps from the drive and the central entrance hall gives access to the spacious lounge overlooking the drive and street, the contemporary open plan living kitchen diner and the central hall where you will find the bedroom, family bathroom and office spaces. There's also a stairwell leading to the garage and extra snug/bedroom/games room with its own bathroom.

Outside, there are gardens to all sides with multiple private seating areas so you can chase the sun around and the drive with the double garage gives parking for plenty of cars.

Viewings are strictly by appointment, please contact us to book.

Entrance



En Suite 11'5" x 5'10" (3.50m x 1.79m)



Lounge 20'1" x 16'2" (6.13m x 4.94m)



Bedroom two 11'10" x 11'10" (3.62m x 3.62m)



Kitchen/Diner 23'11" x 15'9" (7.29m x 4.82m)



Hall 15'8" x 12'0" (4.80m x 3.67m)

Bedroom one 11'10" x 11'5" (3.62m x 3.50m)



Bedroom three 12'0" x 10'0" (3.67m x 3.06m)



Dressing Room 6'2" x 6'0" (1.88m x 1.83m)



Bedroom four 13'6" x 8'1" (4.12m x 2.48m)



En Suite 7'10" x 7'10" (2.41m x 2.41m)



Office/bedroom six 8'2" x 7'10" (2.50m x 2.41m)



Bedroom five 18'5" x 13'5" (5.63m x 4.11m)



Bathroom 8'7" x 8'2" (2.62m x 2.50m)



Outside front



Outside rear



Garage 18'5" x 15'5" (5.63m x 4.71m)

Floor Plan

GROUND FLOOR
1706 sq.ft. (158.5 sq.m.) approx.

BASEMENT
563 sq.ft. (52.3 sq.m.) approx.

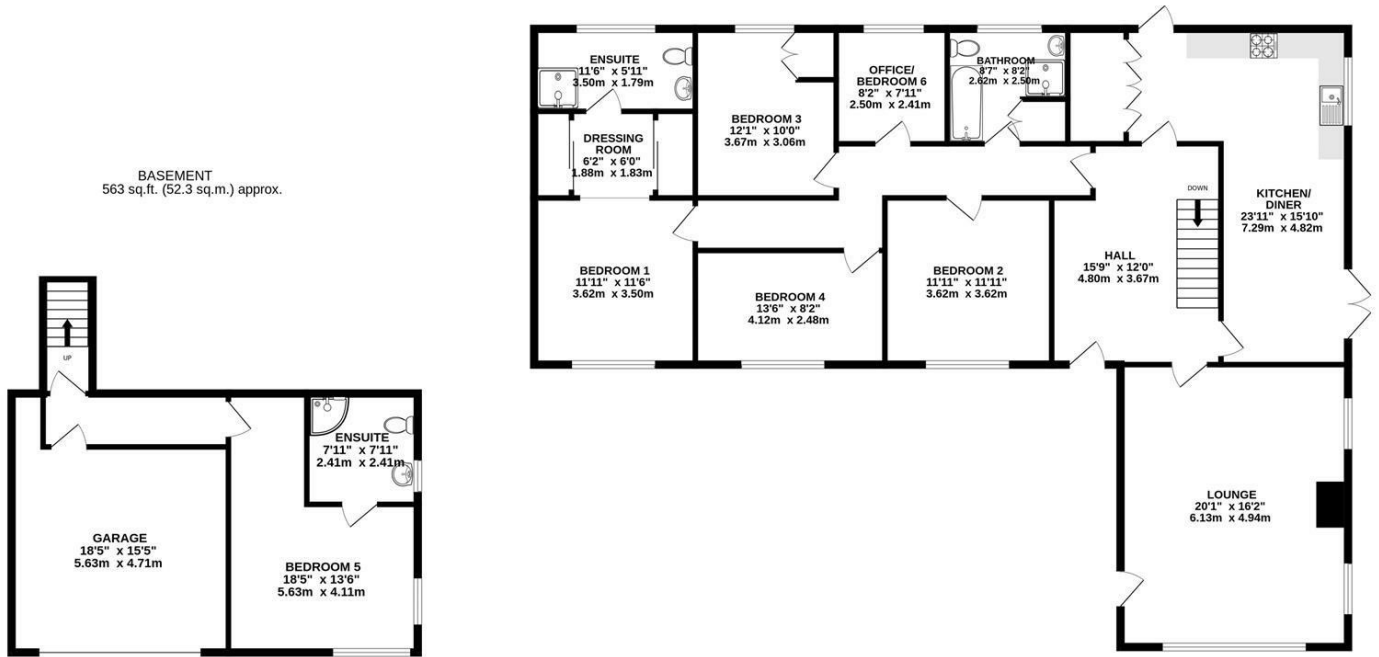

TOTAL FLOOR AREA : 2269 sq.ft. (210.8 sq.m.) approx.

Whilst every attempt has been made to ensure the accuracy of the floorplan contained here, measurements of doors, windows, rooms and any other items are approximate and no responsibility is taken for any error, omission or mis-statement. This plan is for illustrative purposes only and should be used as such by any prospective purchaser. The services, systems and appliances shown have not been tested and no guarantee as to their operability or efficiency can be given.
Made with Metropix ©2026



Area Map



Energy Efficiency Graph

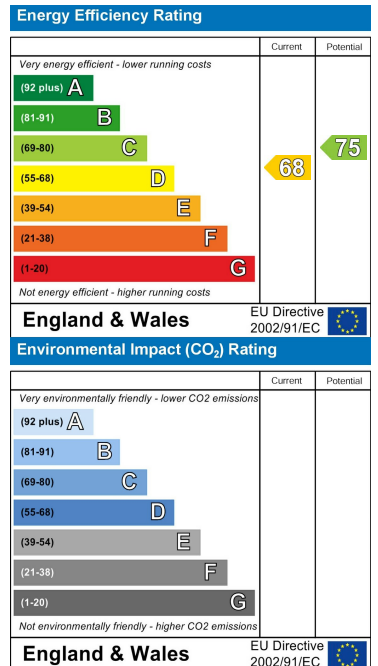

These particulars, whilst believed to be accurate are set out as a general outline only for guidance and do not constitute any part of an offer or contract. Intending purchasers should not rely on them as statements of representation of fact, but must satisfy themselves by inspection or otherwise as to their accuracy. No person in this firm's employment has the authority to make or give any representation or warranty in respect of the property.

Cade Estate Agency Ltd Company No. 11153015

52A Northfield Road, Messingham, North Lincolnshire. DN17 3SA

T: 01724 372 011 E: info@cade.co.uk W: cade.co.uk