



Orchard Rise
, Newnham, GL14 1AJ
£100,000

36 Orchard Rise, Newnham, GL14 1AJ

A well-proportioned one bedroom ground floor flat, ideal for first-time buyers or investors. Offering comfortable and low-maintenance living, the property benefits from an open plan living/kitchen space, a double bedroom and allocated parking.

The property is being sold with no onward chain, making it a fantastic opportunity for a straightforward purchase.

The surrounding area of Newnham is known for its picturesque scenery and community spirit, making it an ideal place to settle down. With local amenities and transport links within easy reach, this property offers both tranquility and accessibility.



Entrance Hallway:
2'7 x 8'10 (0.79m x 2.69m)

Lounge / Diner / Kitchen:
15'6 x 12'4 (4.72m x 3.76m)

Bedroom One:
8'0 x 10'1 (2.44m x 3.07m)

Bathroom:
5'6 x 6'3 (1.68m x 1.91m)

Outside:

Agents Note:



Area Map

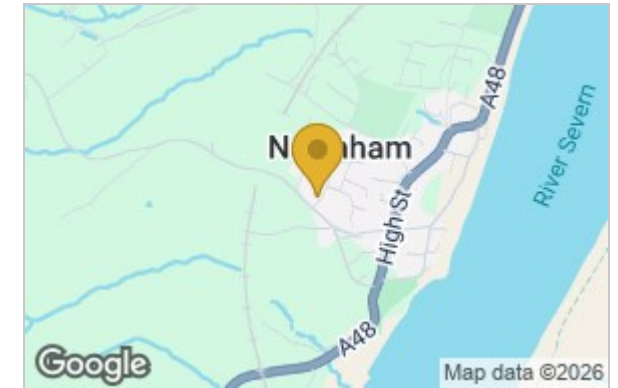

Floor Plan

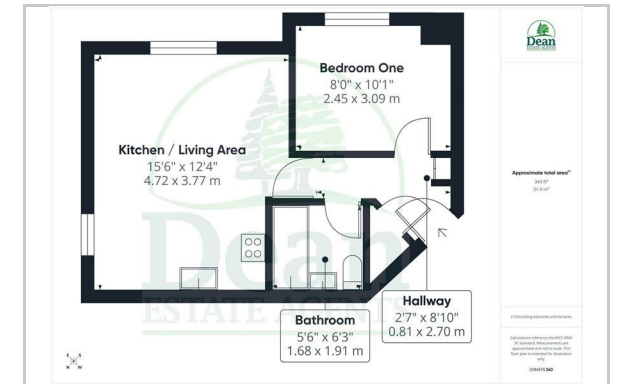

Energy Efficiency Graph

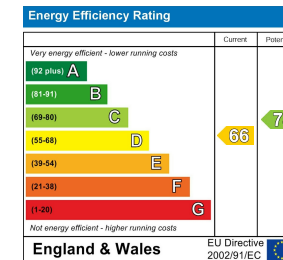

These particulars, whilst believed to be accurate are set out as a general outline only for guidance and do not constitute any part of an offer or contract. Intending purchasers should not rely on them as statements of representation of fact, but must satisfy themselves by inspection or otherwise as to their accuracy. No person in this firm's employment has the authority to make or give any representation or warranty in respect of the property.