

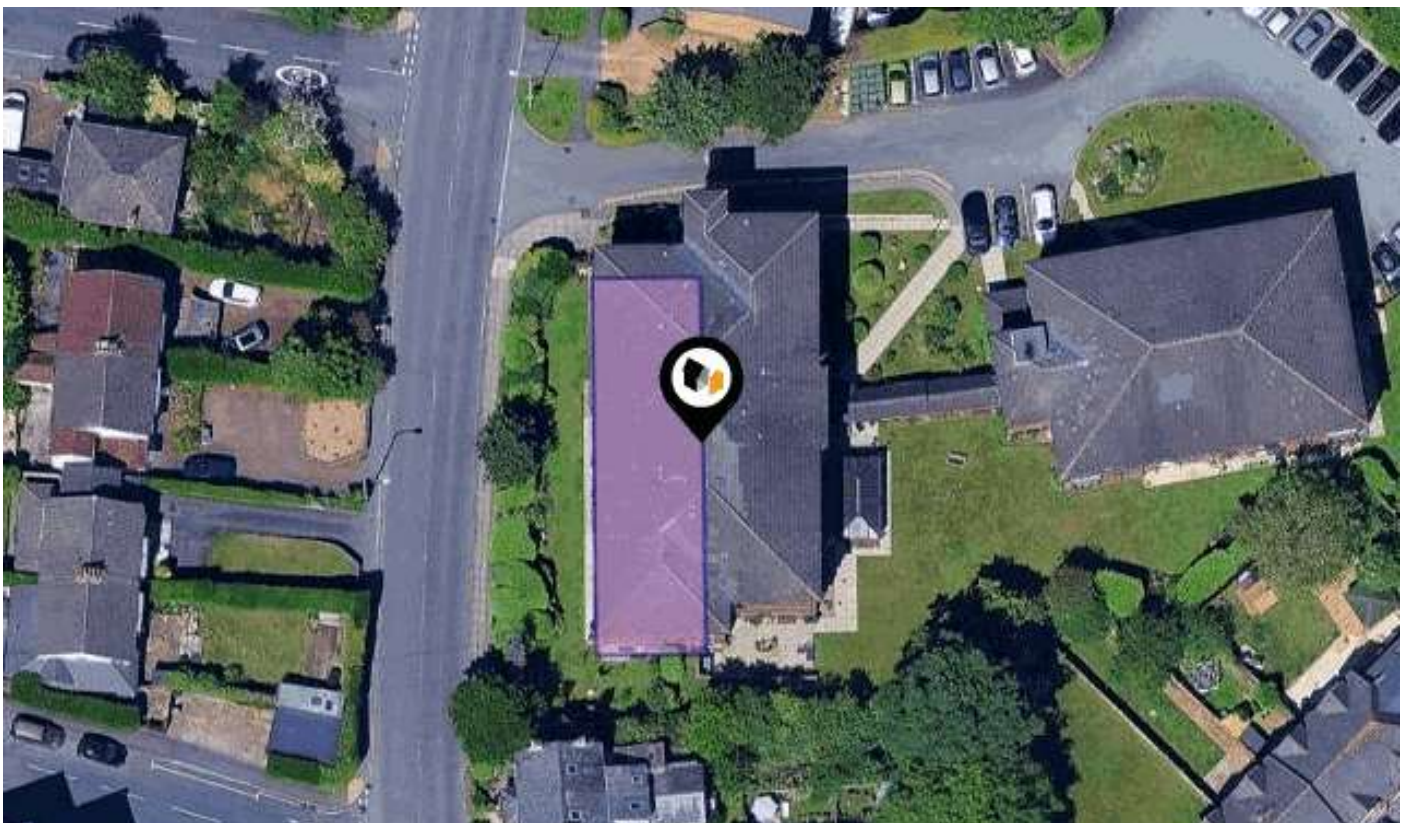

KPF: Key Property Facts

An Analysis of This Property & The Local Area
Wednesday 22nd April 2026



14, HESSLEWELL COURT, WIRRAL, CH60 7TW

Landwood Group

77 Deansgate Manchester M3 2BW

0161 710 2010

Emma.judge@landwoodgroup.com

<https://landwoodgroup.com/>





Property

Type:	Sheltered Accommodation	Last Sold Date:	30/07/2004
Bedrooms:	1	Last Sold Price:	£72,500
Floor Area:	419 ft ² / 39 m ²	Last Sold £/ft²:	£172
Plot Area:	0.07 acres	Tenure:	Leasehold
Year Built :	1983-1990		
Council Tax :	Band B		
Annual Estimate:	£1,945		
Title Number:	MS278511		
UPRN:	42154354		
Restrictive Covenants:	No		

Local Area

Local Authority:	Wirral
Conservation Area:	No
Flood Risk:	
● Rivers & Seas	Very low
● Surface Water	Low

Estimated Broadband Speeds (Standard - Superfast - Ultrafast)

17 mb/s	59 mb/s	1800 mb/s

Mobile Coverage: (based on calls indoors)

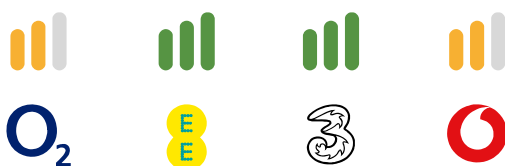

Satellite/Fibre TV Availability:



Property Multiple Title Plans

LANDWOOD
GROUP

Freehold Title Plan

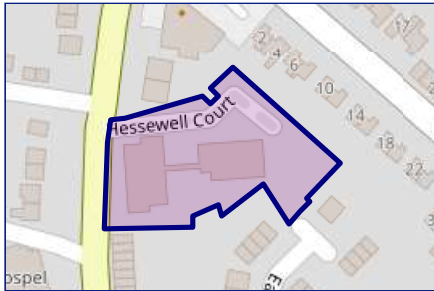

MS195590

Leasehold Title Plan



MS278511

Start Date: 25/08/1988
End Date: 01/12/2984
Lease Term: 999 years from 1 December 1985
Term Remaining: 959 years

14, HESSLEWELL COURT, WIRRAL, CH60 7TW

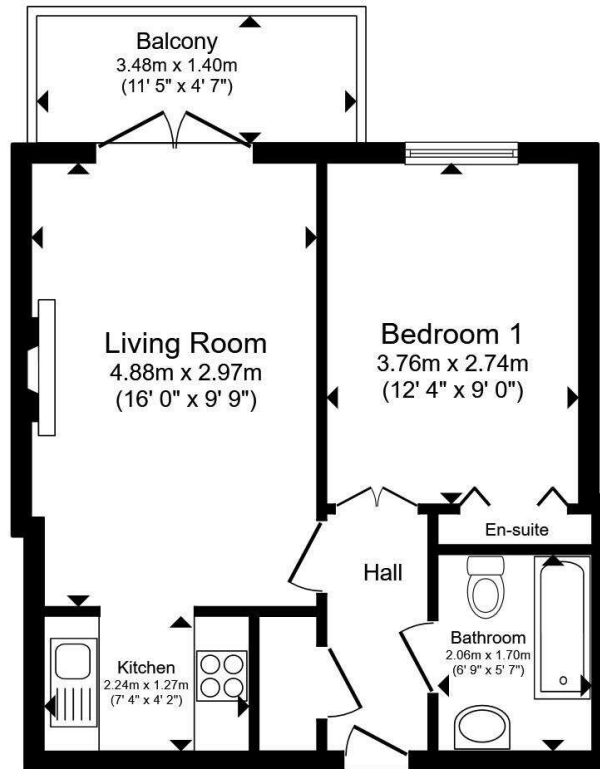

Total floor area 38.2 m² (411 sq.ft.) approx

This floor plan is for illustrative purposes only. It is not drawn to scale. Any measurements, floor areas (including any total floor area), openings and orientation are approximate. No details are guaranteed, they cannot be relied upon for any purpose and they do not form part of any agreement. No liability is taken for any error, omission or misstatement. A party must rely upon its own inspection(s). Powered by www.propertybox.io

Property EPC - Certificate

LANDWOOD
GROUP

14, Hesslewell Court, CH60 7TW

Energy rating

B

Valid until 12.11.2027

Score	Energy rating	Current	Potential
92+	A		
81-91	B	83 B	84 B
69-80	C		
55-68	D		
39-54	E		
21-38	F		
1-20	G		

Property

EPC - Additional Data

LANDWOOD
GROUP

Additional EPC Data

Property Type:	Flat
Build Form:	Enclosed Mid-Terrace
Transaction Type:	Rental (private)
Energy Tariff:	Dual
Main Fuel:	Electricity (not community)
Main Gas:	No
Floor Level:	1st
Flat Top Storey:	No
Top Storey:	0
Glazing Type:	Double glazing, unknown install date
Previous Extension:	0
Open Fireplace:	0
Ventilation:	Natural
Walls:	Cavity wall, as built, insulated (assumed)
Walls Energy:	Good
Roof:	(another dwelling above)
Main Heating:	Electric storage heaters
Main Heating Controls:	Automatic charge control
Hot Water System:	Electric immersion, off-peak
Hot Water Energy Efficiency:	Average
Lighting:	Low energy lighting in 29% of fixed outlets
Floors:	(another dwelling below)
Total Floor Area:	39 m ²

This map displays nearby coal mine entrances and their classifications.



Mine Entry

- ✕ Adit
- ✕ Gutter Pit
- ✕ Shaft

The Coal Authority has records of over 175,000 mine entries within the UK captured in the National Coal Mining database, derived from sources including abandonment plans, geological and topographical plans.

Coal mining activity is recorded as far back as the 13th century, but prior to 1872 there was no requirement to deposit abandonment plans. It is therefore believed there may be many unrecorded mine entries of which the Authority has no information or knowledge. These entries do not, therefore, appear within the Authority's national dataset as shown on this map.

This map displays nearby official conservation areas. Every local authority in England has at least one conservation area. Most are designated by the Council as the local planning authority, though Historic England and the Secretary of State also have the power to create them.

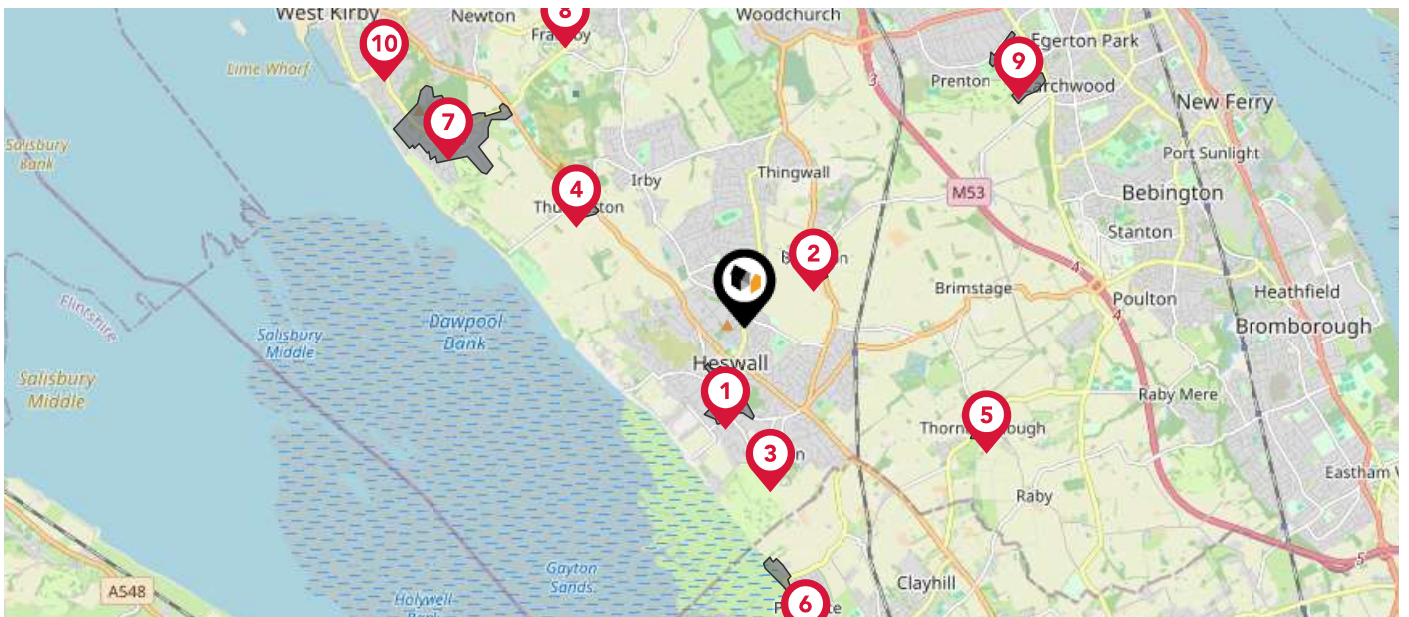

Nearby Conservation Areas

- 1 Heswall Lower Village
- 2 Barnston Village
- 3 Gayton
- 4 Thurstaston
- 5 Thornton Hough
- 6 Parkgate Conservation Area
- 7 Caldy
- 8 Frankby Village
- 9 Mountwood
- 10 West Kirby

Maps

Council Wards

The UK is divided into wards that are used for local elections to elect local government councillors. Sometimes these are known as 'electoral divisions'. Population counts can vary substantially between wards, but the national average is about 5,500

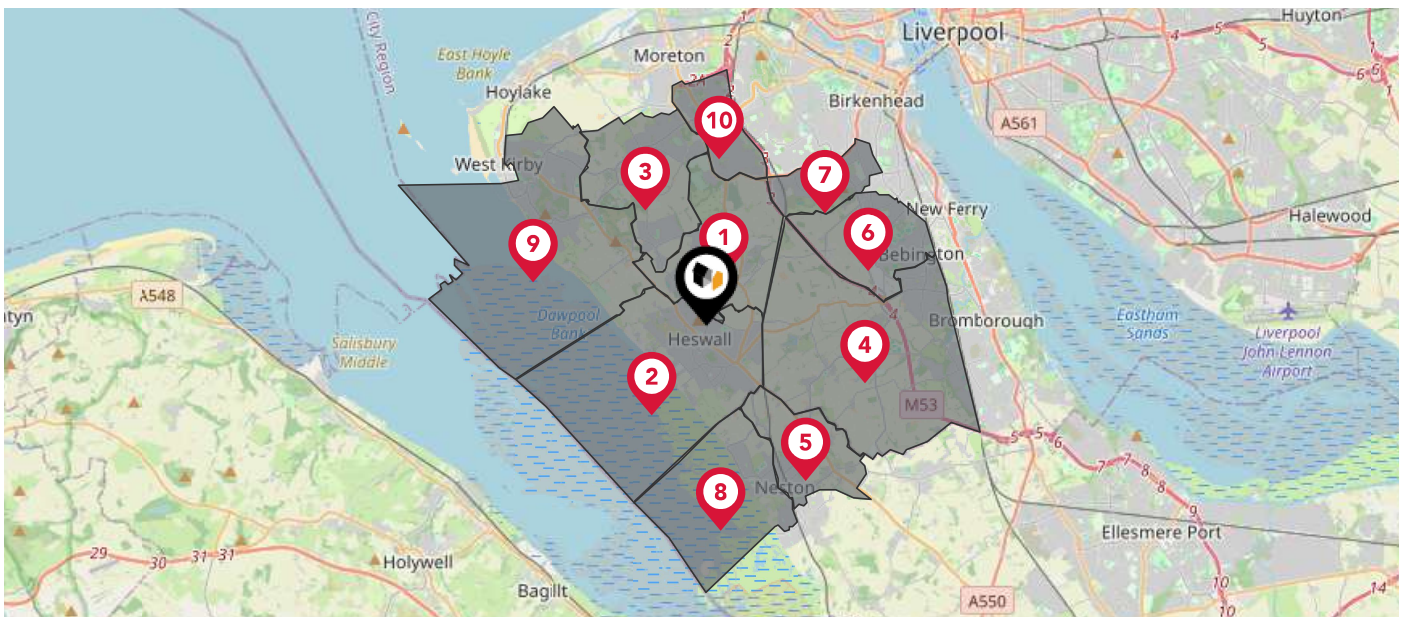

Nearby Council Wards

- 1 Pensby and Thingwall Ward
- 2 Heswall Ward
- 3 Greasby, Frankby and Irby Ward
- 4 Clatterbridge Ward
- 5 Neston Ward
- 6 Bebington Ward
- 7 Prenton Ward
- 8 Parkgate Ward
- 9 West Kirby and Thurstaston Ward
- 10 Upton Ward

This map displays the noise levels from nearby network rail and HS1 railway routes that affect this property...

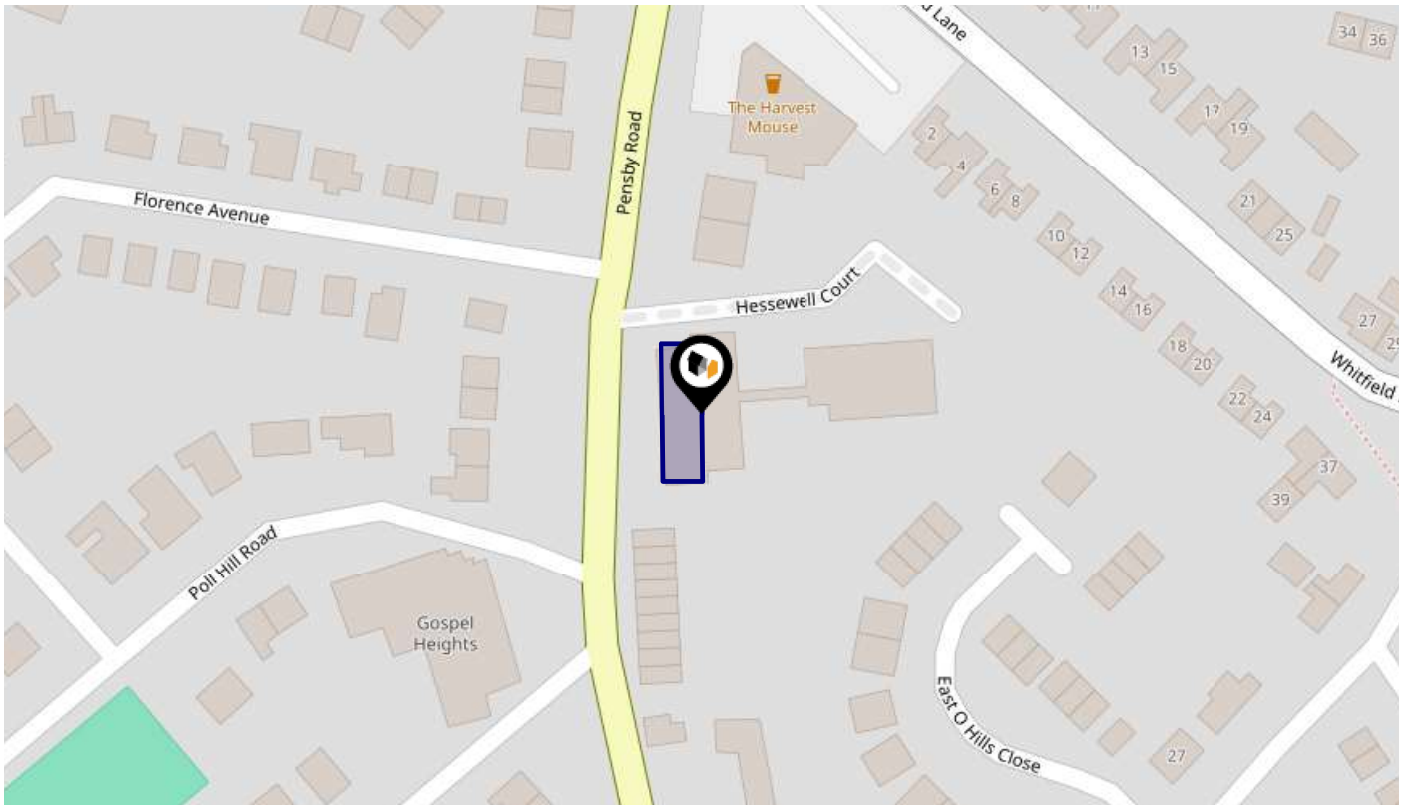

Rail Noise Data

This data indicates the level of noise according to the strategic noise mapping of rail sources within areas with a population of at least 100,000 people (agglomerations) and along Network Rail and HS1 traffic routes.

The data indicates the annual average noise levels for the 16-hour period between 0700 - 2300.

Noise levels are modelled on a 10m grid at a receptor height of 4m above ground, polygons are then produced by merging neighbouring cells within the following noise classes:

5		75.0+ dB	■
4		70.0-74.9 dB	■
3		65.0-69.9 dB	■
2		60.0-64.9 dB	■
1		55.0-59.9 dB	■

Flood Risk

Rivers & Seas - Flood Risk

This map shows the chance of flooding from rivers and / or the sea, taking into account flood defences and their condition.

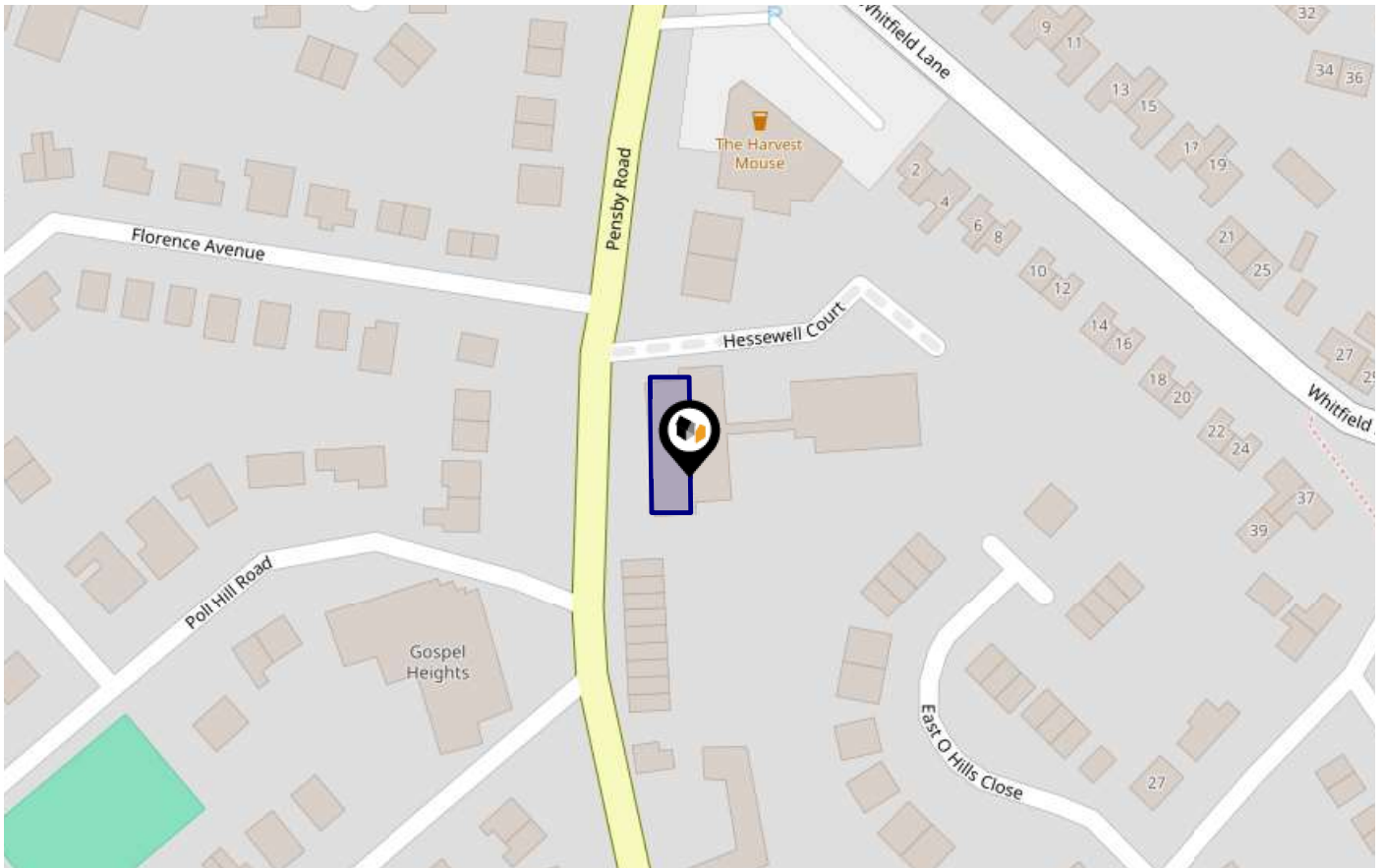

Risk Rating: Very low

The map does not contain sufficient information for it to be used to determine flood risk to individual properties, but it does give you an indication of whether your area may be affected by surface water flooding at this risk level.

- **High Risk** - an area which has a chance of flooding of greater than 1 in 30 (3.3%) in any one year.
- **Medium Risk** - an area which has a chance of flooding of greater than 1 in 100 (1.0%) in any one year.
- **Low Risk** - an area which has a chance of flooding of greater than 1 in 1000 (0.1%) in any one year.
- **Very Low Risk** - an area in which the risk is below 1 in 1000 (0.1%) in any one year.

Chance of flooding to the following depths at this property:



Flood Risk

Rivers & Seas - Climate Change

This map shows the future chance of flooding from rivers and / or the sea **between 2036 and 2069**, taking into account flood defences and their condition. The government climate change models cannot predict exactly when the chance of flooding will go up. It could happen at any time during the time period.

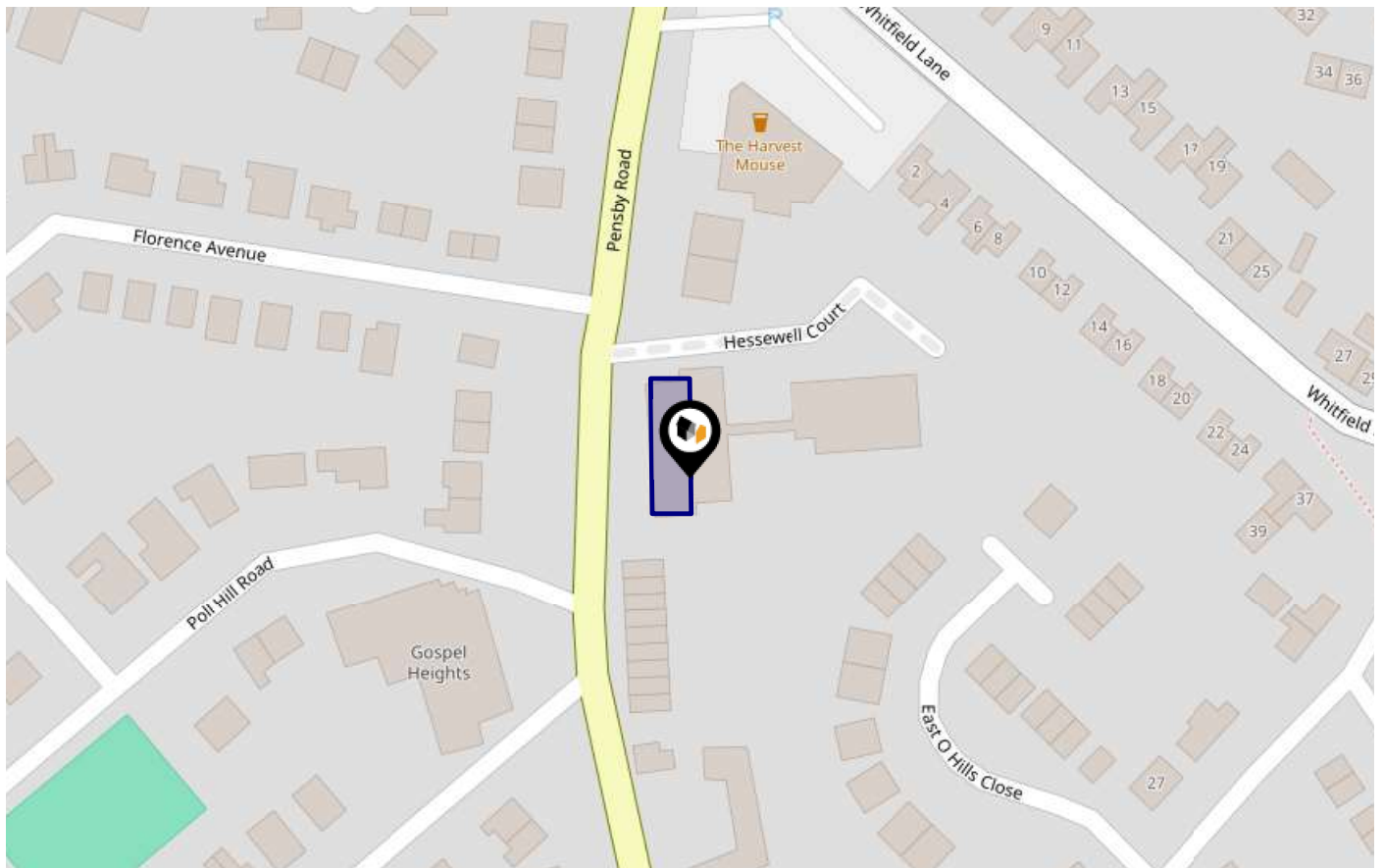

Risk Rating: **Very low**

The map does not contain sufficient information for it to be used to determine flood risk to individual properties, but it does give you an indication of whether your area may be affected by surface water flooding at this risk level.

- **High Risk** - an area which has a chance of flooding of greater than 1 in 30 (3.3%) in any one year.
- **Medium Risk** - an area which has a chance of flooding of greater than 1 in 100 (1.0%) in any one year.
- **Low Risk** - an area which has a chance of flooding of greater than 1 in 1000 (0.1%) in any one year.
- **Very Low Risk** - an area in which the risk is below 1 in 1000 (0.1%) in any one year.

Chance of flooding to the following depths at this property:



Flood Risk

Surface Water - Flood Risk

This map shows the chance of flooding where rainwater has nowhere to drain. This kind of flooding can occur far from rivers or seas.

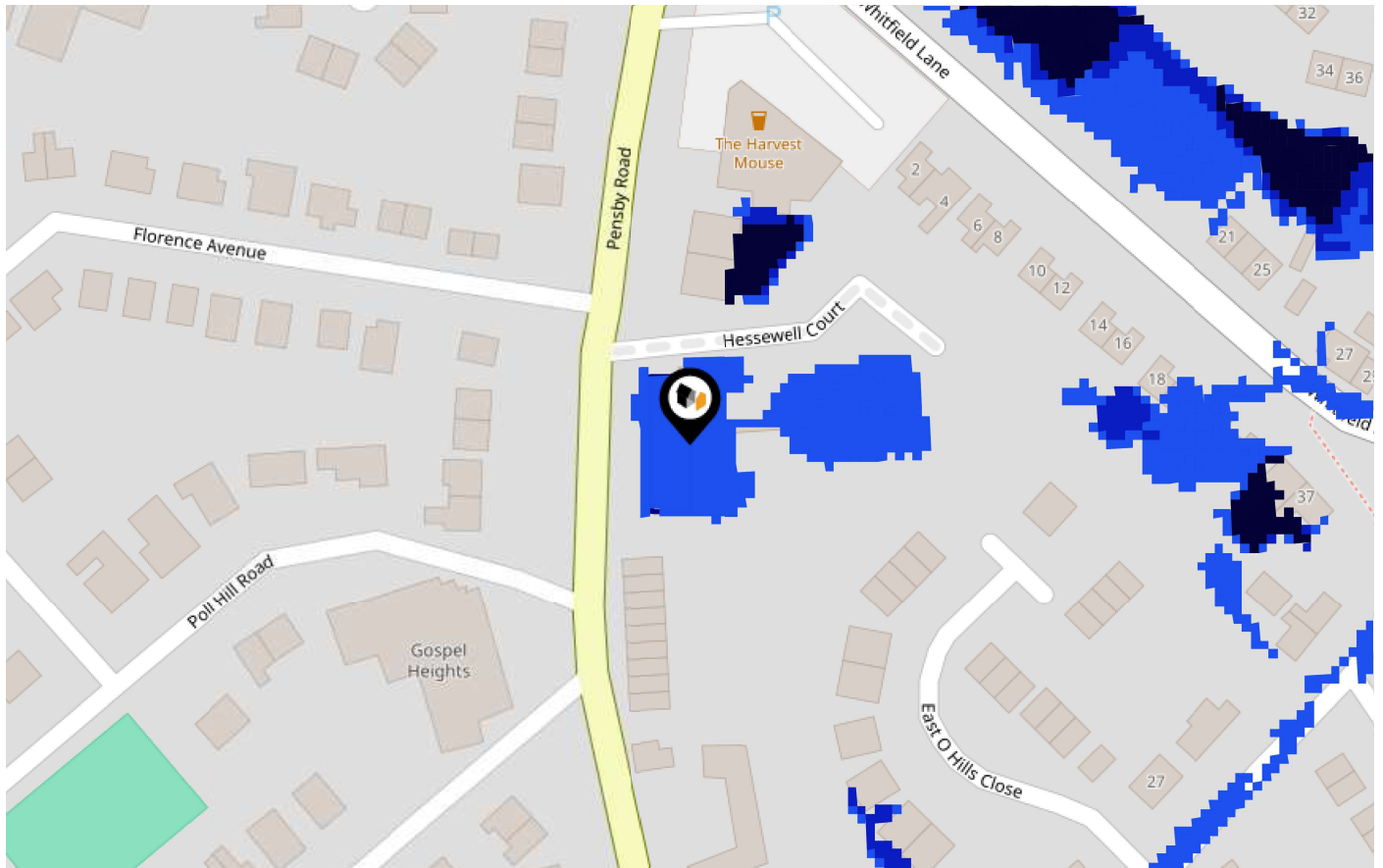

Risk Rating: Low

The map does not contain sufficient information for it to be used to determine flood risk to individual properties, but it does give you an indication of whether your area may be affected by surface water flooding at this risk level.

- **High Risk** - an area which has a chance of flooding of greater than 1 in 30 (3.3%) in any one year.
- **Medium Risk** - an area which has a chance of flooding of greater than 1 in 100 (1.0%) in any one year.
- **Low Risk** - an area which has a chance of flooding of greater than 1 in 1000 (0.1%) in any one year.
- **Very Low Risk** - an area in which the risk is below 1 in 1000 (0.1%) in any one year.

Chance of flooding to the following depths at this property:



Flood Risk

Surface Water - Climate Change

This map shows the future chance of flooding **between 2040 and 2060** where rainwater has nowhere to drain. This kind of flooding can occur far from rivers or seas. The government climate change models cannot predict exactly when the chance of flooding will go up. It could happen at any time during the time period.

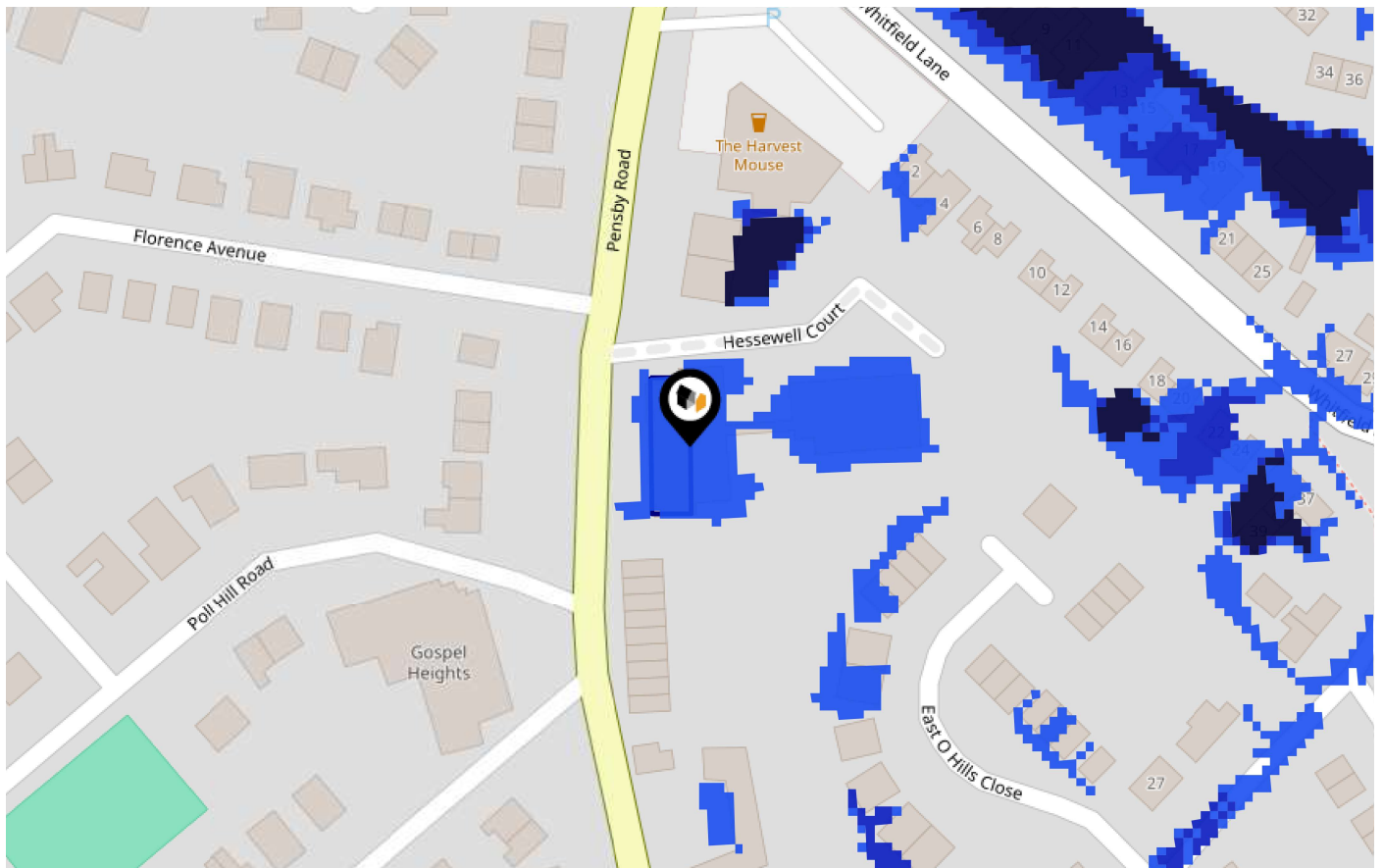

Risk Rating: **Low**

The map does not contain sufficient information for it to be used to determine flood risk to individual properties, but it does give you an indication of whether your area may be affected by surface water flooding at this risk level.

- **High Risk** - an area which has a chance of flooding of greater than 1 in 30 (3.3%) in any one year.
- **Medium Risk** - an area which has a chance of flooding of greater than 1 in 100 (1.0%) in any one year.
- **Low Risk** - an area which has a chance of flooding of greater than 1 in 1000 (0.1%) in any one year.
- **Very Low Risk** - an area in which the risk is below 1 in 1000 (0.1%) in any one year.

Chance of flooding to the following depths at this property:



Maps

Green Belt

This map displays nearby areas that have been designated as Green Belt...

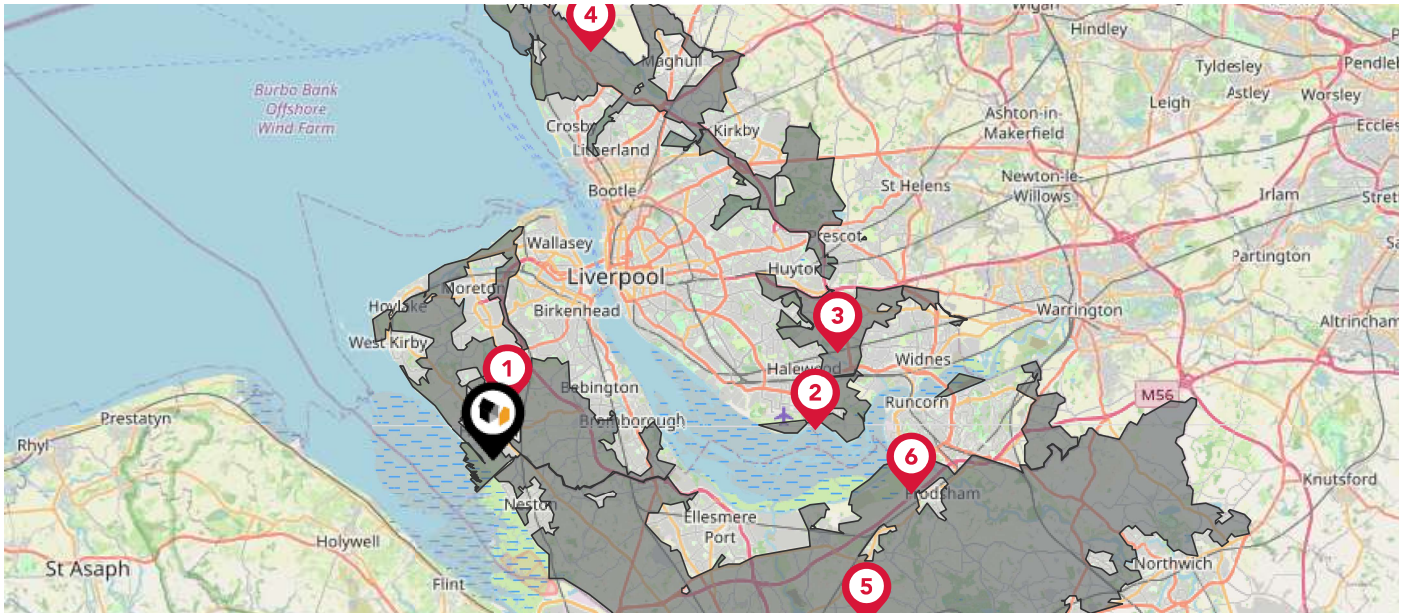

Nearby Green Belt Land

- 1 Merseyside and Greater Manchester Green Belt - Wirral
- 2 Merseyside and Greater Manchester Green Belt - Liverpool
- 3 Merseyside and Greater Manchester Green Belt - Knowsley
- 4 Merseyside and Greater Manchester Green Belt - Sefton
- 5 Merseyside and Greater Manchester Green Belt - Cheshire West and Chester
- 6 Merseyside and Greater Manchester Green Belt - Halton

Maps

Landfill Sites

This map displays the location of known landfill sites. Historic sites are where there is no environmental permit in force. Active sites are currently authorised by the Environment Agency under Environmental Permitting Regulations.

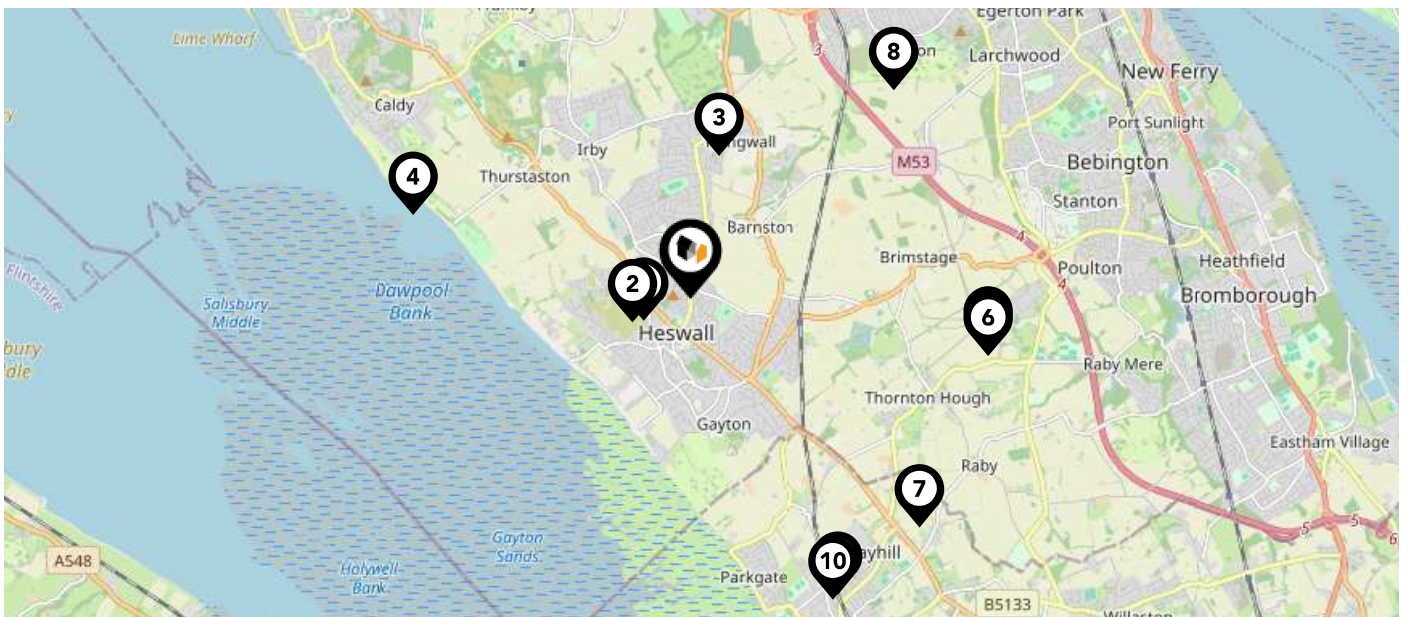

Nearby Landfill Sites

1	Heswall Quarry-Wirral, Merseyside	Historic Landfill
2	Quarry Road West - Cheshire Ferro Concrete-Quarry Road, Merseyside	Historic Landfill
3	Thingwall Quarry / Mill Road Quarry / Pensby Quarry-Quarry Lane, Thingwall, Wirral, Merseyside	Historic Landfill
4	Thurstaston / Station Road Tip-Thurstaston, Merseyside	Historic Landfill
5	Rocklands Clatter / Junction Grange Drive / Rocklands Lane Tip-Rocklands Lane, Bridge Near Thornton Hough, Wirral, Merseyside	Historic Landfill
6	Rocklands Clatter Bridge / Rocklands Lane Tip-Near Thornton Hough, Wirral, Merseyside	Historic Landfill
7	Five Ways Farm-Liverpool Road, Neston, Cheshire, Cheshire	Historic Landfill
8	14 Acres of Land at Lower Farm-Roman Road-Prenton Dell Road, Prenton, Merseyside	Historic Landfill
9	Leighton Road-Neston, Cheshire	Historic Landfill
10	Morgans Lagoon-Clayhill Industrial Estate, Cheshire	Historic Landfill

Maps

Listed Buildings

LANDWOOD
GROUP

This map displays nearby listed buildings and protected structures, as well as their listed tier and distance from the target property...

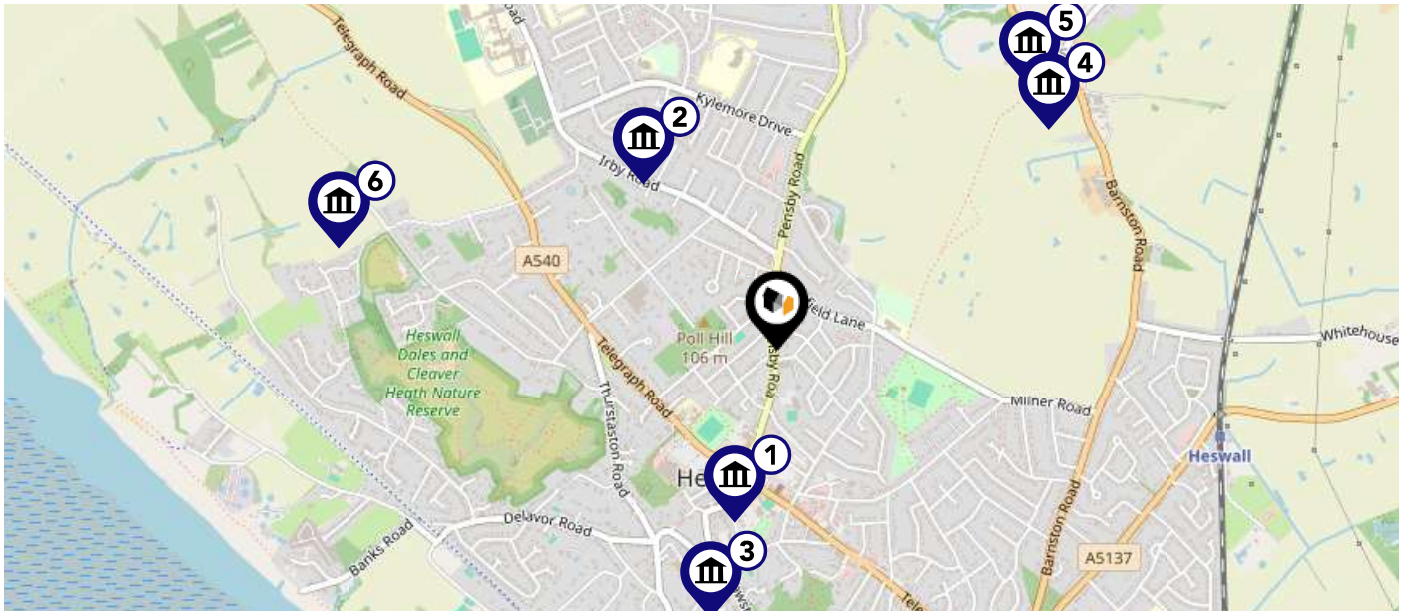

Listed Buildings in the local district

Grade

Distance



1075380 - Lloyds Bank

Grade II

0.4 miles



1343516 - Pensby Hall

Grade II

0.5 miles



1434790 - Heswall War Memorial

Grade II

0.6 miles



1343513 - Christ Church

Grade II

0.8 miles



1075376 - Beech Farmhouse

Grade II

0.8 miles



1075369 - Oldfield Farmhouse

Grade II

1.0 miles

Area Schools

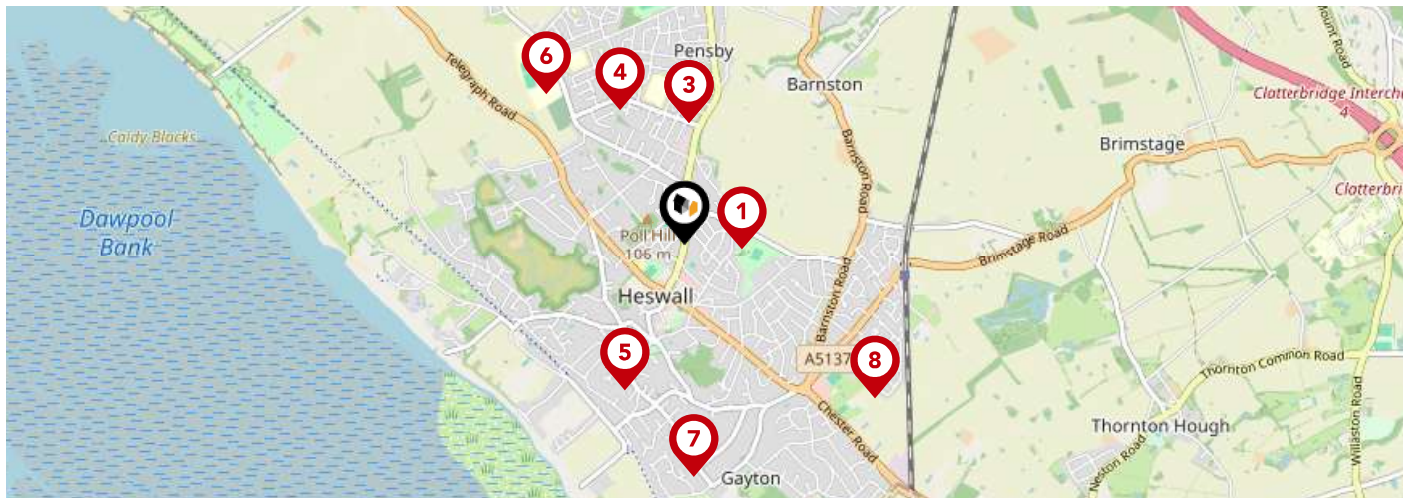

	Nursery	Primary	Secondary	College	Private
<p>1 Heswall Primary School Ofsted Rating: Good Pupils: 250 Distance:0.25</p>	<input type="checkbox"/>	<input checked="" type="checkbox"/>	<input type="checkbox"/>	<input type="checkbox"/>	<input type="checkbox"/>
<p>2 Stanley School Ofsted Rating: Good Pupils: 152 Distance:0.54</p>	<input type="checkbox"/>	<input checked="" type="checkbox"/>	<input type="checkbox"/>	<input type="checkbox"/>	<input type="checkbox"/>
<p>3 Pensby Primary School Ofsted Rating: Good Pupils: 241 Distance:0.54</p>	<input type="checkbox"/>	<input checked="" type="checkbox"/>	<input type="checkbox"/>	<input type="checkbox"/>	<input type="checkbox"/>
<p>4 Ladymount Catholic Primary School Ofsted Rating: Good Pupils: 219 Distance:0.66</p>	<input type="checkbox"/>	<input checked="" type="checkbox"/>	<input type="checkbox"/>	<input type="checkbox"/>	<input type="checkbox"/>
<p>5 Heswall St Peter's CofE Primary School Ofsted Rating: Good Pupils: 304 Distance:0.7</p>	<input type="checkbox"/>	<input checked="" type="checkbox"/>	<input type="checkbox"/>	<input type="checkbox"/>	<input type="checkbox"/>
<p>6 Pensby High School Ofsted Rating: Good Pupils: 902 Distance:0.9</p>	<input type="checkbox"/>	<input type="checkbox"/>	<input checked="" type="checkbox"/>	<input type="checkbox"/>	<input type="checkbox"/>
<p>7 Gayton Primary School Ofsted Rating: Good Pupils: 213 Distance:1.03</p>	<input type="checkbox"/>	<input checked="" type="checkbox"/>	<input type="checkbox"/>	<input type="checkbox"/>	<input type="checkbox"/>
<p>8 Barnston Primary School Ofsted Rating: Good Pupils: 309 Distance:1.09</p>	<input type="checkbox"/>	<input checked="" type="checkbox"/>	<input type="checkbox"/>	<input type="checkbox"/>	<input type="checkbox"/>

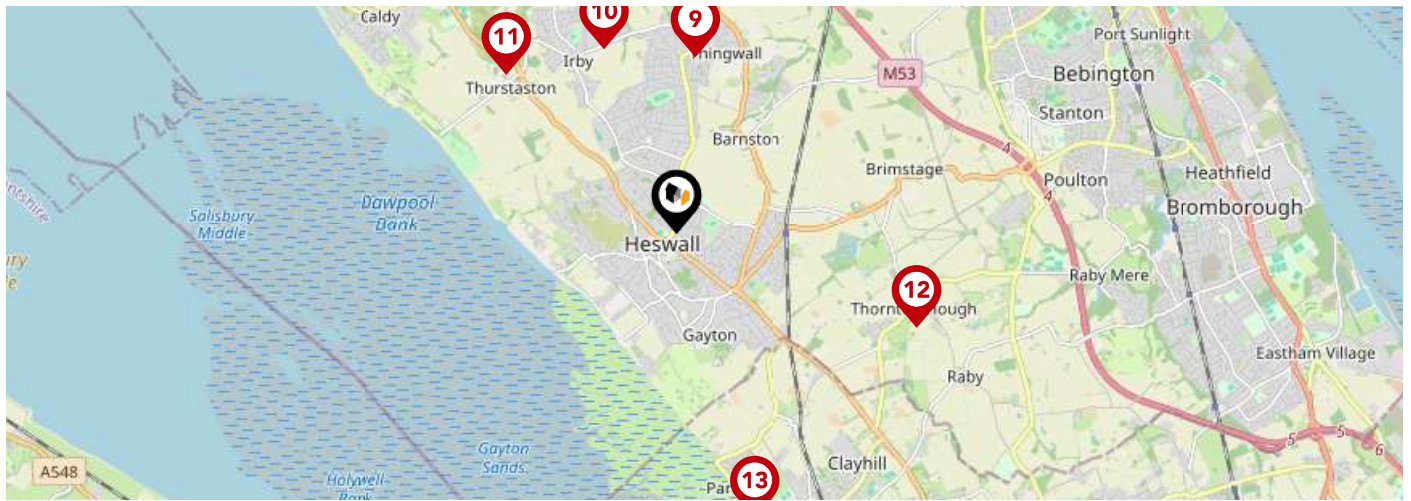



	Nursery	Primary	Secondary	College	Private
<p>9 Thingwall Primary School Ofsted Rating: Good Pupils: 206 Distance:1.58</p>	<input type="checkbox"/>	<input checked="" type="checkbox"/>	<input type="checkbox"/>	<input type="checkbox"/>	<input type="checkbox"/>
<p>10 Irby Primary School Ofsted Rating: Good Pupils:0 Distance:1.75</p>	<input type="checkbox"/>	<input checked="" type="checkbox"/>	<input type="checkbox"/>	<input type="checkbox"/>	<input type="checkbox"/>
<p>11 Thurstaston Dawpool CofE Primary School Ofsted Rating: Outstanding Pupils: 225 Distance:2.05</p>	<input type="checkbox"/>	<input checked="" type="checkbox"/>	<input type="checkbox"/>	<input type="checkbox"/>	<input type="checkbox"/>
<p>12 Thornton Hough Primary School Ofsted Rating: Outstanding Pupils: 180 Distance:2.29</p>	<input type="checkbox"/>	<input checked="" type="checkbox"/>	<input type="checkbox"/>	<input type="checkbox"/>	<input type="checkbox"/>
<p>13 Parkgate Primary School Ofsted Rating: Good Pupils: 172 Distance:2.61</p>	<input type="checkbox"/>	<input checked="" type="checkbox"/>	<input type="checkbox"/>	<input type="checkbox"/>	<input type="checkbox"/>
<p>14 Greasby Junior School Ofsted Rating: Good Pupils: 245 Distance:2.71</p>	<input type="checkbox"/>	<input checked="" type="checkbox"/>	<input type="checkbox"/>	<input type="checkbox"/>	<input type="checkbox"/>
<p>15 St Michael and All Angels Catholic Primary School Ofsted Rating: Good Pupils: 240 Distance:2.78</p>	<input type="checkbox"/>	<input checked="" type="checkbox"/>	<input type="checkbox"/>	<input type="checkbox"/>	<input type="checkbox"/>
<p>16 Foxfield School Ofsted Rating: Good Pupils: 195 Distance:2.82</p>	<input type="checkbox"/>	<input type="checkbox"/>	<input checked="" type="checkbox"/>	<input type="checkbox"/>	<input type="checkbox"/>

Local Area Masts & Pylons

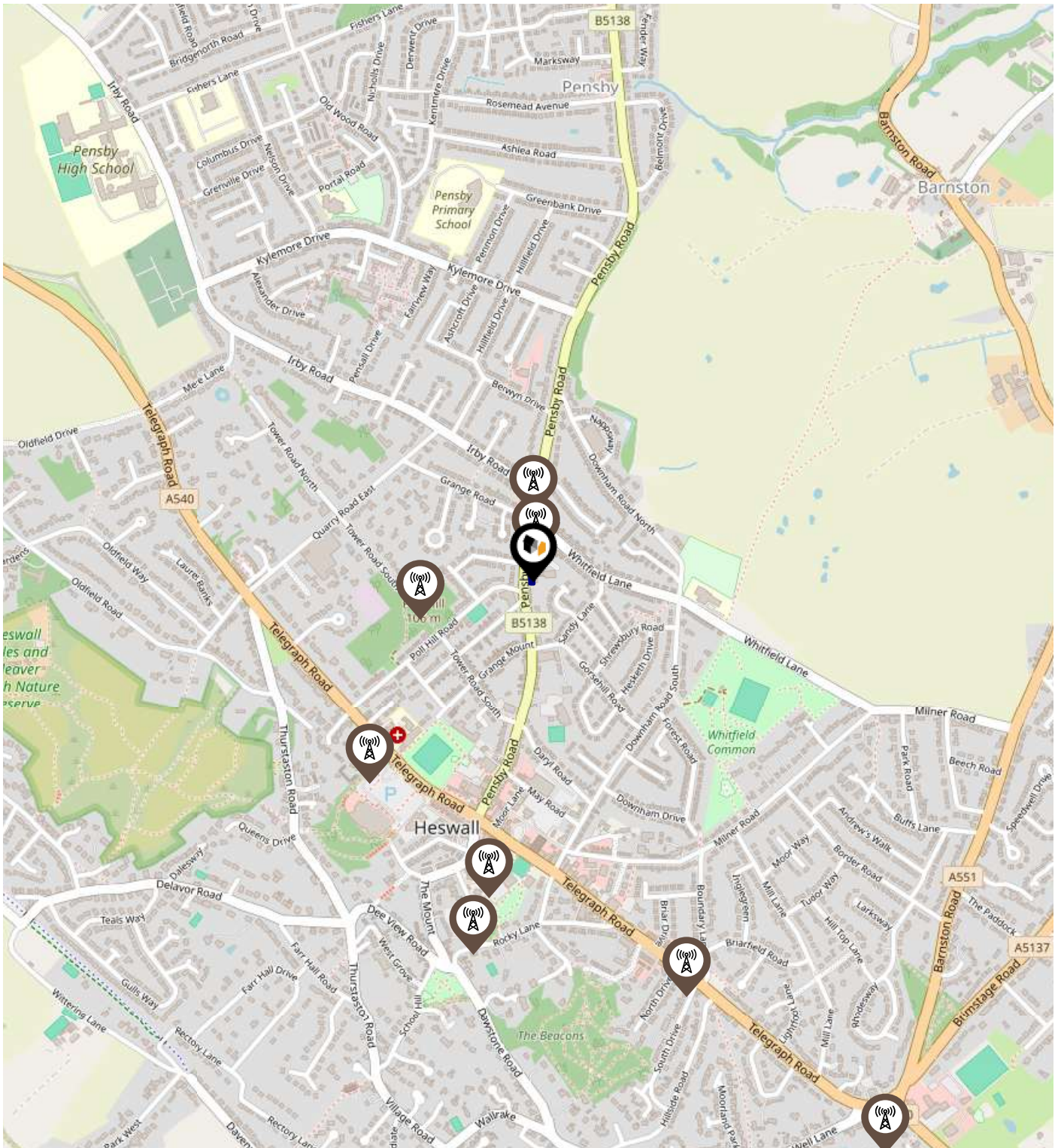
LANDWOOD
GROUP



Key:

-  Power Pylons
-  Communication Masts

Environment

Radon Gas

What is Radon?

Radon is a natural radioactive gas, which enters buildings from the ground. Exposure to high concentrations increases the risk of lung cancer. The UK Health Security Agency (UKHSA) recommends that radon levels should be reduced in homes where the annual average is at or above 200 becquerels per cubic metre (200 Bq/m³).

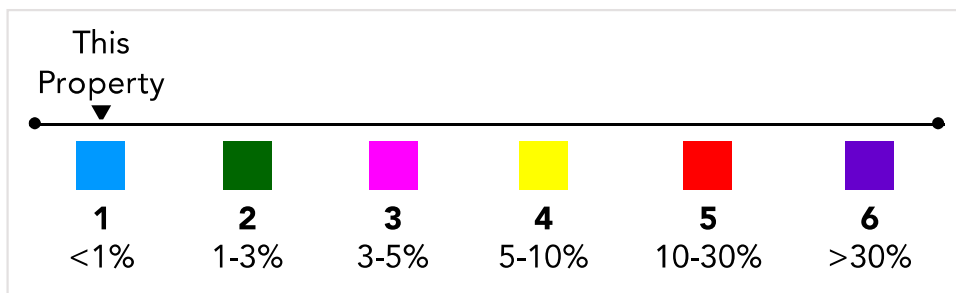
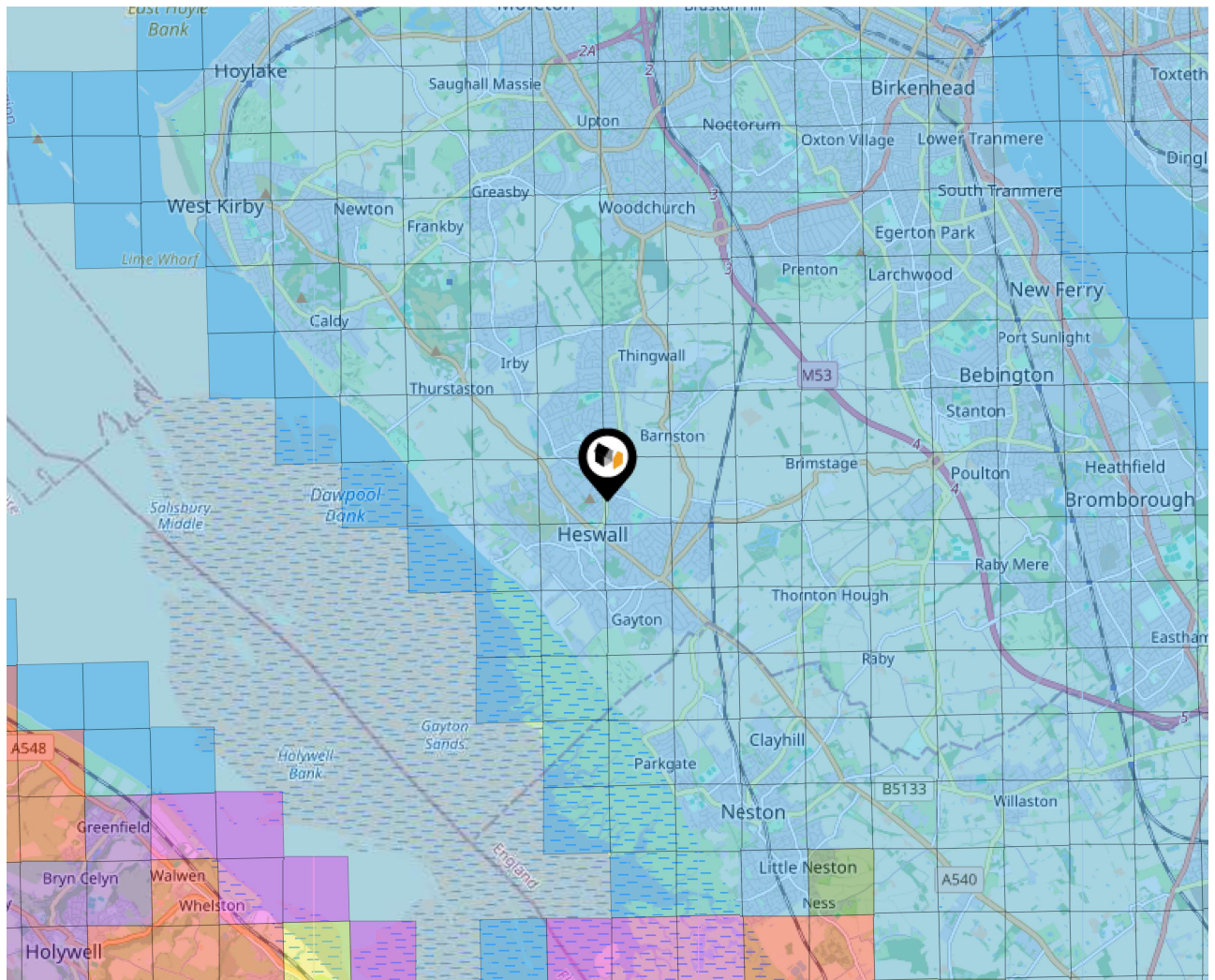

Local Area Road Noise

LANDWOOD
GROUP

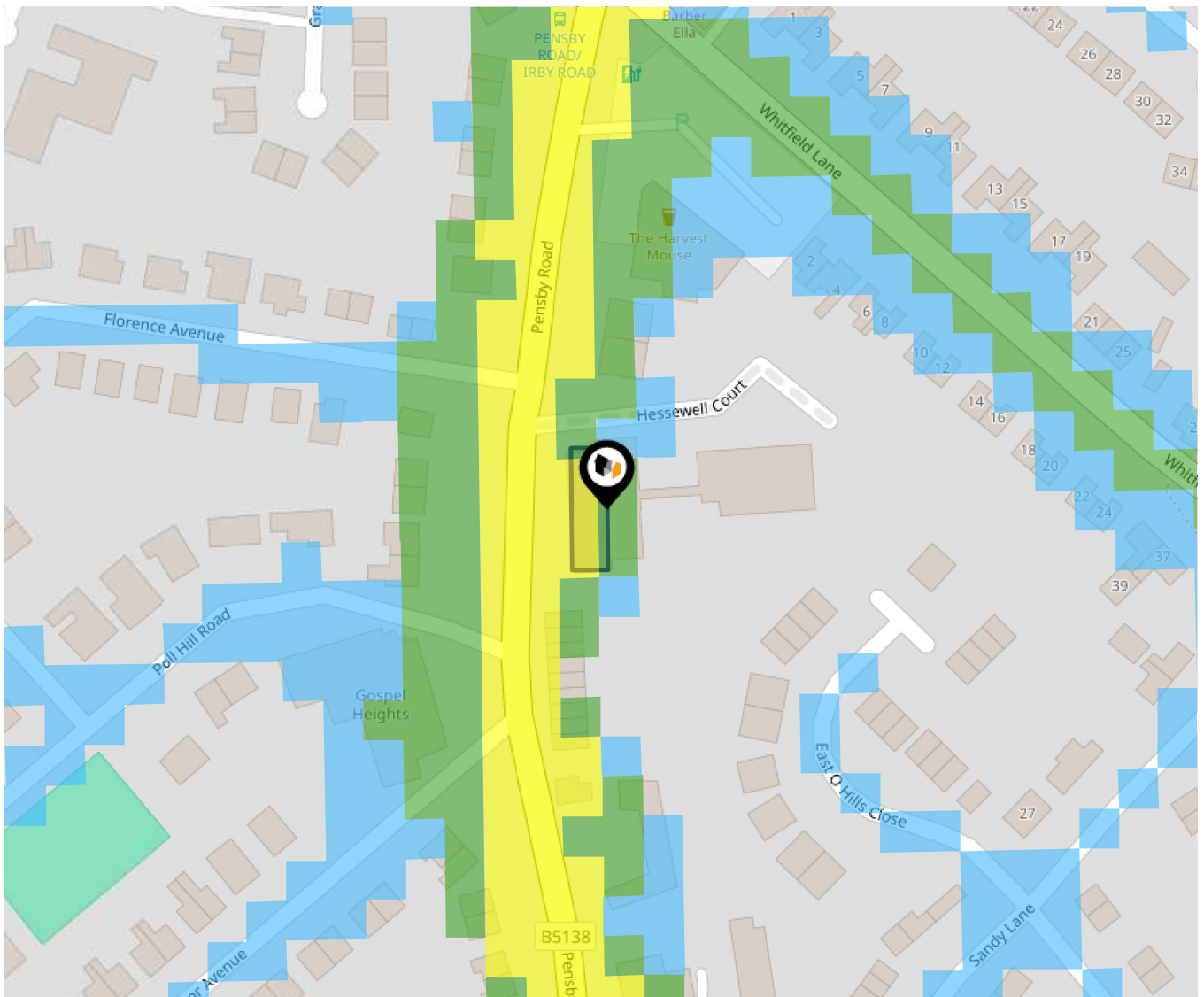

The data indicates the level of noise according to strategic noise sources across all traffic routes. This indicates a 25 house annual average noise level with separate weightings for the evening and the night periods.

- 75.0+ dB
- 70.0-74.9 dB
- 65.0-69.9 dB
- 60.0-64.9 dB
- 55.0-59.9 dB

Ground Composition for this Address (Surrounding square kilometer zone around property)

Carbon Content:	VARIABLE(LOW)	Soil Texture:	LOAM TO CLAYEY LOAM
Parent Material Grain:	MIXED (ARGILLIC- RUDACEOUS)	Soil Depth:	DEEP
Soil Group:	MEDIUM TO LIGHT(SILTY) TO HEAVY		

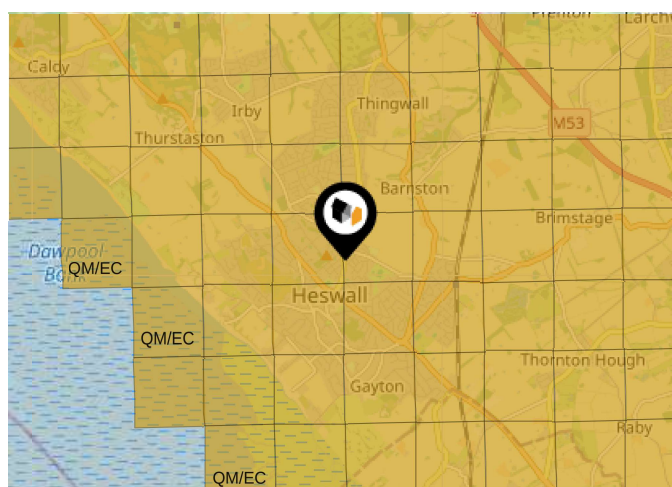

Primary Classifications (Most Common Clay Types)

C/M	Claystone / Mudstone
FPC,S	Floodplain Clay, Sand / Gravel
FC,S	Fluvial Clays & Silts
FC,S,G	Fluvial Clays, Silts, Sands & Gravel
PM/EC	Prequaternary Marine / Estuarine Clay / Silt
QM/EC	Quaternary Marine / Estuarine Clay / Silt
RC	Residual Clay
RC/LL	Residual Clay & Loamy Loess
RC,S	River Clay & Silt
RC,FS	Riverine Clay & Floodplain Sands and Gravel
RC,FL	Riverine Clay & Fluvial Sands and Gravel
TC	Terrace Clay
TC/LL	Terrace Clay & Loamy Loess

Area

Transport (National)

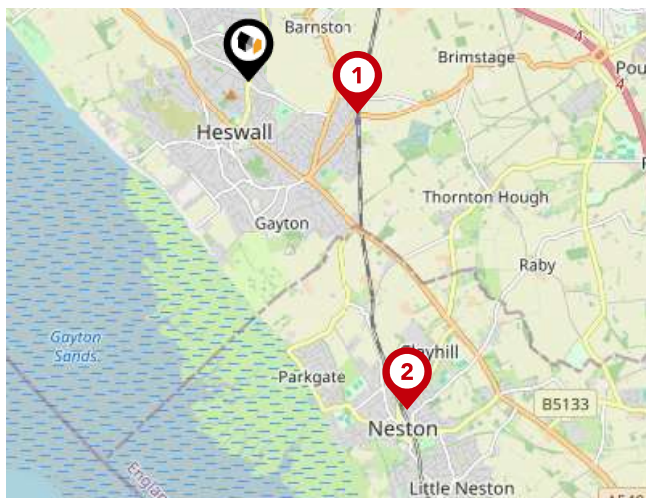

National Rail Stations

Pin	Name	Distance
1	Heswall Rail Station	1.01 miles
2	Neston Rail Station	3.22 miles
3	Upton Rail Station	3.69 miles

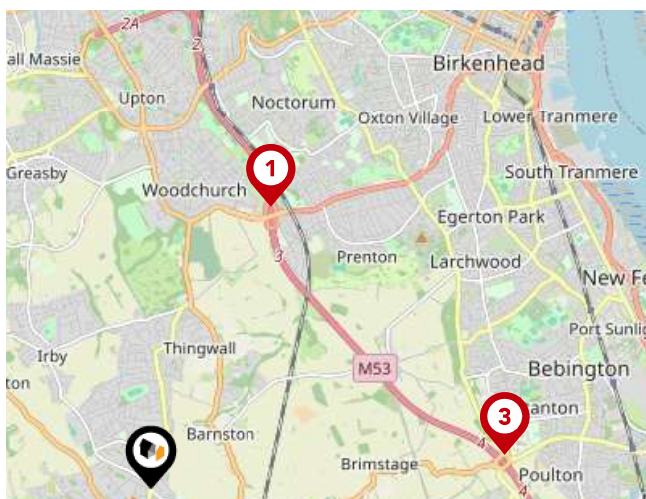

Trunk Roads/Motorways

Pin	Name	Distance
1	M53 J3	2.72 miles
2	M53 J2	4.26 miles
3	M53 J4	3.14 miles
4	M53 J1	5.62 miles
5	M53 J5	5.93 miles



Airports/HELIPADS

Pin	Name	Distance
1	Speke	10 miles
2	Highfield	30.82 miles
3	Manchester Airport	33.84 miles
4	Penrhyn	59.65 miles

Area

Transport (Local)

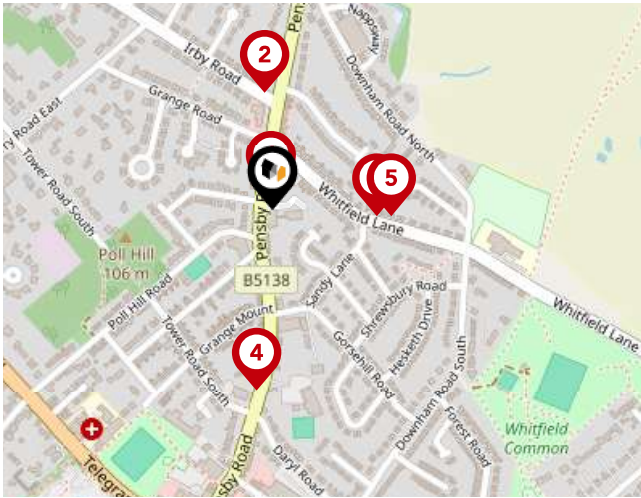

Bus Stops/Stations

Pin	Name	Distance
1	Hesslewell Court	0.02 miles
2	Pensby Road	0.13 miles
3	Whitfield Lane	0.12 miles
4	Tower Road South	0.2 miles
5	Whitfield Lane	0.13 miles

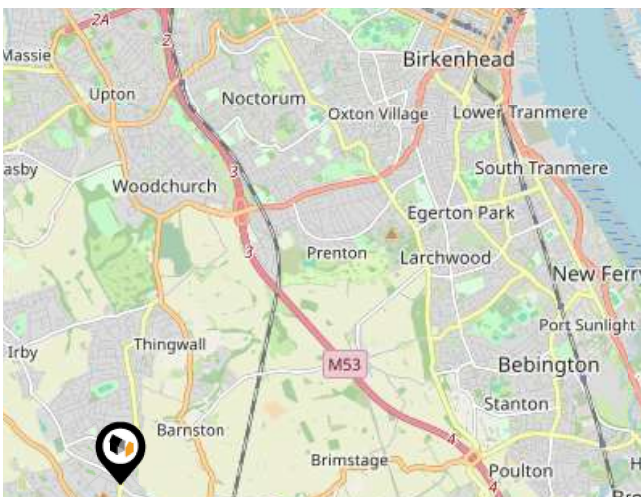

Ferry Terminals

Pin	Name	Distance
1	Woodside Birkenhead Ferry Terminal	5.56 miles

Landwood Group

Data Quality

We are committed to comprehensive property data being made available upfront to make the home buying and selling process quicker, easier and cheaper. This is why we have partnered with Sprift, the UK's leading supplier of property-specific data.



Contains public sector information licensed under the Open Government License v3.0

The information contained within this report is for general information purposes only.

Sprift Technologies Ltd aggregate this data from a wide variety of sources and while we endeavour to keep the information up to date and correct, we make no representations or warranties of any kind, express or implied, about the completeness, accuracy, reliability, of the information or related graphics contained within this report for any purpose.

Any reliance you place on such information is therefore strictly at your own risk. In no event will we be liable for any loss or damage including without limitation, indirect or consequential loss or damage, or any loss or damage whatsoever arising from loss of data or profits arising out of, or in connection with, the use of this report.



Landwood Group

77 Deansgate Manchester M3 2BW

0161 710 2010

Emma.judge@landwoodgroup.com

<https://landwoodgroup.com/>

