



Little Queens Road, TW11

£309,950

A one bedroom ground floor apartment situated in a central Teddington location. The apartment offers a well presented living space and has the advantage of well kept, communal gardens as well as residents parking. This property is being sold with no onward chain.

Francis Court is located off Little Queens Road, which is off Queens Road, 0.2 miles from Teddington mainline station and the High Street with its local bars, shops and restaurants.

Features

- No Onward Chain
- Purpose Built
- Double Bedroom
- Central Location
- Ground Floor
- Residents Parking

Little Queens Road, Teddington, TW11

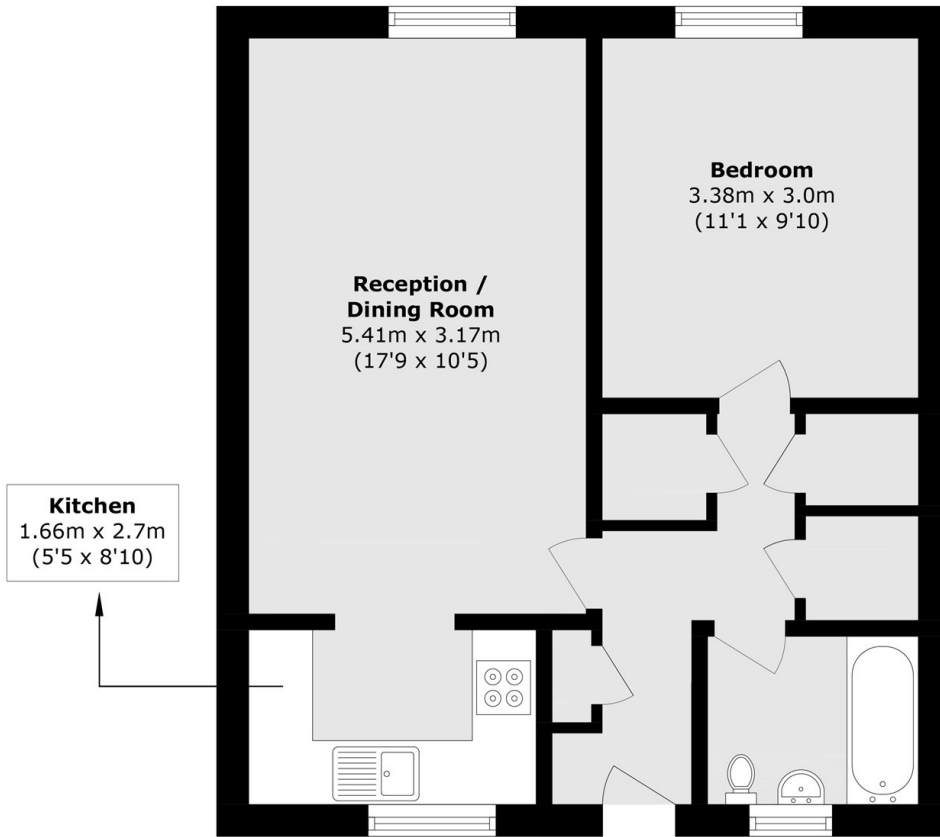

Total area (approx.): 45.2 sq. m (486.5 sq. ft)