

Earls Court Gardens, SW5

£350 Per week

A neutrally decorated self contained studio flat situated on the second floor of a period conversion with wood flooring throughout and an open plan kitchen.

A residential road in what could only be described as the ideal location. The buzz of the High Street as well as the tube station are on your doorstep.

Features

- Open Plan Kitchen
- Furnished
- Wood Floors Throughout
- Top Floor
- Self Contained
- Centrally Located

Earls Court Gardens, London, SW5

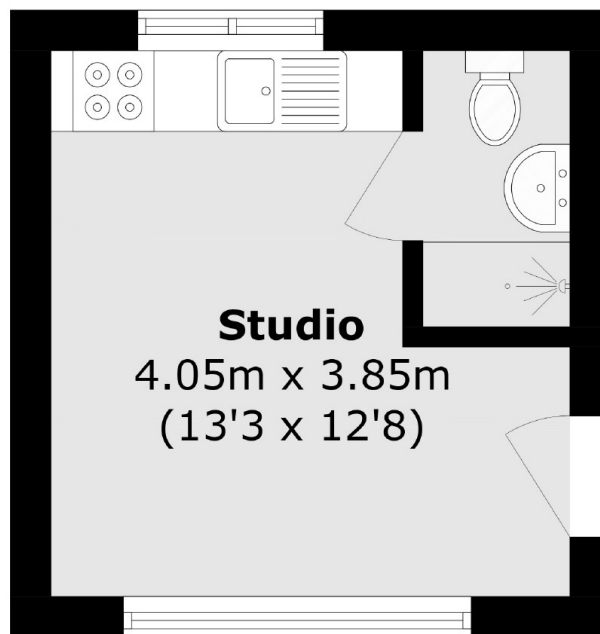

Total area (approx.): 15.5 sq. m (166.8 sq. ft)