

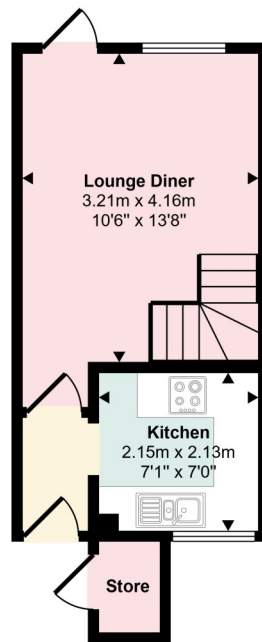

15 Hawthorn Way, Dumbarton, G82 5EB

The agents are delighted to present this well-presented one-bedroom end-terrace villa, located in a peaceful position within the popular Hawthornhill Estate to the east of Dumbarton.

Approx Gross Internal Area
43 sq m / 461 sq ft



Ground Floor
Approx 22 sq m / 233 sq ft

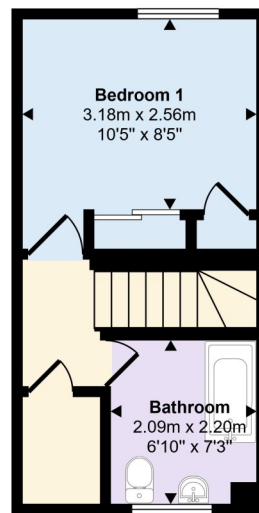

First Floor
Approx 21 sq m / 227 sq ft

This floorplan is only for illustrative purposes and is not to scale. Measurements of rooms, doors, windows, and any items are approximate and no responsibility is taken for any error, omission or mis-statement. Icons of items such as bathroom suites are representations only and may not look like the real items. Made with Made Snappy 360.



David Muir Estate Agents
2 Church Street, Dumbarton,
G82 1QL

Tel 01389 734366
Fax 01389 742476

tracy@davidmuirestates.co.uk



davidmuirestates.com



davidmuirestates

Travel Directions

From the agent's office in Church Street, proceed to roundabout and take first exit along dual carriageway heading west. Cross over Artizan Bridge. Continue on Cardross Road passing St Michael's Primary School on your right hand side. Continue along Cardross Road passing Joint Hospital on your right taking the right turn into Hawthorn Avenue. Turn left into Rowan Drive and then left into Hawthorn Way. Park in the car park and follow the footpath,

Additional Information

Home Report Valuation: £90,000
Asking Price: Offers Over £87,000
Council Tax Band: B
Energy Efficiency Rating: C
Gas Central Heating
Double Glazing

Home Report

This property benefits from a Home Report which can be obtained from davidmuirestates.com or onesurvey.org

Disclaimer

These property details are set out as a general outline only and do not constitute any part of an Offer or Contract. All fixtures and fittings mentioned in these particulars are included in the sale. All others in the property are specifically excluded. Photographs are reproduced for general information and it must not be inferred that any item is included for sale with the property. All measurements, distances and areas are approximate and for guidance only.