

# Parkheath

*Sold on Service*

**Belsize Grove NW3**  
**£2,300 PCM (£531 per week) - Camden Band D**



Smart and contemporary one bedroom apartment  
Porter and communal garden  
Bright reception  
Double bedroom with wardrobes  
Moments to Belsize Park underground

Ground floor of purpose built block  
Wood floors and neutral decor  
Separate kitchen with all appliances  
Luxurious shower room  
EPC: Rating D, Council Tax: Camden band D

Belsize Park Office 020 7431 3104

# Gilling Court, Belsize Grove, London, NW3

Approximate Gross Internal Floor Area = 40.1 sq m / 433 sq ft

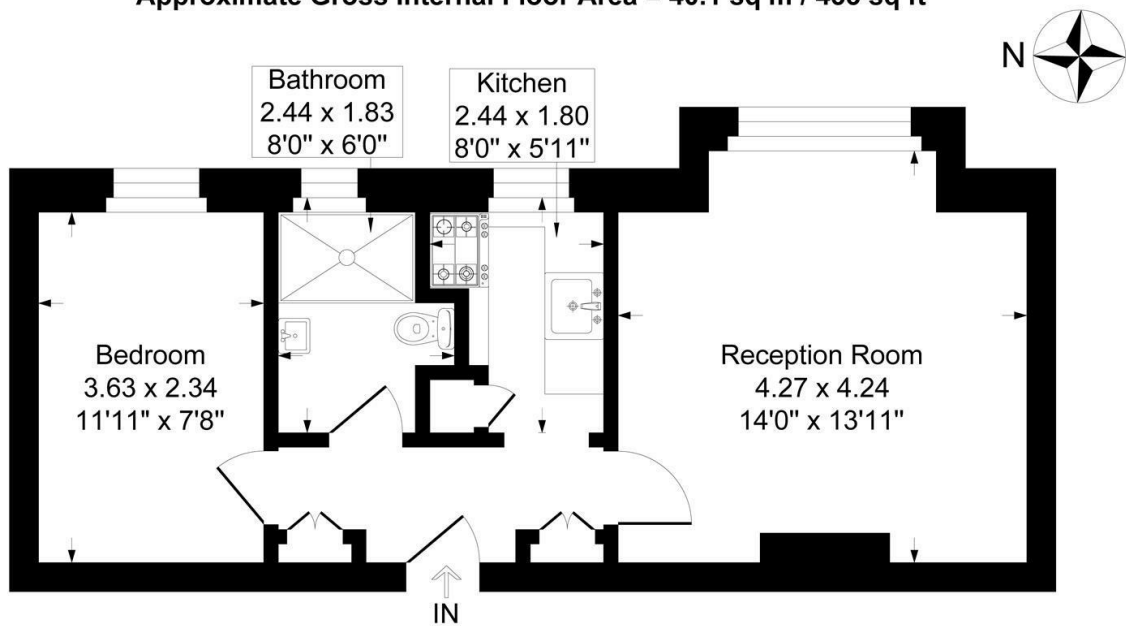

## Ground Floor

Illustration for identification purposes only, measurements are approximate, not to scale.

The particulars do not constitute part of an offer or contract. The particulars, including text, photographs and plans, are for the guidance only of prospective purchasers/tenants and must not be relied upon as statements of fact. The descriptions provided therein represent the opinion of the author and whilst given in good faith should not be construed as statements of fact. Nothing in these particulars shall be deemed a statement that the property is in good condition or otherwise or that any services or facilities are in good working order. All measurements are approximate